

PART NAME

NEMA HEAVY DUTY PLASTIC BOX

PART No.

HD-7601

REVISION DATE

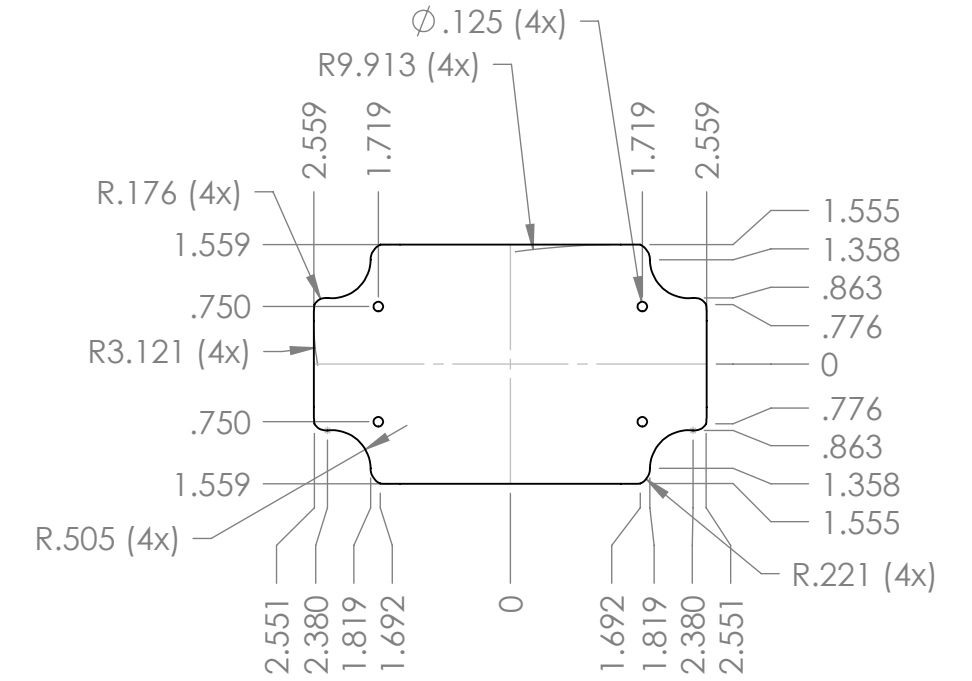
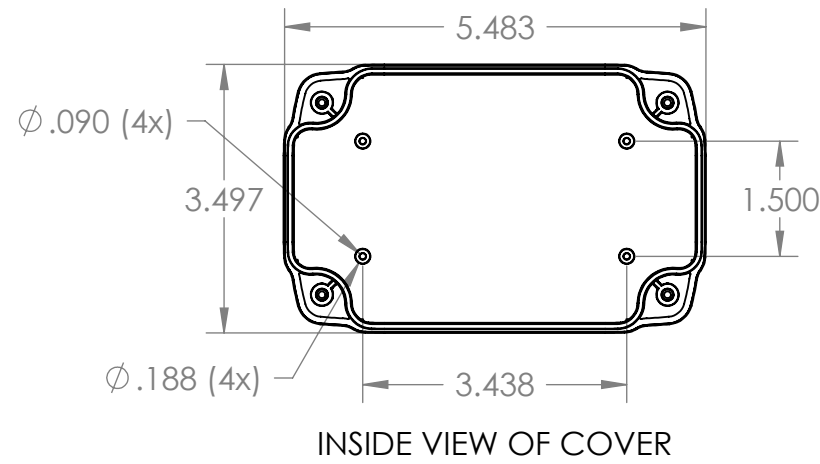
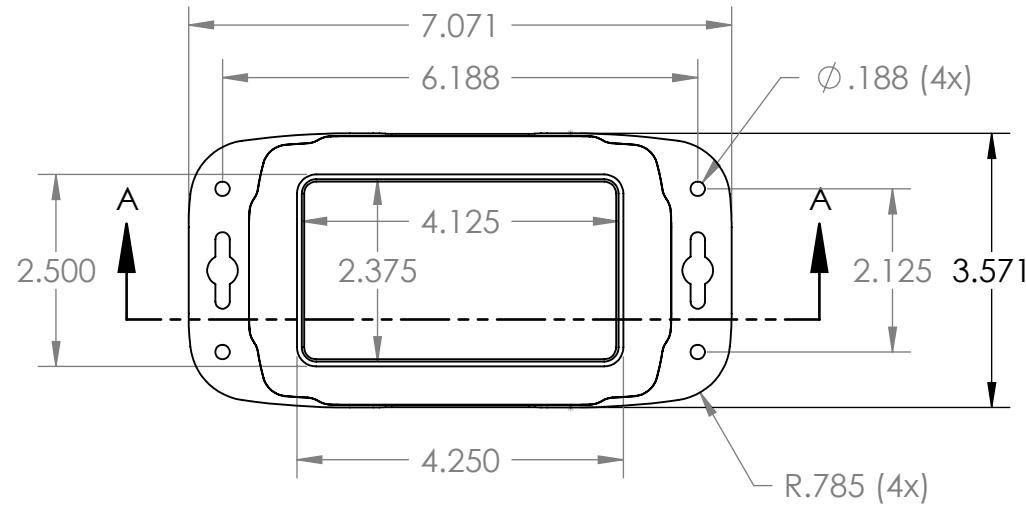

REFERENCE MAXIMUM P.C.B. SIZE.
SIZES INCLUDE .03 CLEARANCE FROM INNER WALLS
AND SCREW TOWERS WHEN UTILIZING THE MOUNTING
BOSSES IN THE COVER. (CUSTOMER TO PROVIDE)

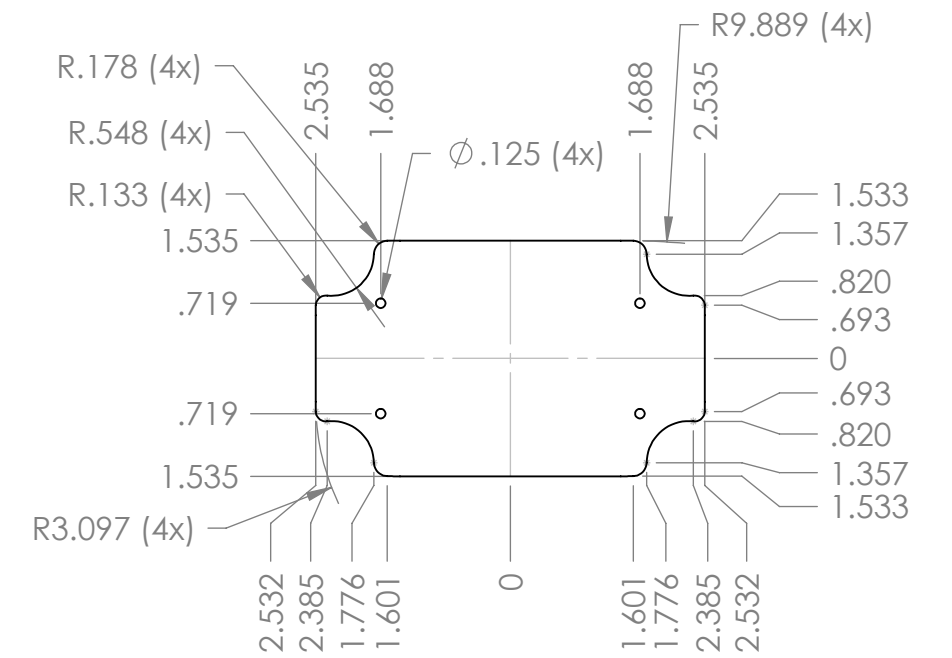
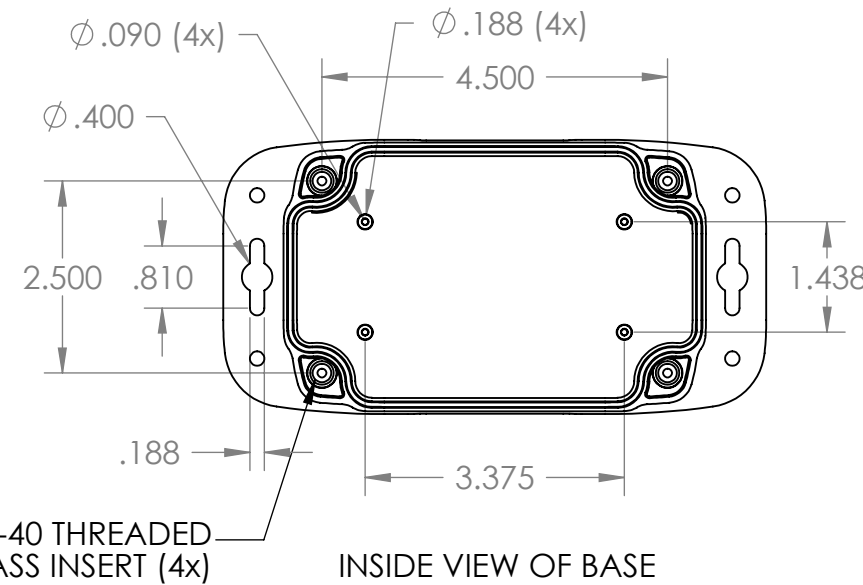
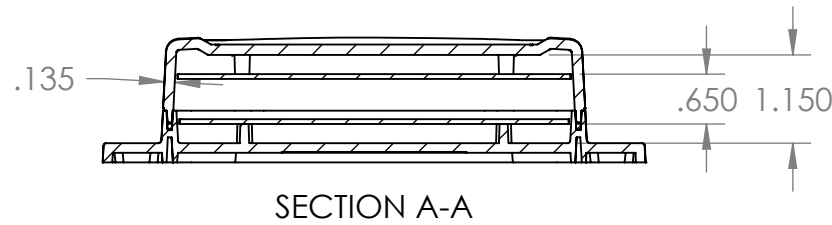

REFERENCE MAXIMUM P.C.B. SIZE.
SIZES INCLUDE .03 CLEARANCE FROM INNER WALLS
AND SCREW TOWERS WHEN UTILIZING THE MOUNTING
BOSSES IN THE BASE. (CUSTOMER TO PROVIDE)

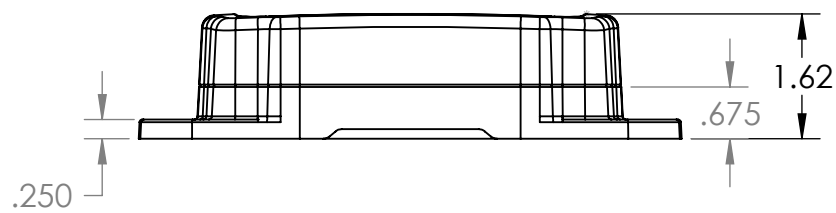

ALL DIMENSIONS HAVE $\pm .015$ TOLERANCE

MATERIAL: BASE & COVER - POLYCARBONATE
UL94-V0 AND UV STABILIZED
FINISH: TEXTURED BLACK
GASKET SILICONE RUBBER

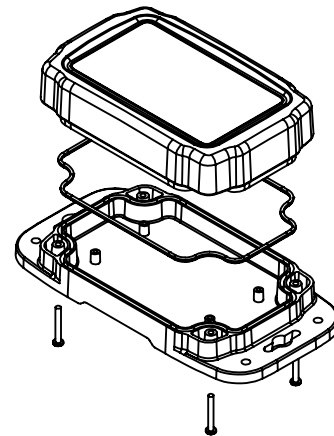
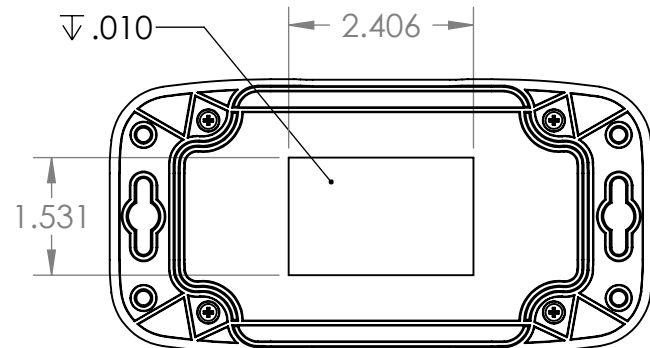

ENCLOSURE DESIGNED TO IP 66 OF IEC 529
AND NEMA 4, 4X, 12, 13
FOUR (4) #4-40 x 7/8 LG. PAN HEAD STAINLESS
STEEL SCREWS SUPPLIED FOR ASSEMBLY OF COVER
RECOMMENDED TORQUE SETTING FOR ASSEMBLY
SCREWS : 6.25 IN-LBS.
PCB BOSSES WILL ACCEPT A #4 x 1/4 LG. THREAD
FORMING SCREW (NOT SUPPLIED)