

7000 series

Rocker and paddle switches

Overview

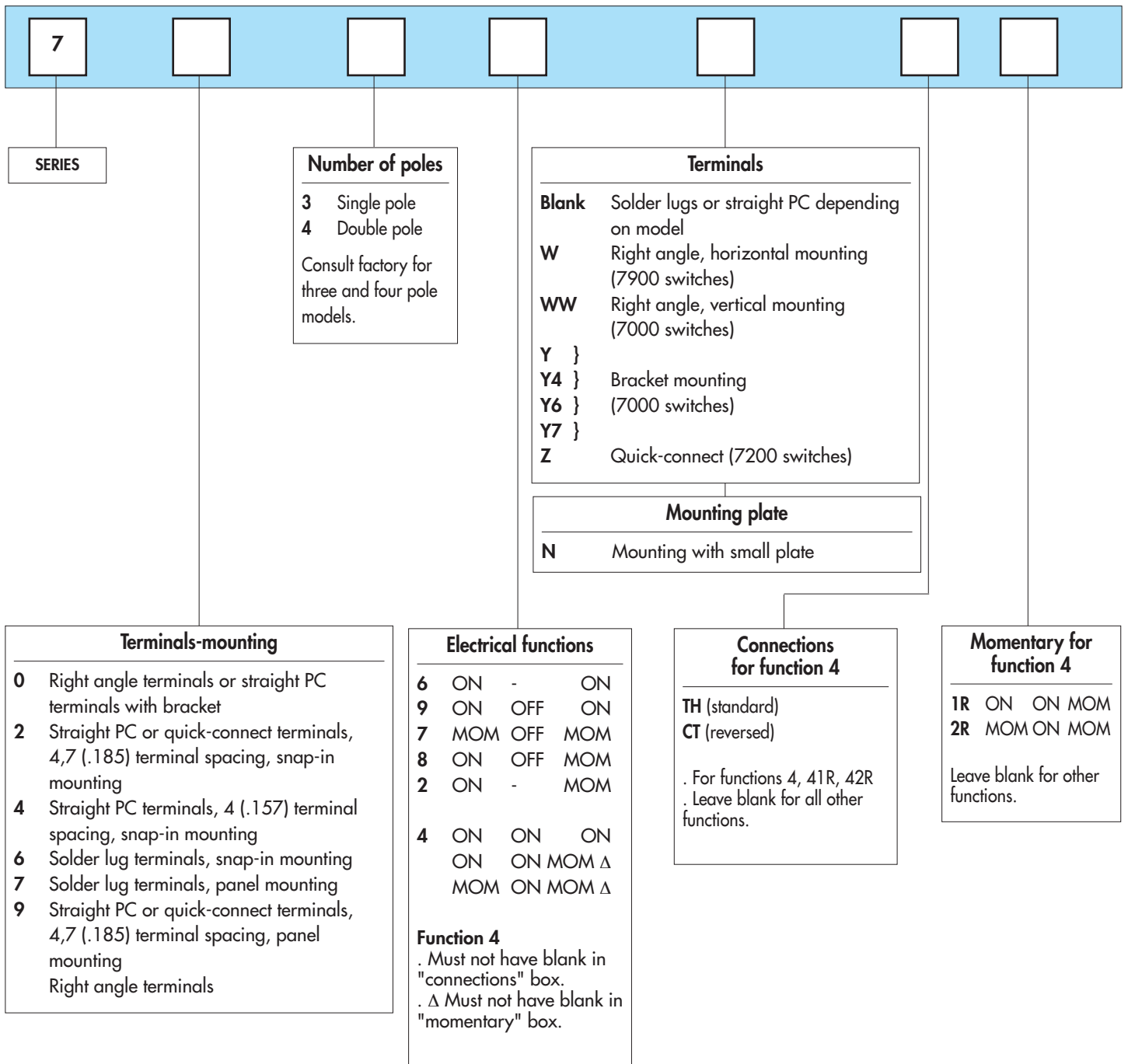

ABOUT THIS SERIES

On the following pages, you will find successively :

- model structure of switches
- options in the same order as in above chart

Dimensions : first dimensions are in mm while inches are shown as bracketed numbers.



NOTICE : please note that not all combinations of above numbers are available. Refer to the following pages for further information.



7000 series

Rocker and paddle switches

Overview

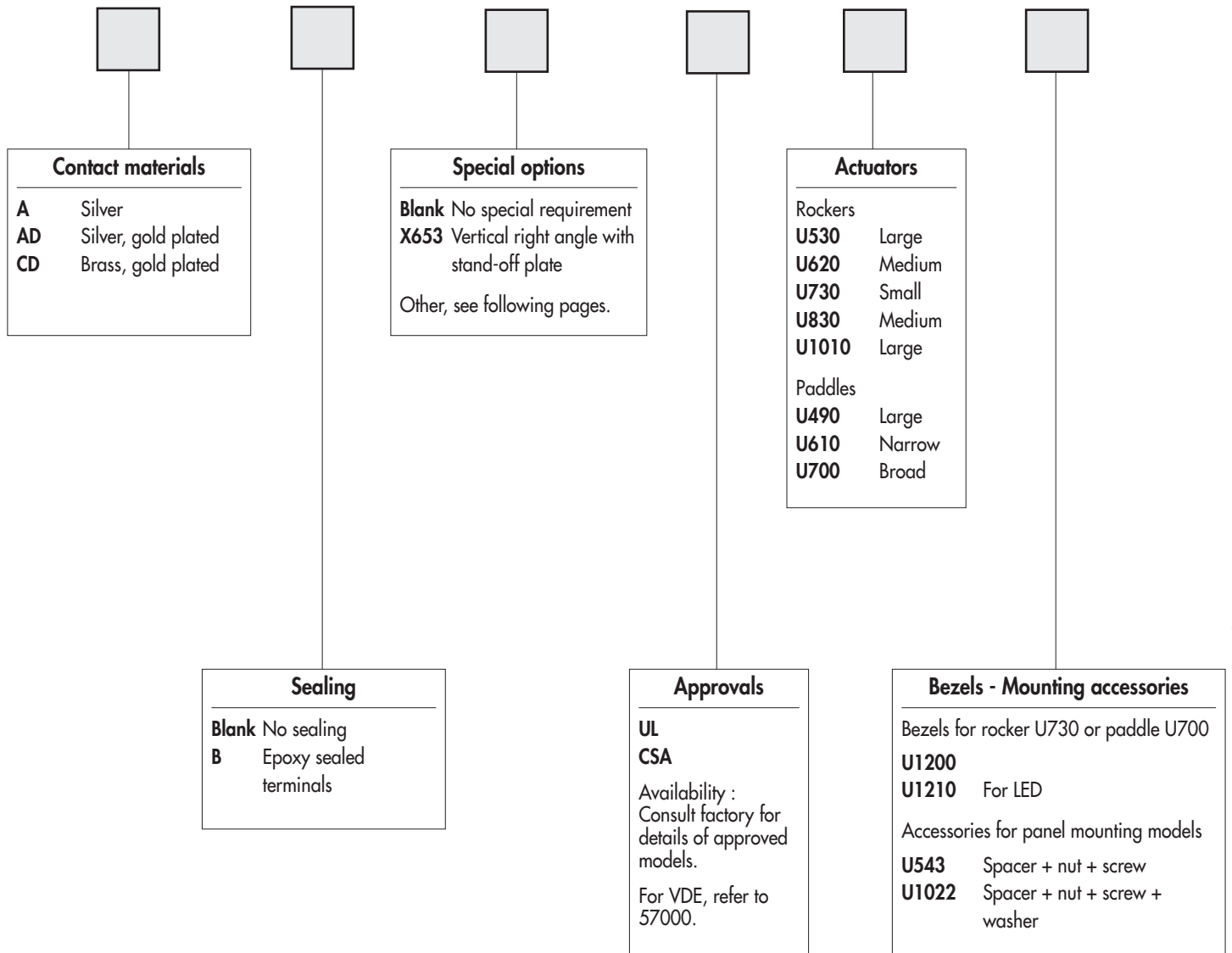

D



Packaging unit : 25 pieces.

7000 series

Rocker and paddle switches

Distinctive features and specifications



- ❑ Wide variety of actuators
- ❑ Many mounting styles for panel or PCB
- ❑ UL and CSA approved

ELECTRICAL SPECIFICATIONS

- Current/voltage rating with resistive load :

Contact	Maximum	Minimum	Level *
Silver A	4A 30VDC	50mA 10VDC	III and IV
Silver, gold plated AD	4A 30VDC Gold plating withstands up to 100mA 30VDC.	10mA 50mV 10µA 5V	I to IV
Brass, gold plated CD	0,4 VA at 20VAC or DC	10mA 50mV 10µA 5V	I and II

- For inductive, lamp or capacitive loads, consult factory. * For details, see technical information, end of catalogue.
- Initial contact resistance : 10 mΩ
- Insulation resistance : 1.000 MΩ min. at 500VDC
- Dielectric strength :
 - 1.000 Vrms 50 Hz min. between terminals
 - 1.500 Vrms 50 Hz min. between poles
 - 1.500 Vrms 50 Hz min. between terminals and frame
- Contact bounce : 2 ms max.
- Electrical life : 50.000 cycles at full load

MATERIALS

- Case : diallyphthalate (DAP) or high temperature plastic material (UL94-V0)
- Actuator : polyamide
- Housing : stainless steel or steel tin plated
- Bracket : steel, tin plated
- Contacts
 - A : silver
 - AD : silver, gold plated
 - CD : brass, gold plated
- Terminal seal : epoxy

GENERAL SPECIFICATIONS

- Low level or mechanical life : 100.000 cycles
- Panel thickness : 1 (.039) to 2,5 mm(.098)
- Operating temperature : -40°C to +85°C

AGENCY APPROVALS



3A 250VAC
6A 125VAC

For VDE, refer to 57000 series.

Availability : consult factory for details of approved models.

Marking : to order switches marked UL or CSA, complete appropriate box of ordering format.



7000 series

Rocker and paddle switches

Snap-in mounting : 7600 - 7200 - 7400

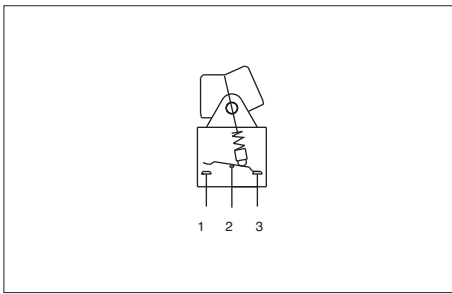

- Solder lug or straight PC terminals
- Epoxy sealing standard on models with straight PC terminals

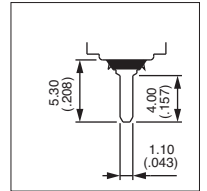
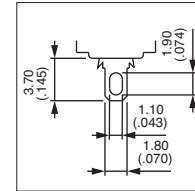

MODEL STRUCTURE

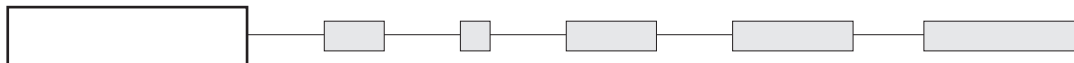

Shown with rocker U730 and bezel U1200

Solder lug terminals : 7600



Single pole Double pole

7636	7646	ON	-	ON
7639	7649	ON	OFF	ON
7637	7647	MOM	OFF	MOM
7638	7648	ON	OFF	MOM
7632	7642	ON	-	MOM
	7644*	ON	ON	ON
	7644 1R*	ON	ON	MOM
	7644 2R*	MOM	ON	MOM

III	II	I
2-3		1-2
5-6		4-5

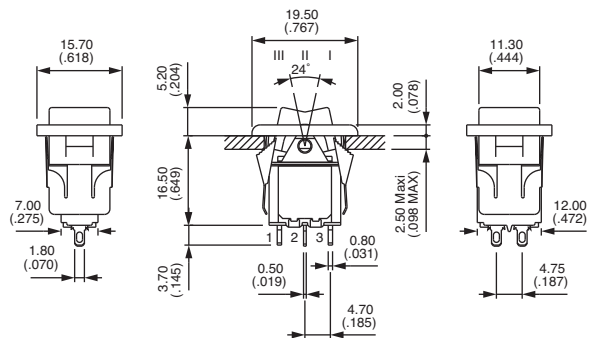

Straight PC terminals - spacing 4,7 (.185) : 7200



Single pole Double pole

7236 B	7246 B	ON	-	ON
7239 B	7249 B	ON	OFF	ON
7237 B	7247 B	MOM	OFF	MOM
7238 B	7248 B	ON	OFF	MOM
7232 B	7242 B	ON	-	MOM
	7244 B*	ON	ON	ON
	7244 1R B*	ON	ON	MOM
	7244 2R B*	MOM	ON	MOM

III	II	I
2-3		1-2
5-6		4-5

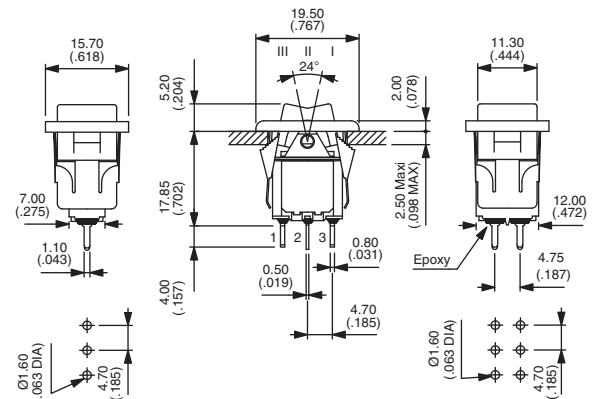

Straight PC terminals - spacing 4 (.157) : 7400



Single pole Double pole

7436 B	7446 B	ON	-	ON
7439 B	7449 B	ON	OFF	ON
7437 B	7447 B	MOM	OFF	MOM
7438 B	7448 B	ON	OFF	MOM
7432 B	7442 B	ON	-	MOM
	7444 B*	ON	ON	ON
	7444 1R B*	ON	ON	MOM
	7444 2R B*	MOM	ON	MOM

III	II	I
2-3		1-2
5-6		4-5

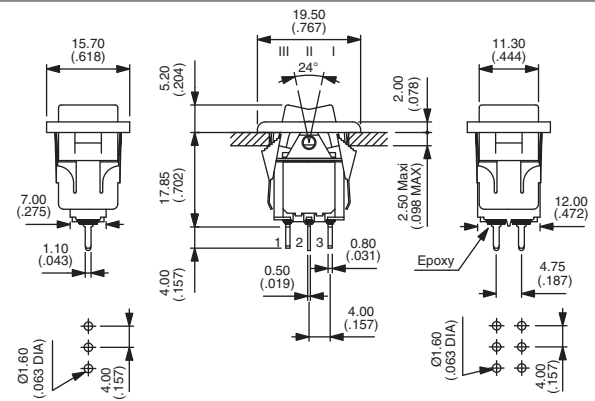

* Function 4 : SP in DP case - specify CT or TH connections, see end of catalogue.

7000 series

Rocker and paddle switches

Snap-in mounting : 7200Z

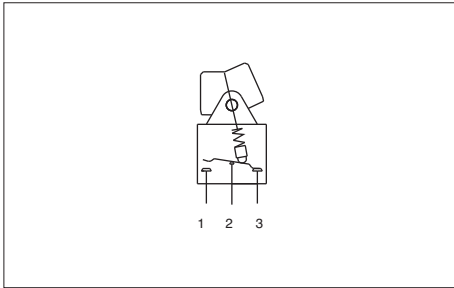

- Quick-connect terminals

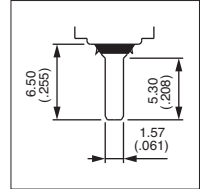

MODEL
STRUCTURE

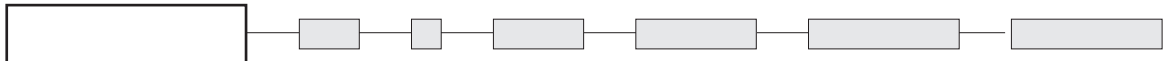

Shown with rocker U730 and bezel U1200

Quick-connect terminals : 7200Z



Single pole	Double pole
7236Z	7246Z
7239Z	7249Z
7237Z	7247Z
7238Z	7248Z
7232Z	7242Z
	7244Z*
	7244Z 1R*
	7244Z 2R*

III	II	I
2-3		1-2
5-6		4-5
ON	-	ON
ON	OFF	ON
MOM	OFF	MOM
ON	OFF	MOM
ON	-	MOM
ON	ON	ON
ON	ON	MOM
MOM	ON	MOM

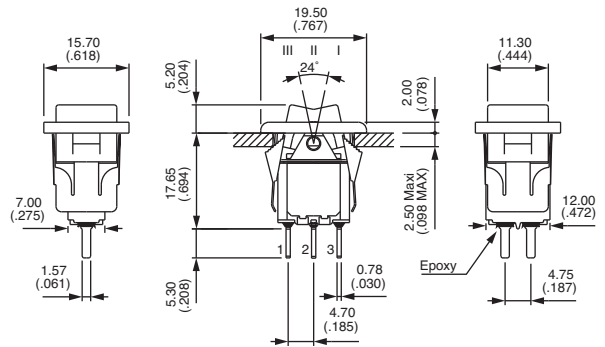

* Function 4 : SP in DP case - specify CT or TH connections, see end of catalogue.

PANEL CUT-OUT

7600 - 7200 - 7400 - 7200Z

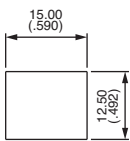

With or without bezel U1200

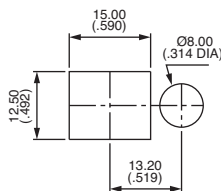

With bezel U1210



7000 series

Rocker and paddle switches

Panel mounting : 7700 - 7900

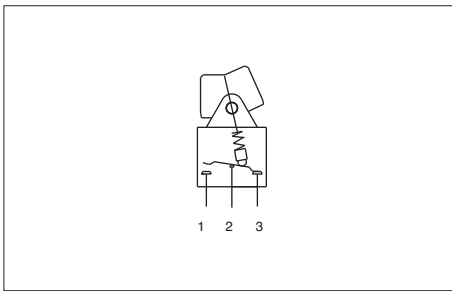

- Large rocker or paddle
- Solder lug or straight PC terminals
- Quick-connect terminals : on request
- Epoxy sealing standard on models with straight PC terminals

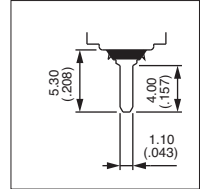
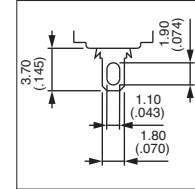

MODEL STRUCTURE

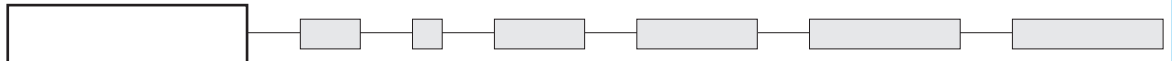

Shown with rocker U530

Solder lug terminals : 7700



Single pole	Double pole
7736	7746
7739	7749
7737	7747
7738	7748
7732	7742
	7744*
	7744 1R*
	7744 2R*

III	II	I
2-3		1-2
5-6		4-5
ON	-	ON
ON	OFF	ON
MOM	OFF	MOM
ON	OFF	MOM
ON	-	MOM
ON	ON	ON
ON	ON	MOM
MOM	ON	MOM

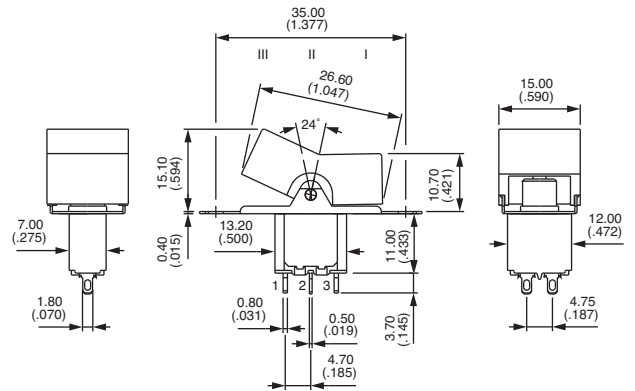

Straight PC terminals : 7900



Single pole	Double pole
7936 B	7946 B
7939 B	7949 B
7937 B	7947 B
7938 B	7948 B
7932 B	7942 B
	7944 B*
	7944 1R B*
	7944 2R B*

III	II	I
2-3		1-2
5-6		4-5
ON	-	ON
ON	OFF	ON
MOM	OFF	MOM
ON	OFF	MOM
ON	-	MOM
ON	ON	ON
ON	ON	MOM
MOM	ON	MOM

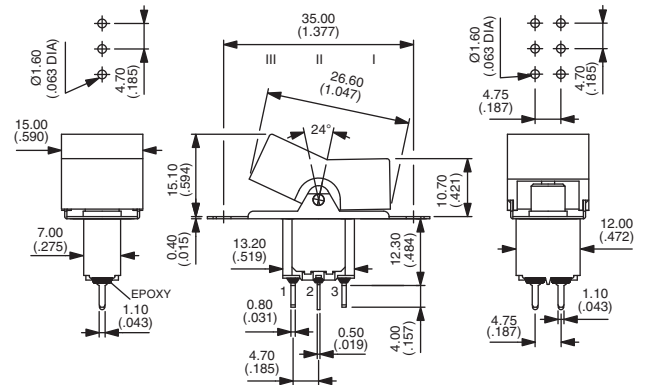

* Function 4 : SP in DP case - specify CT or TH connections, see end of catalogue.

PANEL CUT-OUT

7700 - 7900

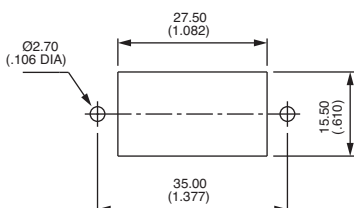

7000 series

Rocker and paddle switches

Panel mounting : 7700N - 7900N

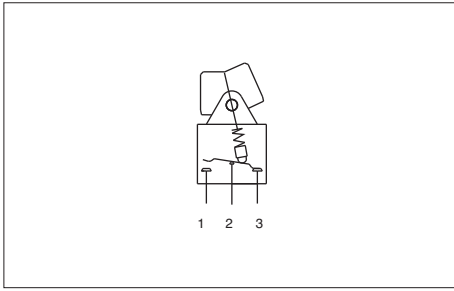

- Small or medium rocker or paddle
- Solder lug or straight PC terminals
- Quick-connect terminals : on request
- Epoxy sealing standard on models with straight PC terminals

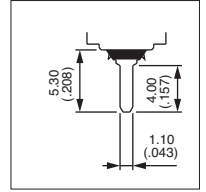
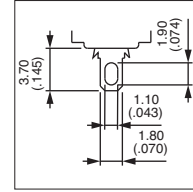

MODEL STRUCTURE

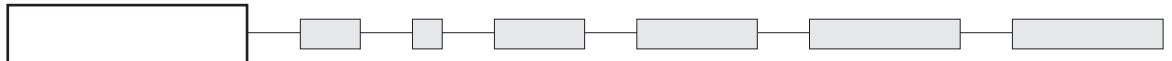

Shown with rocker U620

Solder lug terminals : 7700N



Single pole	Double pole
7736N	7746N
7739N	7749N
7737N	7747N
7738N	7748N
7732N	7742N
	7744N*
	7744N 1R*
	7744N 2R*

III	II	I
2-3		1-2
5-6		4-5
ON	-	ON
ON	OFF	ON
MOM	OFF	MOM
ON	OFF	MOM
ON	-	MOM
ON	ON	ON
ON	ON	MOM
MOM	ON	MOM

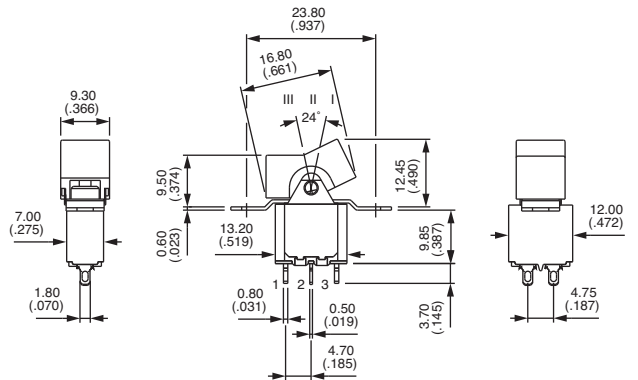

Straight PC terminals : 7900N



Single pole	Double pole
7936N B	7946N B
7939N B	7949N B
7937N B	7947N B
7938N B	7948N B
7932N B	7942N B
	7944N B*
	7944N 1R B*
	7944N 2R B*

III	II	I
2-3		1-2
5-6		4-5
ON	-	ON
ON	OFF	ON
MOM	OFF	MOM
ON	OFF	MOM
ON	-	MOM
ON	ON	ON
ON	ON	MOM
MOM	ON	MOM

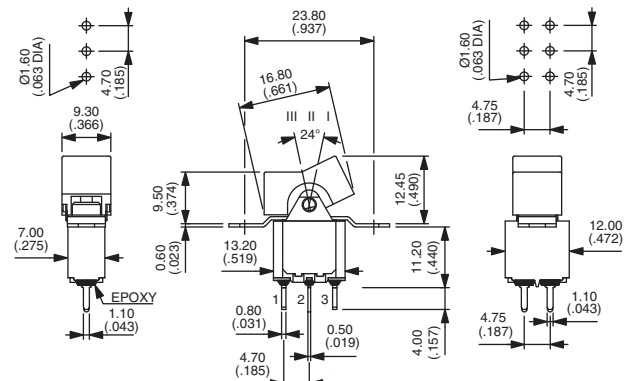

* Function 4 : SP in DP case - specify CT or TH connections, see end of catalogue.

PANEL CUT-OUT

7700N - 7900N

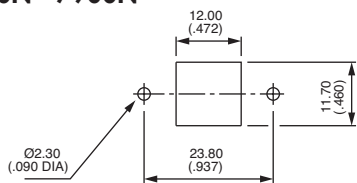

With small rocker **U730**
or small paddle **U700**

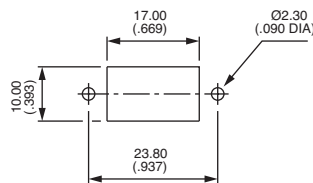

With medium rocker **U620**
or medium paddle **U610**



7000 series

Rocker and paddle switches

Right angle terminals - horizontal : 7900W

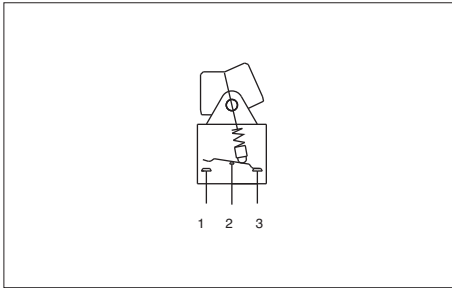

MODEL
STRUCTURE

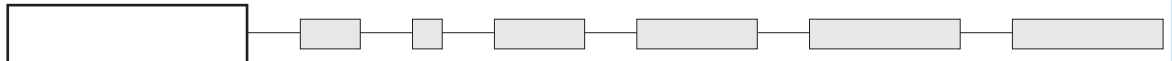

Shown with rocker U620

Single pole



7936W
7939W
7937W
7938W**
7932W**

III	II	I
2-3		1-2
ON	-	ON
ON	OFF	ON
MOM	OFF	MOM
ON	OFF	MOM
ON	-	MOM

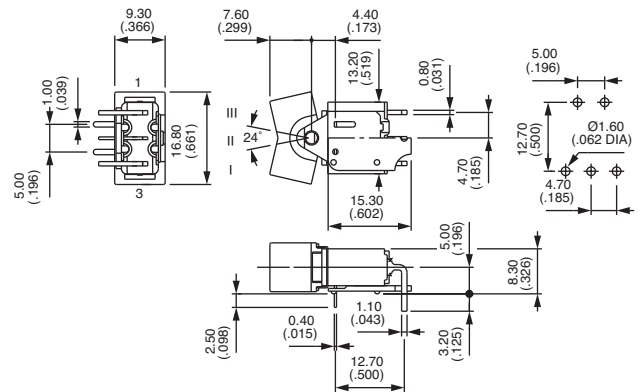

Double pole



7946W
7949W
7947W
7948W**
7942W**
7944W*
7944W 1R*
7944W 2R*

III	II	I
2-3		1-2
5-6		4-5
ON	-	ON
ON	OFF	ON
MOM	OFF	MOM
ON	OFF	MOM
ON	-	MOM
ON	ON	ON
ON	ON	MOM
MOM	ON	MOM

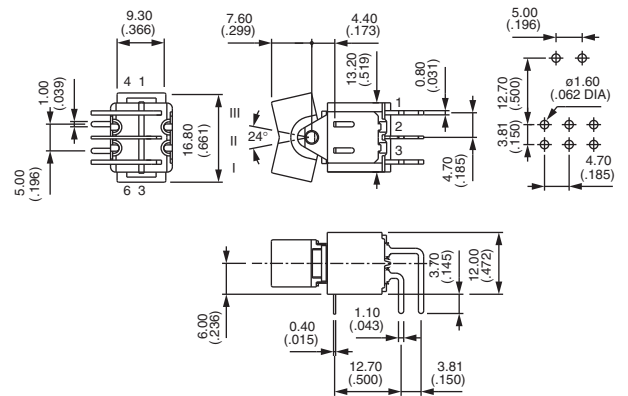

* Function 4 : SP in DP case - specify CT or TH connections, see end of catalogue.

** Functions 2 and 8 : standard connection (CT) shown on drawing - reversed connection available. Consult factory.

PANEL CUT-OUT

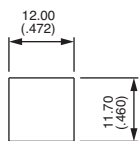

With small rocker **U730**
or small paddle **U700**

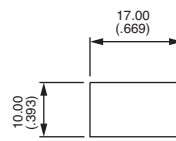

With medium rocker **U620**
or medium paddle **U610**

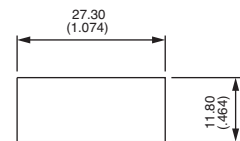

With large rocker **U1010**

7000 series

Rocker and paddle switches

Right angle terminals - vertical : 7000WW

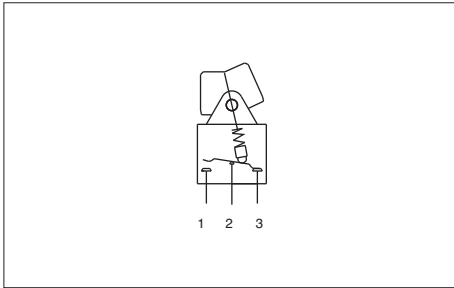

MODEL STRUCTURE

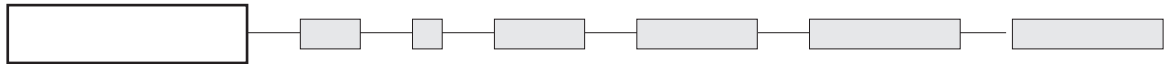

Shown with rocker U830

Single pole



7036WW
7039WW
7037WW
7038WW**
7032WW**

III	II	I
2-3		1-2
ON	-	ON
ON	OFF	ON
MOM	OFF	MOM
ON	OFF	MOM
ON	-	MOM

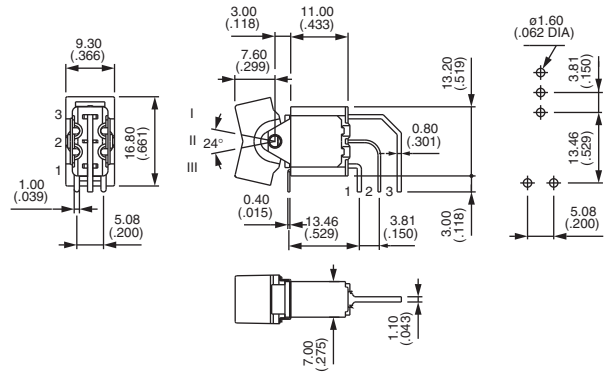

Double pole



7046WW
7049WW
7047WW
7048WW**
7042WW**
7044WW*
7044WW 1R*
7044WW 2R*

III	II	I
2-3		1-2
5-6		4-5
ON	-	ON
ON	OFF	ON
MOM	OFF	MOM
ON	OFF	MOM
ON	-	MOM
ON	ON	ON
ON	ON	MOM
MOM	ON	MOM

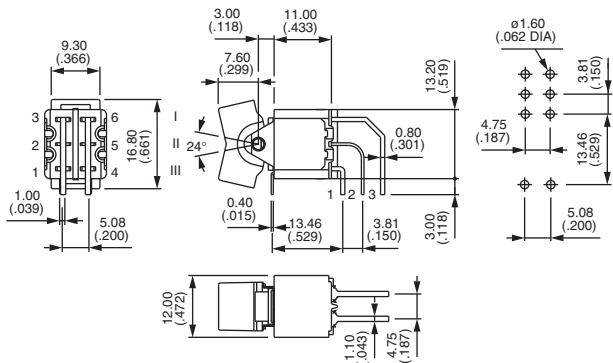

* Function 4 :SP in DP case - specify CT or TH connections, see end of catalogue.

** Functions 2 and 8 : standard connection (CT) shown on drawing - reversed connection available. Consult factory.

PANEL CUT-OUT

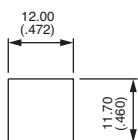

With small rocker **U730**

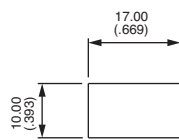

With medium rocker **U830**

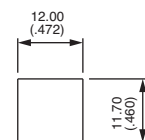

With broad paddle **U700**



7000 series

Rocker and paddle switches

Straight PC terminals - bracket mounting : 7000Y

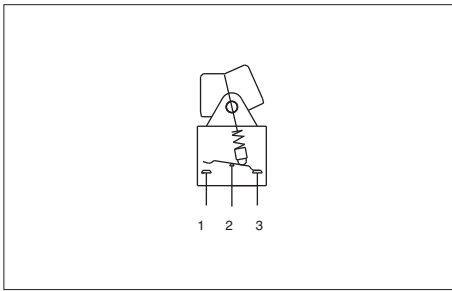

Brackets reduce mechanical stress on solder joints and increase the resistance to vibrations.

- Epoxy sealed terminals standard (B included in model structure)

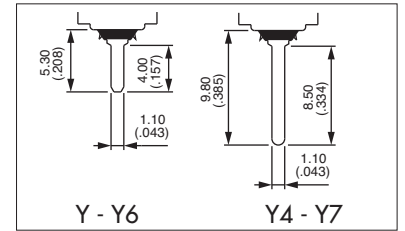

MODEL STRUCTURE

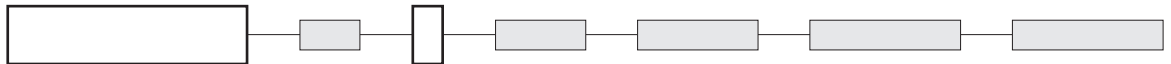

Shown with rocker U620

Short bracket - width 15,75 (.620) - single pole : 7030Y



7036Y B
7039Y B
7037Y B
7038Y B
7032Y B

III	II	I
2-3		1-2
5-6		4-5
ON	-	ON
ON	OFF	ON
MOM	OFF	MOM
ON	OFF	MOM
ON	-	MOM

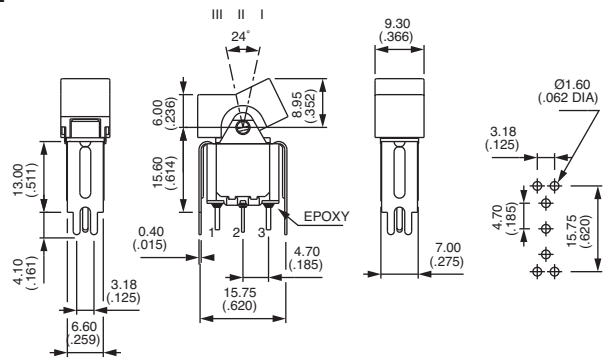

Short bracket - width 15,75 (.620) - double pole : 7040Y



7046Y B
7049Y B
7047Y B
7048Y B
7042Y B
7044Y* B
7044Y 1R* B
7044Y 2R* B

III	II	I
2-3		1-2
5-6		4-5
ON	-	ON
ON	OFF	ON
MOM	OFF	MOM
ON	OFF	MOM
ON	-	MOM
ON	ON	ON
ON	ON	MOM
MOM	ON	MOM

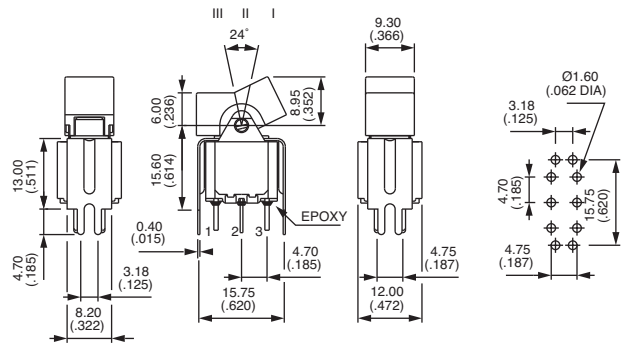

* Function 4 : SP in DP case - specify CT or TH connections, see end of catalogue.

7000 series

Rocker and paddle switches

Straight PC terminals - bracket mounting : 7000Y4 - Y6 - Y7



Tall bracket - width 15,75 (.620) : 7000Y4



	III	II	I
	2-3		1-2
	5-6		4-5
Single pole			
7036Y4 B	ON	-	ON
7039Y4 B	ON	OFF	ON
7037Y4 B	MOM	OFF	MOM
7038Y4 B	ON	OFF	MOM
7032Y4 B	ON	-	MOM
	7044Y4* B	ON	ON
	7044Y4 1R* B	ON	ON
	7044Y4 2R* B	MOM	ON

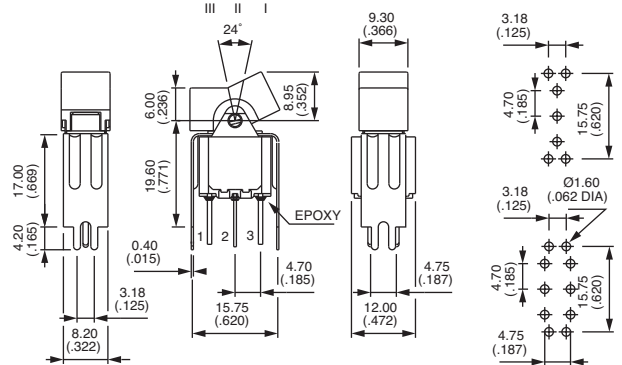

Short bracket - width 19,05 (.750) : 7000Y6



	III	II	I
	2-3		1-2
	5-6		4-5
Single pole			
7036Y6 B	ON	-	ON
7039Y6 B	ON	OFF	ON
7037Y6 B	MOM	OFF	MOM
7038Y6 B	ON	OFF	MOM
7032Y6 B	ON	-	MOM
	7044Y6* B	ON	ON
	7044Y6 1R* B	ON	ON
	7044Y6 2R* B	MOM	ON

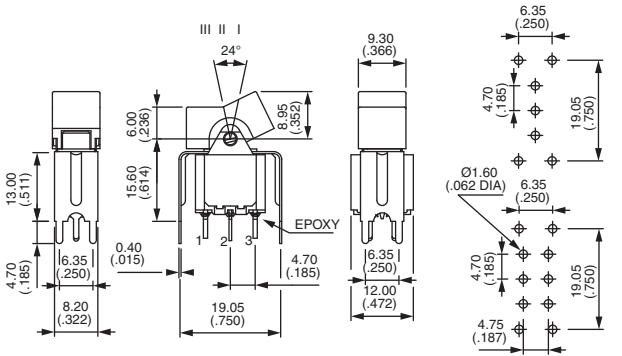

Tall bracket - width 19,05 (.750) : 7000Y7



	III	II	I
	2-3		1-2
	5-6		4-5
Single pole			
7036Y7 B	ON	-	ON
7039Y7 B	ON	OFF	ON
7037Y7 B	MOM	OFF	MOM
7038Y7 B	ON	OFF	MOM
7032Y7 B	ON	-	MOM
	7044Y7* B	ON	ON
	7044Y7 1R* B	ON	ON
	7044Y7 2R* B	MOM	ON

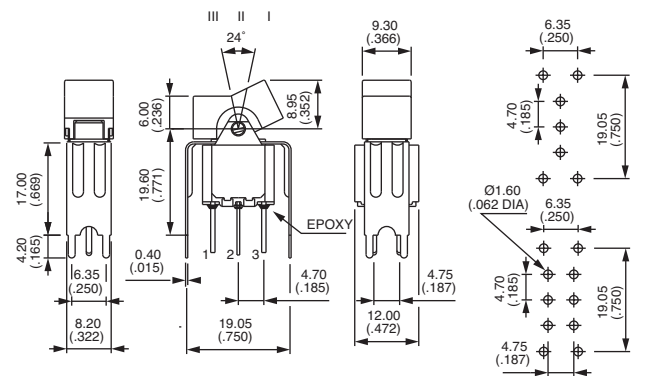

* Function 4 :SP in DP case - specify CT or TH connections, see end of catalogue.

PANEL CUT-OUT

7000Y - Y4 - Y6 - Y7

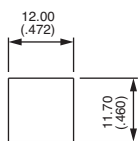

With small rocker **U730**
or small paddle **U700**

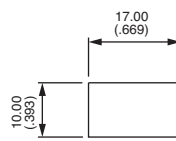

With medium rocker **U620**
or medium paddle **U610**

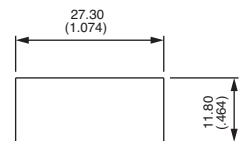

With large rocker **U1010**



7000 series

Rocker and paddle switches

CONTACT MATERIALS

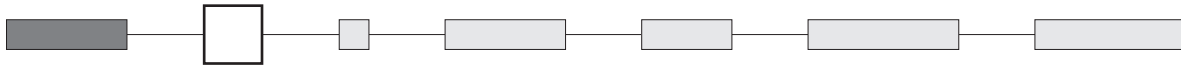

- A Silver
- AD Silver, gold plated
- CD Brass, gold plated

SEALING

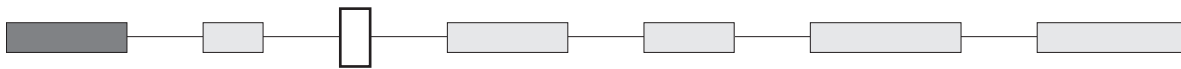

- Blank No sealing
- B Epoxy sealed terminals

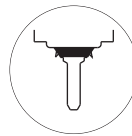

SPECIAL OPTIONS

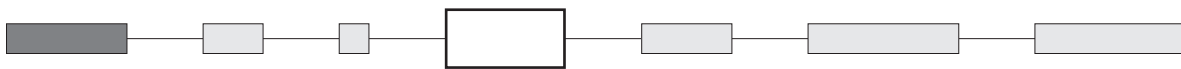

- Blank No special requirement
- X653 Vertical right angle with stand-off plate

Shown with rocker U620

	III	II	I
	2-3		1-2
	5-6		4-5

Single pole	Double pole	ON	-	ON
7036WW X653	7046WW X653	ON	-	ON
7039WW X653	7049WW X653	ON	OFF	ON
7037WW X653	7047WW X653	MOM	OFF	MOM
7038WW X653	7048WW X653**	ON	OFF	MOM
7032WW X653	7042WW X653**	ON	-	MOM
	7044WW X653*	ON	ON	ON
	7044 1RWW X653*	ON	ON	MOM
	7044 2RWW X653*	MOM	ON	MOM

* Function 4 : SP in DP case - specify CT or TH connections, see end of catalogue.
 ** Functions 2 and 8 : reversed connection available. Consult factory.

Actuators for X653 : small rocker U730 and medium rocker U620, broad paddle U700 and narrow paddle U610.

- X601 Silver plated brass contacts
 Current voltage rating for an electrical life of 20.000 cycles : 0,5A 30VDC
 Minimum quantity : 5.000 pieces per model and shipment.

7000 series

Rocker and paddle switches

OPTIONS



AGENCY APPROVALS

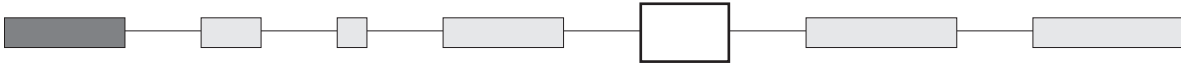

UL
CSA

All standard models

Availability : consult factory for details of approved combinations or options.

Marking : to order switches marked UL or CSA, complete above box with desired approvals in this order, without space (ex. ULCSA). Blank : no agency approval required.

VDE (with UL & CSA)

Refer to **57000** series on the following pages.

ACTUATORS

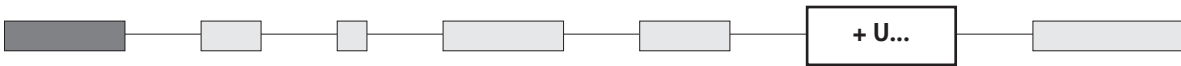

For snap-in mounting models : 7600 - 7200 - 7400 - 7200Z

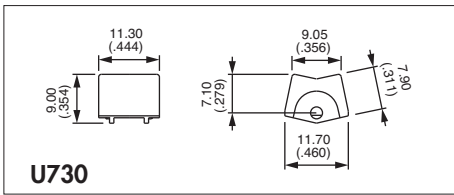

U730

Small rocker

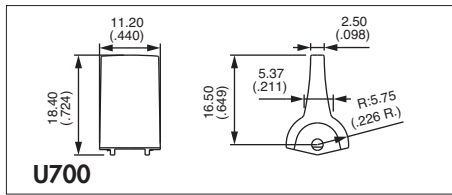

U700

Broad paddle

Actuator colours	
Replace last "0" by number	
1	blue
1/4	dark blue
2	black
3	green
4	grey
5	yellow
6	red
7	ivory
7/1	white
9	orange

For 7700 and 7900 models

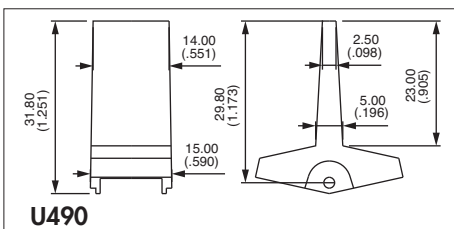

U490

Large paddle

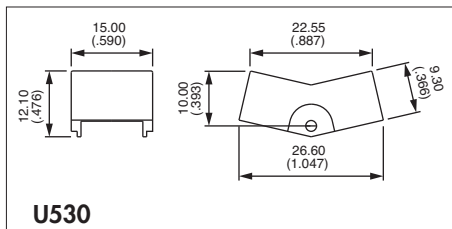

U530

Large rocker

For 7700N - 7900N - 7900W - 7000WWX653 and 7000Y models

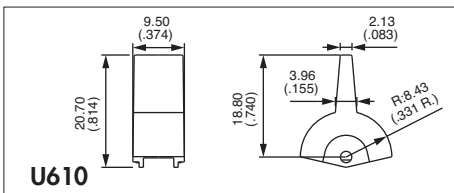

U610

Narrow paddle

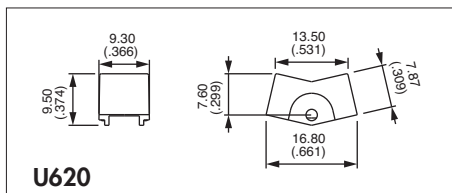

U620

Medium rocker

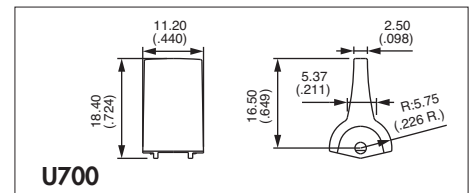

U700

Broad paddle

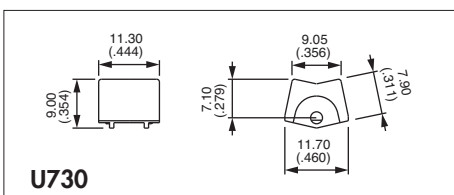

U730

Small rocker

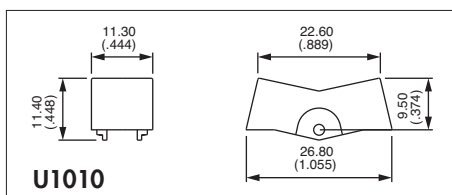

U1010

Large rocker
For 7900W, available on DP only.

D



7000 series

Rocker and paddle switches

ACTUATORS (continued)

For 7000WW models

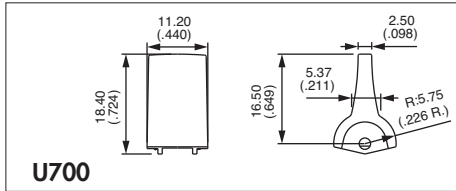

U700

Broad paddle

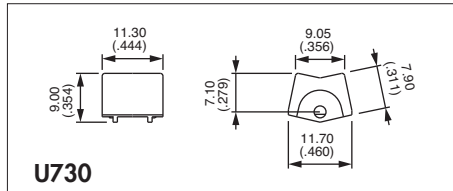

U730

Small rocker

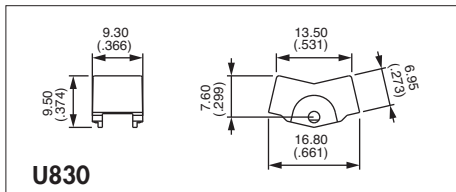

U830

Medium rocker

Actuator colours

Replace last "0" by number

- 1 blue
- 1/4 dark blue
- 2 black
- 3 green
- 4 grey
- 5 yellow
- 6 red
- 7 ivory
- 7/1 white
- 9 orange

BEZELS - MOUNTING ACCESSORIES



Bezels for paddle U700 and rocker U730

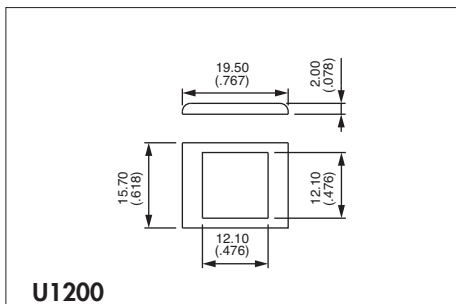

U1200

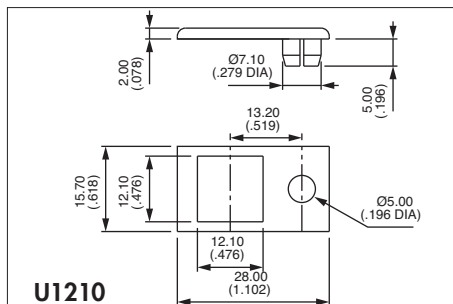

U1210

For LED Ø 5 (.196) - not supplied

Bezel colours

Replace last "0" by number

- 1 blue
- 1/4 dark blue
- 2 black
- 3 green
- 4 grey
- 5 yellow
- 6 red
- 7 ivory
- 7/1 white
- 9 orange

STANDARD PANEL MOUNTING

Panel thickness with bezel 1 to 2,5 mm (.039 to .098)

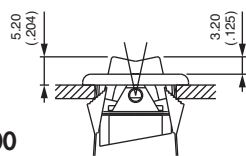

U730 + U1200

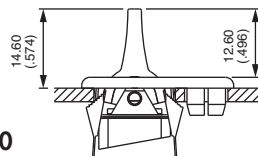

U700 + U1210

Mounting accessories

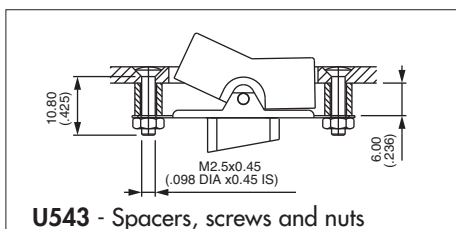

U543 - Spacers, screws and nuts

For rocker U530 or paddle U490

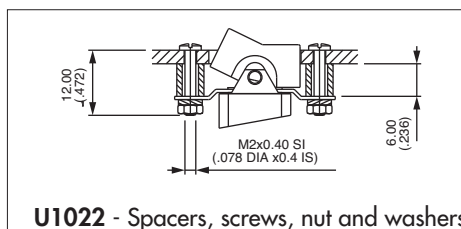

U1022 - Spacers, screws, nut and washers

For rockers U620 or U730
For paddles U610 or U700