

Sealing boots



- Prevent dust, sand and water from getting into switches.
- On toggle versions, also prevent ice from blocking lever action
- Compatible with frontal sealing options (K and X408).
- Available in a wide range of colours.
- When necessary, a sealing ring or washer is supplied with the boot.

MATERIALS AND SPECIFICATIONS

- Boot material : neoprene or silicone (see comparative advantages below)
 - Nut material : brass, nickel plated or matt black
 - Operating temperature :
 - neoprene boots : -20°C to +50°C
 - silicone boots : -40°C to + 85°C
- ++ : excellent, + : good, - : poor

COMPARATIVE ADVANTAGES	TEMPERATURE RANGE		ELASTICITY	MECHANICAL RESISTANCE
	LOW	HIGH		
Silicone	++	++	++	-
Neoprene	-	+	-	++

DIFFERENT TYPES OF BOOTS

* Colour options available

Full-toggle (standard) *

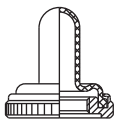

Half-toggle *

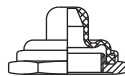

Two-part (no metal parts accessible) *

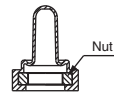

For double sealing

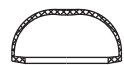

EXAMPLES OF MOUNTING

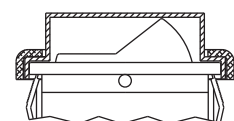
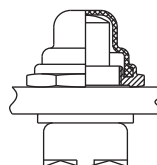
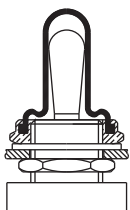

Sealing boots

For toggle switches

For bushing $\varnothing 6 \times 0.75 (.236 \times 0.75)$ - 5500 series



NUT	FULL-TOGGLE SILICONE BOOTS			
	Black	Red	Green	White
Knurled Nickel plated	N32161005 (U1341)	N32162005 (U1341-6)	N3216V005 (U1341-3)	N3216B005 (U1341-7)
Knurled Matt black	N32161002 (U1343)	N32162002 (U1343-6)	N3216V002 (U1343-3)	N3216B002 (U1343-7)
Hex Nickel plated	N32121005 (U1302)	N32122005 (U1302-6)	N3212V005 (U1302-3)	N3212B005 (U1302-7)
Hex Matt black	N32121002 (U1304)	N32122002 (U1304-6)	N3212V002 (U1304-3)	N3212B002 (U1304-7)

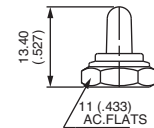
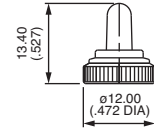

For bushing $\varnothing 6,35-40NS (1/4-40UNS)$ - 5000 and 11000 series



NUT	FULL-TOGGLE SILICONE BOOTS			
	Black	Red	Green	White
Knurled Nickel plated	N33161005 (U1331)	N33162005 (U1331-6)	N3316V005 (U1331-3)	N3316B005 (U1331-7)
Knurled Matt black	N33161002 (U1333)	N33162002 (U1333-6)	N3316V002 (U1333-3)	N3316B002 (U1333-7)
Hex Nickel plated	N33121005 (U1229)	N33122005 (U1229-6)	N3312V005 (U1229-3)	N3312B005 (U1229-7)
Hex Matt black	N33121002 (U1231)	N33122002 (U1231-6)	N3312V002 (U1231-3)	N3312B002 (U1231-7)

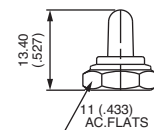
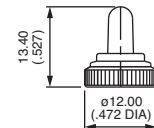

For bushing $\varnothing 6,35-40NS (1/4-40UNS)$ - 5000 and 11000 series



BOOTS SUPPLIED AS 2 SEPARATE PARTS			
NEOPRENE	SILICONE		
Black	Red	Green	White
N33136119 (U5149)	N33137119 (U5149-6)	N3313V119 (U5149-3)	N3313B119 (U5149-7)

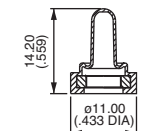

Once the boot is mounted onto the panel, no switch metal part is accessible any more.

For bushing $\varnothing 10 \times 0.75 (.393 \times 0.75)$ - 10600 series



KNURLED NUT	FULL-TOGGLE SILICONE BOOTS			
	Black	Red	Green	White
Nickel plated	N34151005 (U1612)	N34152005 (U1612-6)	N3415V005 (U1612-3)	N3415B005 (U1612-7)
Matt black	N34151002 (U1614)	N34152002 (U1614-6)	N3415V002 (U1614-3)	N3415B002 (U1614-7)

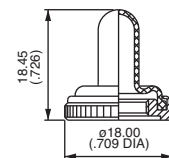

For bushing $\varnothing 11,9-32 NS (15/32-32NS)$ - 12000, 5000M, 3500 and 6000 series



HEX NUT	FULL-TOGGLE SILICONE BOOTS			
	Black	Red	Green	White
Nickel plated	N35111005 (U1031)	N35112005 (U1031-6)	N3511V005 (U1031-3)	N3511B005 (U1031-7)
Matt black	N35111002 (U1024)	N35112002 (U1024-6)	N3511V002 (U1024-3)	-

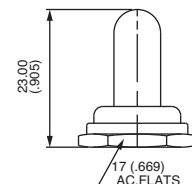

Sealing boots

For toggle switches

For bushing Ø 11,9-32 NS (15/32-32NS) - 12000, 3500 and 6000 series



HEX NUT	HALF-TOGGLE SILICONE BOOTS			
	Black	Red	Green	White
Nickel plated	N35111015 (U1600)	N35112015 (U1600-6)	N3511V015 (U1600-3)	N3511B015 (U1600-7)
Matt black	N35111012 (U1602)	N35112012 (U1602-6)	N3511V012 (U1602-3)	-

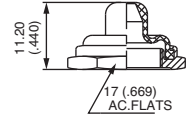

For bushing Ø12 x 0.75 SI (.472x.075 IS) - 12000, 3500, 3600 and 600 series



FULL-TOGGLE BLACK NEOPRENE BOOT	
N36346009	(U2252)

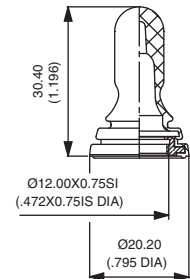

For bushing Ø12 x 0.75 SI (.472x.075 IS) - 600 series with -5 long lever



FULL-TOGGLE BLACK NEOPRENE BOOT	
N36346209	(U2197)

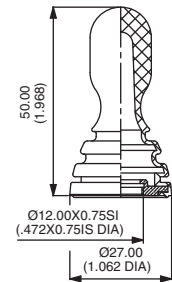

For bushing Ø12 x 0.75 SI (.472x.075 IS) - 4450, 4650 and 1600 series



HEX NUT	FULL-TOGGLE BLACK NEOPRENE BOOTS	
Nickel plated	N36116045	(U09)
Matt black	N36116042	(U223)

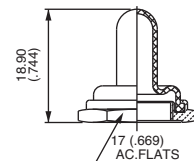

For bushing Ø 12 x 0.75 SI (.472x.075 IS) - 600H, 660, 1000, 1500 and 3600



HEX NUT	FULL-TOGGLE SILICONE BOOTS			
	Black	Red	Green	White
Nickel plated	N36111005 (U1565)	N36112005 (U1565-6)	N3611V005 (U1565-3)	N3611B005 (U1565-7)
Matt black	N36111002 (U1567)	N36112002 (U1567-6)	N3611V002 (U1567-3)	-
FULL-TOGGLE BLACK NEOPRENE BOOTS				
Nickel plated	N36116005		(U851)	
Matt black	N36116002		(U853)	

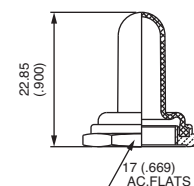

Sealing boots

For toggle switches or pushbutton switches

For bushing Ø 12 x 0.75 SI (.472x.075 IS) - 600H, 660, 1000 and 3600 series



HEX NUT	HALF-TOGGLE SILICONE BOOTS			
	Black	Red	Green	White
Nickel plated	N36111015 (U1151)	N36112015 (U1151-6)	N3611V015 (U1151-3)	N3611B015 (U1151-7)
Matt black	N36111012 (U1153)	N36112012 (U1153-6)	N3611V012 (U1153-3)	-
HALF-TOGGLE BLACK NEOPRENE BOOTS				
Nickel plated	N36116015 (U598)			
Matt black	N36116012 (U600)			

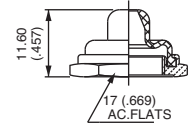

For bushing Ø 4 x 0.70 (.157 x 0.70) - 9500 series



HEX NUT	PUSHBUTTON SILICONE BOOTS			
	Black	Red	Green	White
Nickel plated	N31221005 (U1829)	N31222005 (U1829-6)	N3122V005 (U1829-3)	N3122B005 (U1829-7)
Matt black	N31221002 (U1831)	N31222002 (U1831-6)	N3122V002 (U1831-3)	N3122B002 (U1831-7)

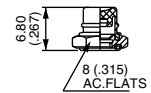

For bushing Ø 6,35-40NS (1/4-40UNS) - 18000, 9000 and 13000 series



NUT	PUSHBUTTON SILICONE BOOTS			
	Black	Red	Green	White
Knurled Nickel plated	N33261005 (U1401)	N33262005 (U1401-6)	N3326V005 (U1401-3)	N3326B005 (U1401-7)
Knurled Matt black	N33261002 (U1403)	N33262002 (U1403-6)	N3326V002 (U1403-3)	N3326B002 (U1403-7)
Hex Nickel plated	N33221005 (U1318)	N33222005 (U1318-6)	N3322V005 (U1318-3)	N3322B005 (U1318-7)
Hex Matt black	N33221002 (U1320)	N33222002 (U1320-6)	N3322V002 (U1320-3)	N3322B002 (U1320-7)

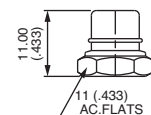
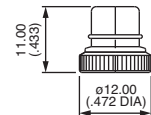

For bushing Ø 6,35-40NS (1/4-40 UNS) - 8000 series



KNURLED NUT	PUSHBUTTON SILICONE BOOTS			
	Black	Red	Green	White
Nickel plated	N33261125 (U4301)	N33262125 (U4301-6)	N3326V125 (U4301-3)	N3326B125 (U4301-7)

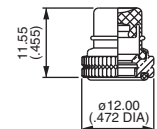

For bushing Ø 10 x 0.75 (.393 x 0.75) - 10400 series



KNURLED NUT	PUSHBUTTON SILICONE BOOTS			
	Black	Red	Green	White
Nickel plated	N34251005 (U1624)	N34252005 (U1624-6)	N3425V005 (U1624-3)	N3425B005 (U1624-7)
Matt black	N34251002 (U1626)	N34252002 (U1626-6)	N3425V002 (U1626-3)	N3425B002 (U1626-7)

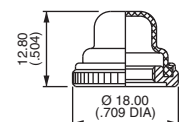

Sealing boots

For pushbutton switches

For bushing \varnothing 11,9-32 NS (15/32-32UNS) - 13000X778, 13000X768 and 8000-6X934 series



HEX NUT	PUSHBUTTON SILICONE BOOTS			
	Black	Red	Green	White
Nickel plated	N35211005 (U589)	N35212005 (U589-6)	N3521V005 (U589-3)	N3521B005 (U589-7)
Matt black	N35211002 (U590)	N35212002 (U590-6)	N3521V002 (U590-3)	-

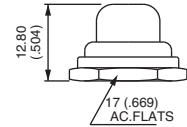

For long plunger (-9) care should be taken over the panel thickness.

For bushing \varnothing 12 x 0.75 SI (.472x.075 IS) - 1200, 4700 and 4800 series



HEX NUT	PUSHBUTTON SILICONE BOOTS			
	Black	Red	Green	White
Nickel plated	N36211005 (U1654)	N36212005 (U1654-6)	N3621V005 (U1654-3)	N3621B005 (U1654-7)
Matt black	N36211002 (U1656)	N36212002 (U1656-6)	N3621V002 (U1656-3)	-
	PUSHBUTTON BLACK NEOPRENE BOOTS			
Nickel plated	N36216005		(U31)	
Matt black	N36216002		(U225)	
Chrome plated	N36216001		(U224)	

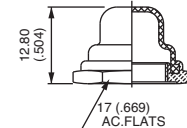

For double sealing on IP and IB-IS series



SILICONE BOOT	
Transparent	U5125
Blue	U5125-1
Black	U5125-2
Red	U5125-6

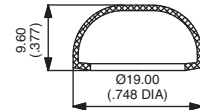

Operating temperature : -40°C to +85°C
The flat seal or O-Ring supplied with the switch should not be used with this boot.

For double sealing on IA seriesa



SILICONE BOOT	
Black	U6602
Yellow	U6605
Red	U6606

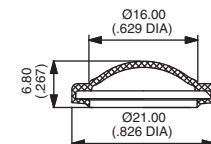

For AV series (models with \varnothing 19 mm bushing)



SILICONE BOOT	
Black	U2187-2
Green	U2187-3
Grey	U2187-4
Yellow	U2187-5
Red	U2187-6
White	U2187-7
Transparent	U2187-8

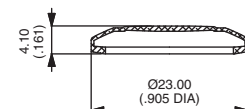

Sealing boots

For pushbutton switches or rocker switches

For LPI series



SILICONE BOOT	
Black	U3082
Transparent	U3088

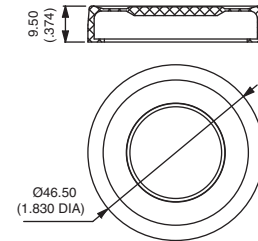

For 2600 series



TRANSPARENT SILICONE BOOT	
U2150	

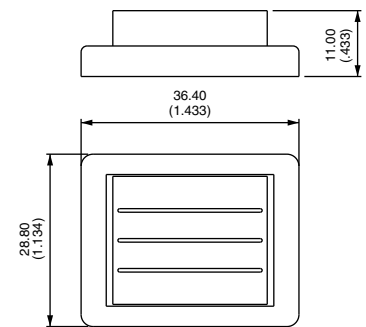

For FM series



TRANSPARENT PVC BOOT	
U5720	

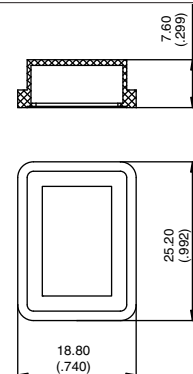

For KG series



BLACK SILICONE BOOT	
U3084	

Also available with pad-printed symbols : on request.

