

SMT TL series

Surface mount tiny washable toggle switches

Distinctive features and specifications

A



- ❑ Entirely designed for surface mount
- ❑ Tape and reel packaging
- ❑ Reflow solderable
 - High temperature plastic materials
 - Tin plated ground plate
 - Terminal coating : tin alloy over nickel plating
 - Terminals turned to the outside, preventing the shadow effect in infrared soldering and permitting visual inspection of solder joints
 - Distance between case and circuit : 0,55 mm (.021)
 - End stackable with 10,16 mm (.40) pitch
 - Available with positioning pins to ensure switch orientation during the reflow process and increasing switch mechanical resistance
- ❑ Protected against electrostatic discharges (ESD) up to 10 KV
- ❑ Washable

Construction withstands cleaning processes, including hot water under pressure

ELECTRICAL SPECIFICATIONS

- Max. current/voltage rating with resistive load : 0,4VA 20V max. AC or DC
- Minimum load : 10mA 50mV or 10µA 5VDC
- Initial contact resistance : 20 mΩ max
- Insulation resistance : 1.000 MΩ min. at 500VDC
- Dielectric strength : 1.000 Vrms. 50 Hz min. between terminals and frame 500 Vrms. 50 Hz min. between terminals
- Electrical life at full load :
 - 2 position switches : 60.000 cycles
 - 3 position switches : 30.000 cycles
- Static resistance : 10 KV (Schaffner equipment)

GENERAL SPECIFICATIONS

- Operating temperature : -40°C to +85°C
- Moisture resistance : 21 days per IEC 512-6 test 11c
- Vibration resistance : 10-500 Hz / 10 g per IEC 512-4 test 6d
- Shock resistance : 50 g per IEC 512-4 test 6c

MATERIALS

- Case : high temperature plastic material UL94-V0
- Actuator : brass, nickel plated, with high temperature UL94-V0 plastic cap
- Ground plate and positioning pins : steel, tin plated
- Contacts : brass, gold plated
- Terminals : brass, with pure tin plating over nickel barrier

SOLDERING AND CLEANING

- Reflow soldering : infrared, vapor phase or infrared convection
- Washable per IEA-RS448-2 :
 - water + detergent - preferred
 - solvents
- Further information on reflow soldering : see end of catalogue.

PACKAGING

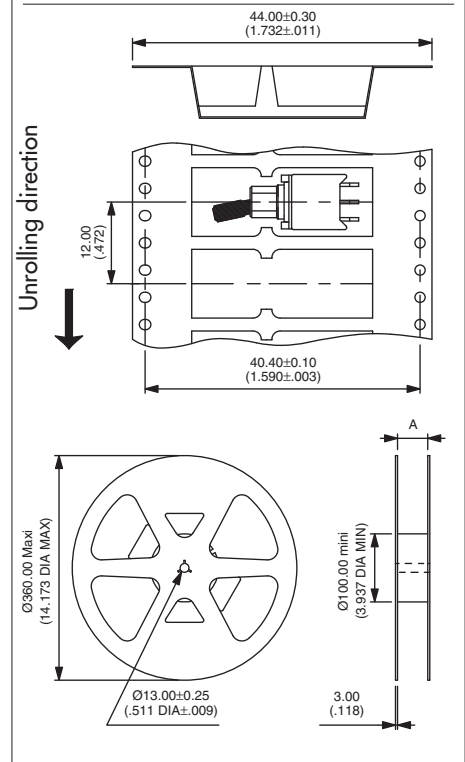

| | | |
|--------------------|----------------------------------|-----------------------------------|
| Tape width | 24.00 (.944) | 44.00 (1.732) |
| Reel (dimension A) | 24.40±2.00/0.00 (.960±.078/.000) | 44.40±2.00/0.00 (1.748±.078/.000) |

Standard packaging unit : 700 pieces
 Tape meeting international standard IEC - Publication 286-3 (EIA481A)
 Start leader : 400 mm min.

Dimensions : First dimensions are in mm while inches are shown as bracketed numbers.

SMT TL series

Surface mount tiny washable toggle switches

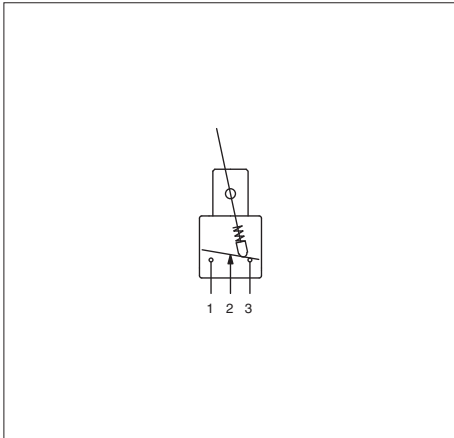

- With or without positioning pins
- Single pole

Also available for vertical mounting. On request.

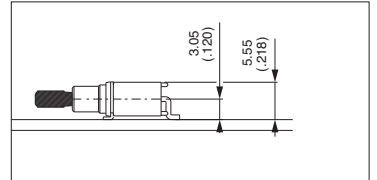

Without positioning pins



TL36WS84000
TL39WS84000
TL37WS84000
TL38WS84000
TL32WS84000

| | III | II | I |
|-------------|-----|-----|-----|
| TL36WS84000 | ON | - | ON |
| TL39WS84000 | ON | OFF | ON |
| TL37WS84000 | MOM | OFF | MOM |
| TL38WS84000 | ON | OFF | MOM |
| TL32WS84000 | ON | - | MOM |

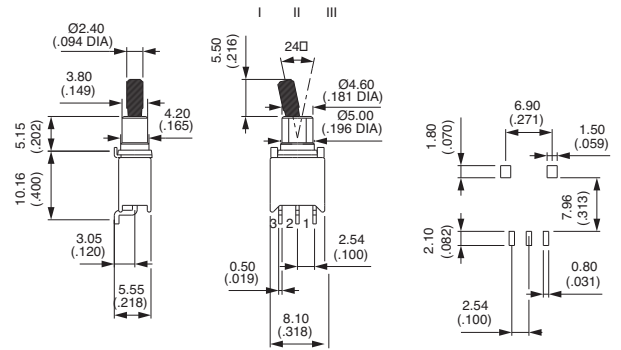

With positioning pins



TL36WS84065
TL39WS84065
TL37WS84065
TL38WS84065
TL32WS84065

| | III | II | I |
|-------------|-----|-----|-----|
| TL36WS84065 | ON | - | ON |
| TL39WS84065 | ON | OFF | ON |
| TL37WS84065 | MOM | OFF | MOM |
| TL38WS84065 | ON | OFF | MOM |
| TL32WS84065 | ON | - | MOM |

