



FEATURES

- RoHS compliant
- Radial format
- Up to 6.3A lbc
- 1.5μH to 68mH
- Low DC resistance
- UL VW-1 rated sleeving
- Backward compatible with Sn/Pb soldering systems
- Custom parts available

DESCRIPTION

The 1300R Series is a general purpose range of inductors suitable for low to medium current applications such as power supply and other general purpose filtering designs.

SELECTION GUIDE

| Order Code | Inductance (1kHz, 0.1V _{AC}) | DC Current ¹ | DC Resistance |
|------------|---|-------------------------|---------------|
| | ±10% | Max. | Max. |
| | μH | A | Ω |
| 13R152C | 1.5 ±20% | 6.3 | 0.008 |
| 13R222C | 2.2 ±20% | 5.3 | 0.010 |
| 13R332C | 3.3 ±20% | 4.8 | 0.013 |
| 13R472C | 4.7 ±20% | 4.3 | 0.017 |
| 13R682C | 6.8 ±20% | 3.5 | 0.023 |
| 13R103C | 10 | 3.0 | 0.031 |
| 13R153C | 15 | 2.5 | 0.042 |
| 13R223C | 22 | 2.0 | 0.070 |
| 13R333C | 33 | 1.8 | 0.092 |
| 13R473C | 47 | 1.5 | 0.110 |
| 13R683C | 68 | 1.3 | 0.150 |
| 13R104C | 100 | 1.0 | 0.240 |
| 13R154C | 150 | 0.82 | 0.330 |
| 13R224C | 220 | 0.70 | 0.470 |
| 13R334C | 330 | 0.58 | 0.640 |
| 13R474C | 470 | 0.45 | 1.05 |
| 13R684C | 680 | 0.42 | 1.50 |
| 13R105C | 1.0mH | 0.33 | 2.10 |
| 13R155C | 1.5mH | 0.28 | 3.10 |
| 13R225C | 2.2mH | 0.24 | 4.50 |
| 13R335C | 3.3mH | 0.19 | 7.0 |
| 13R475C | 4.7mH | 0.16 | 9.3 |
| 13R685C | 6.8mH | 0.13 | 13.5 |
| 13R106C | 10mH | 0.085 | 23.8 |
| 13R156C | 15mH | 0.080 | 31.0 |
| 13R226C | 22mH | 0.070 | 48.0 |
| 13R336C | 33mH | 0.060 | 68.0 |
| 13R476C | 47mH | 0.045 | 120.0 |
| 13R686C | 68mH | 0.040 | 152.0 |

ABSOLUTE MAXIMUM RATINGS

| | |
|--------------------------------------|----------------|
| Operating free air temperature range | -40°C to +85°C |
| Storage temperature range | -40°C to 125°C |

SOLDERING INFORMATION²

| | |
|------------------------------|----------------------|
| Peak wave solder temperature | 260°C for 10 seconds |
| Pin finish | Bright tin |

All specifications typical at T_A=25°C

- 1 Maximum DC current occurs when either the inductance falls to 90% of its nominal value or when its temperature rise reaches 30°C, whichever is sooner.
- 2 For further information, please visit www.murata-ps.com/rohs



INDUCTANCE VS CURRENT

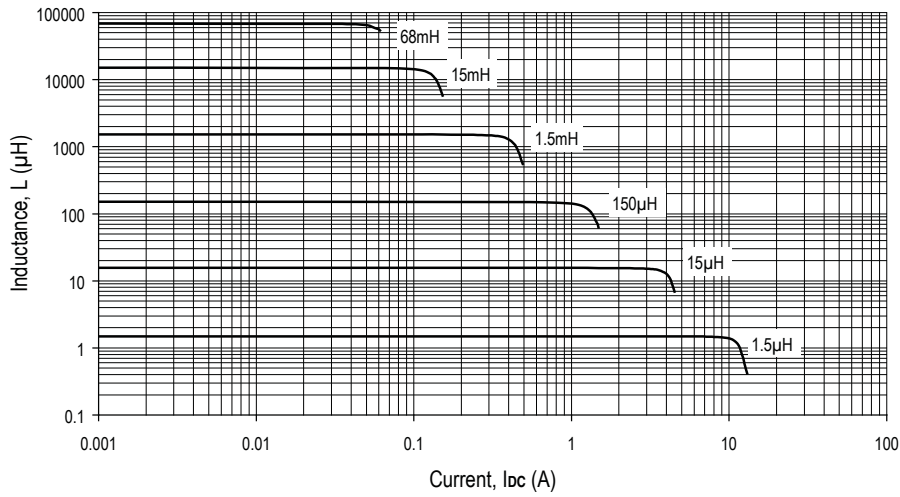

INDUCTANCE VS FREQUENCY

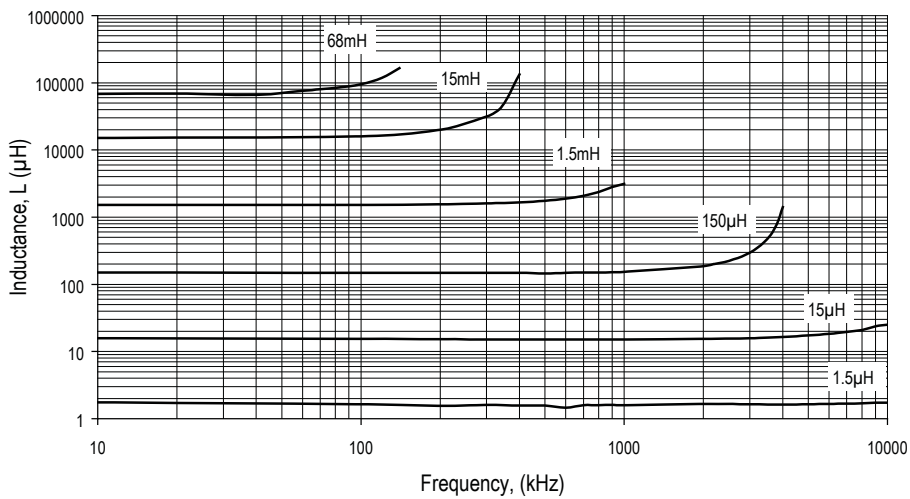

TEMPERATURE VS CURRENT

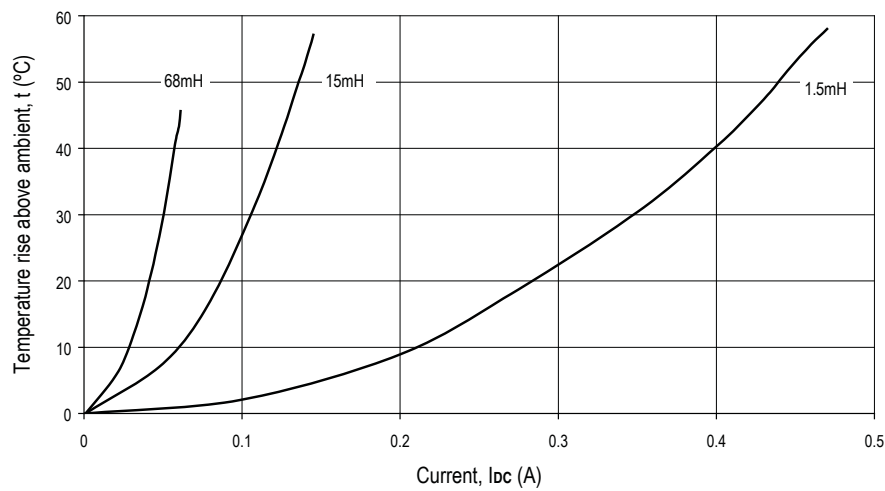
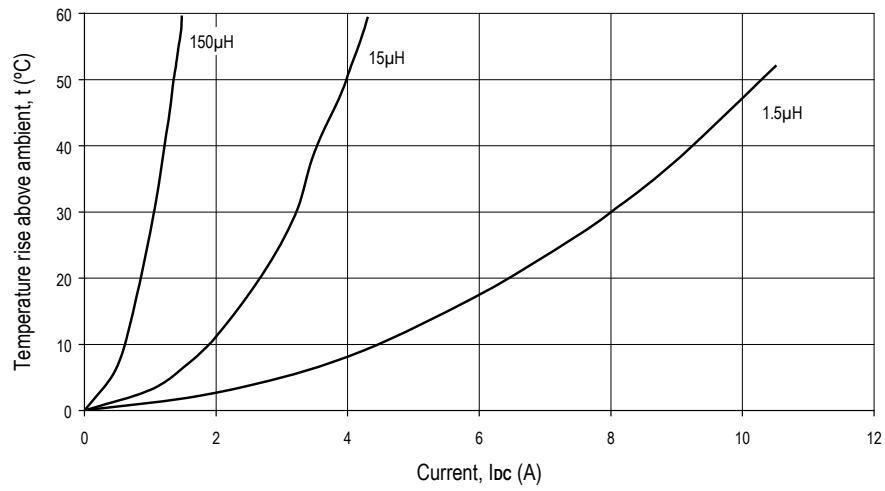

PACKAGE SPECIFICATIONS

MECHANICAL DIMENSIONS

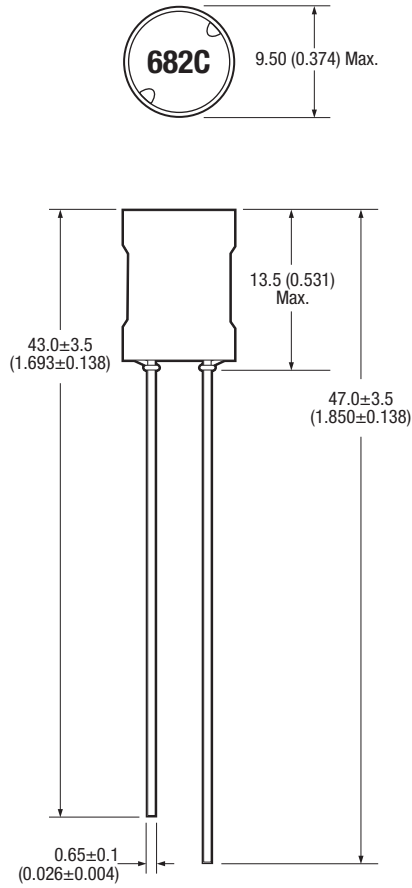

All dimensions in mm (inches). Package weight 2.4g Typ.

RECOMMENDED FOOTPRINT DETAILS

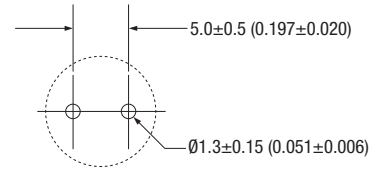

All dimensions in mm (inches)

PACKAGING DETAILS

Supplied in cartons (200 pieces per carton)