

HALO Voltage Drive 1G FastJacks™

ELECTRONICS, INC.

HALO Electronics is pleased to offer this series of small footprint, Gigabit FastJack™ integrated connectors. This series has been designed for voltage drive Phy technology. Optimized to provide consistent return loss and insertion loss performance. UL60950 recognized and IEEE802.3 compliant.



Voltage Drive 1G FastJacks™

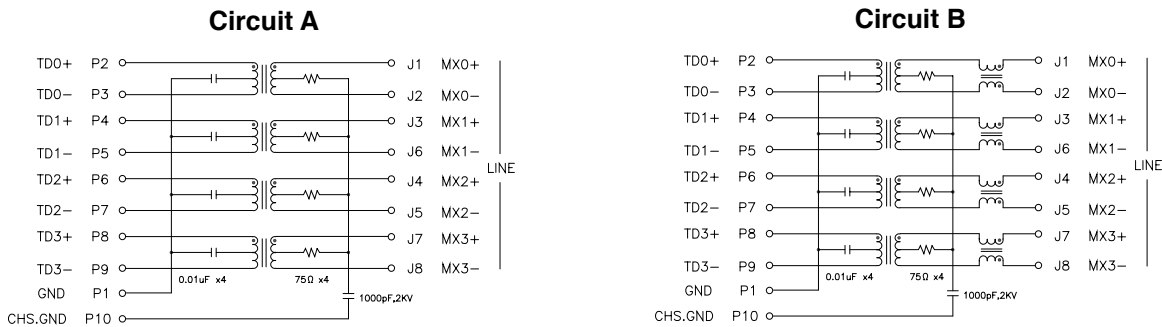

Electrical Specifications @ 25°C

Operating Temp:	0 to +70°C
Isolation Voltage:	1,500Vrms
Turns Ratio:	1CT:1CT +/-2%
OCL (100KHz, 0.1Vrms, 8mA)	350µH min
Insertion Loss (0.1-100MHz)	-1.1dB Max
CMR (0.1-100MHz):	-40dB typ
Crosstalk (0.1-100MHz)	-[33-20log(F/100MHz)]dB typ

Circuit	Port Count		
	Single	1x2	1x4
A	HFJ11-1G40ERL	HFJ12-1G40ERL	HFJ14-1G40ERL
B	HFJ11-1G41ERL	HFJ12-1G41ERL	HFJ14-1G41ERL

Optional LED's are available for single and ganged FastJacks™. Please consult the [LED option page](#) for color selection and part number codes.

Please refer to the individual data sheets for more information



Single Port

Mechanical Drawing

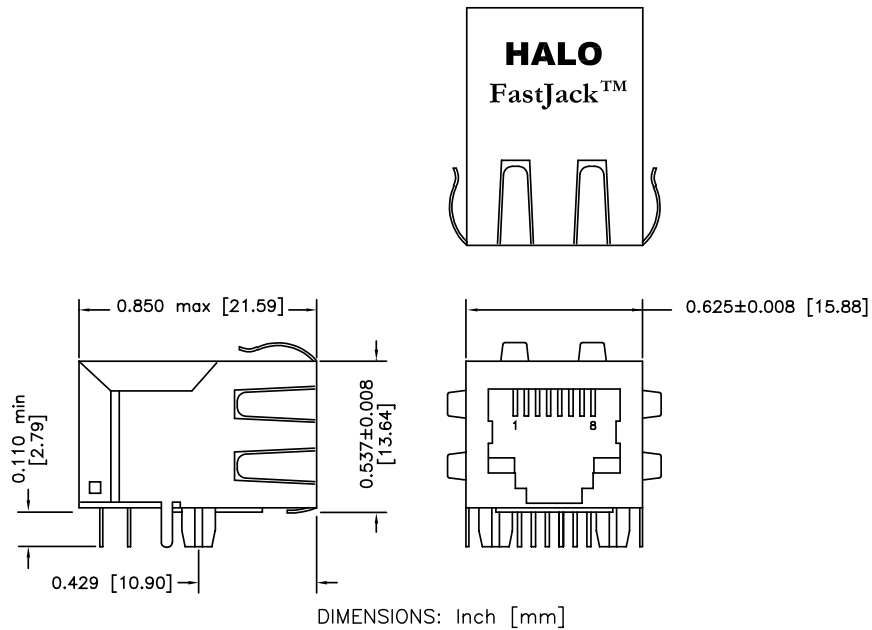

Recommended Panel Cutout

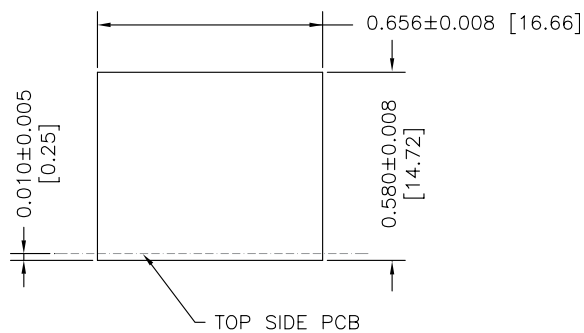

Recommended PC Layout

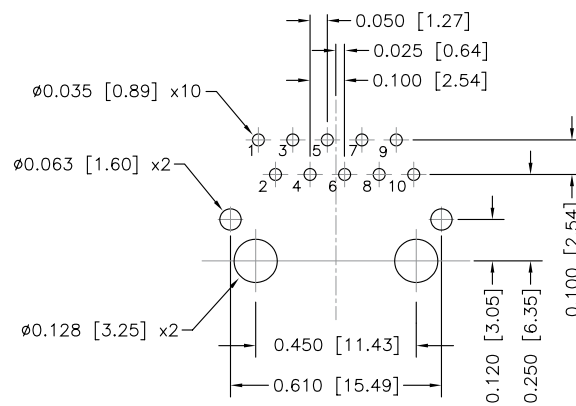



Double Port

Mechanical Drawing

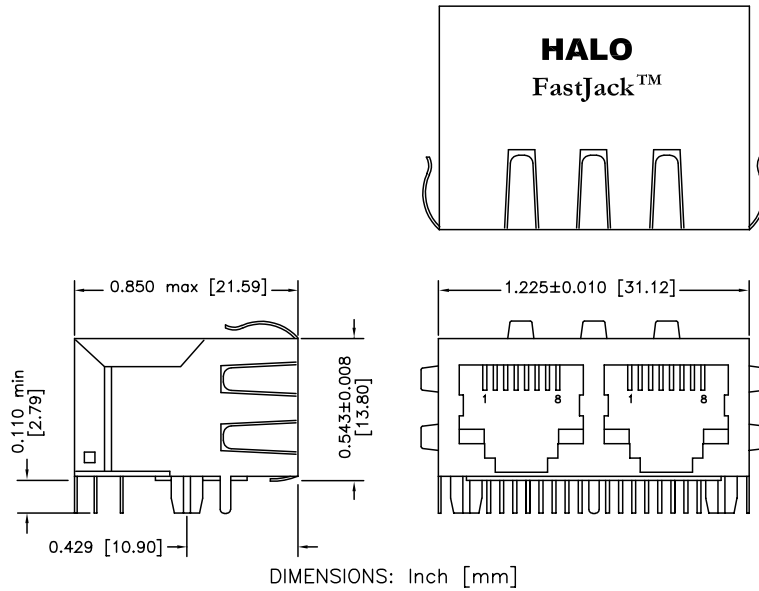

Recommended Panel Cutout

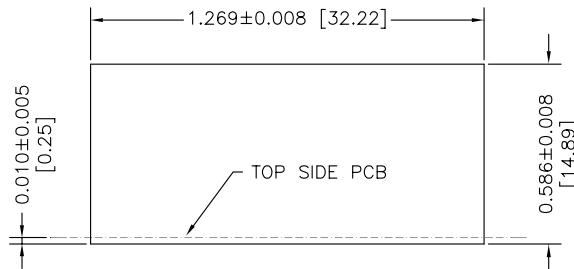

Recommended PC Layout

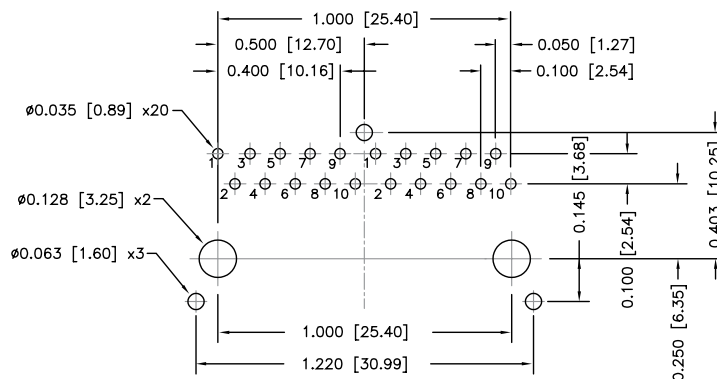



Quad Port

Mechanical Drawing

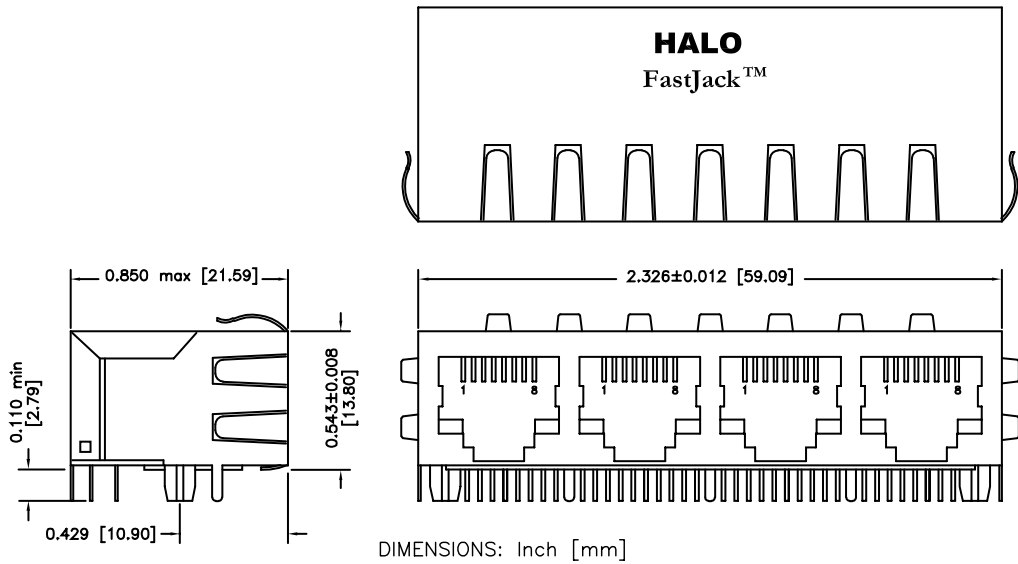

Recommended Panel Cutout

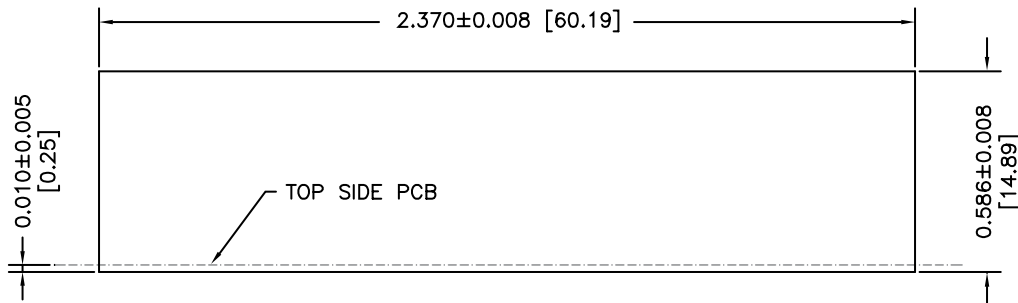

Recommended PCB Layout

