

DEPT	1
1	1
2	
3	
4	
5	
6	
7	
8	
9	
10	
11	
12	7
NC	
JZ	

PART NAME: MALE TERMINAL

PART NO: 3000M159

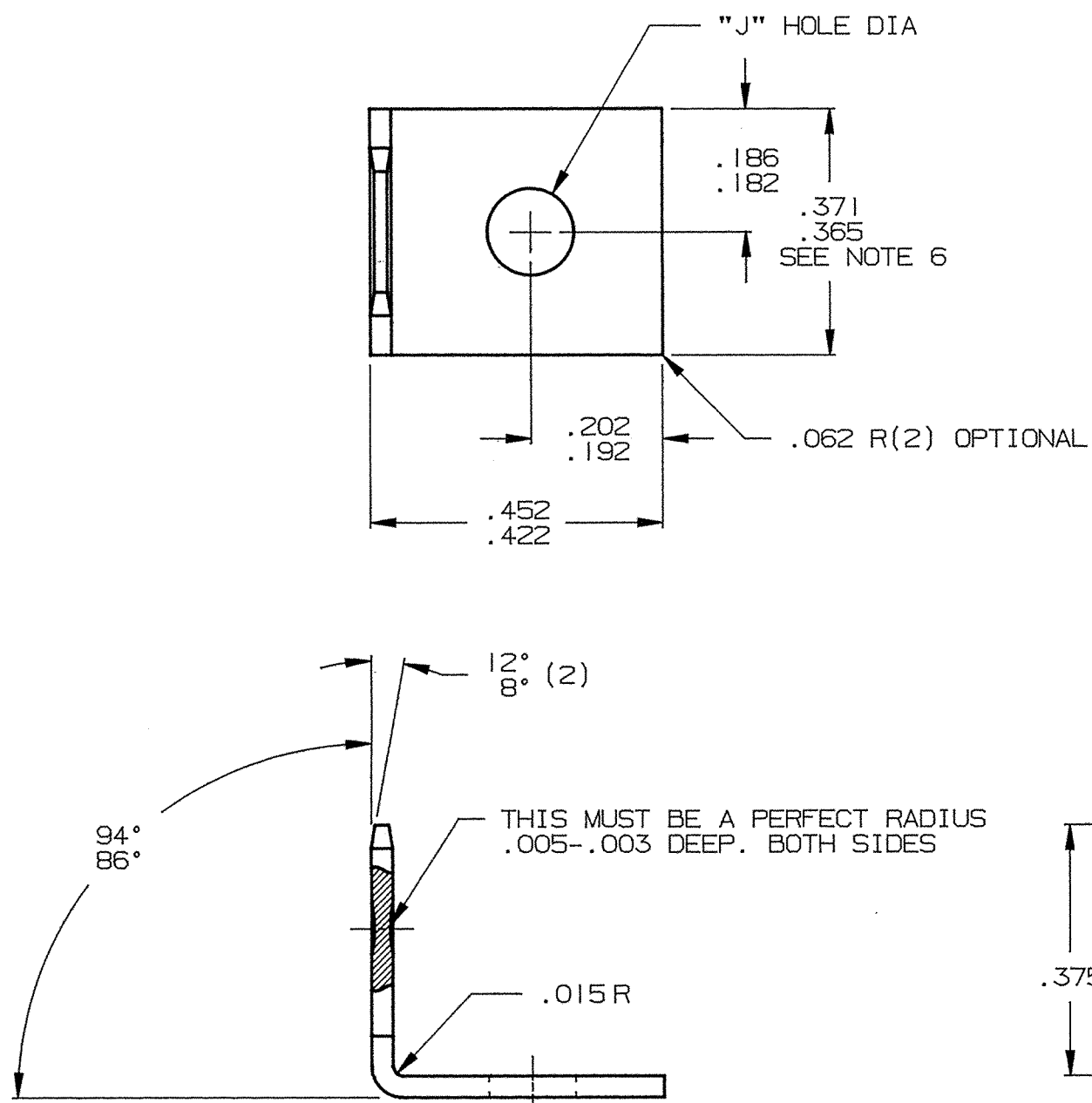

TYPE 1

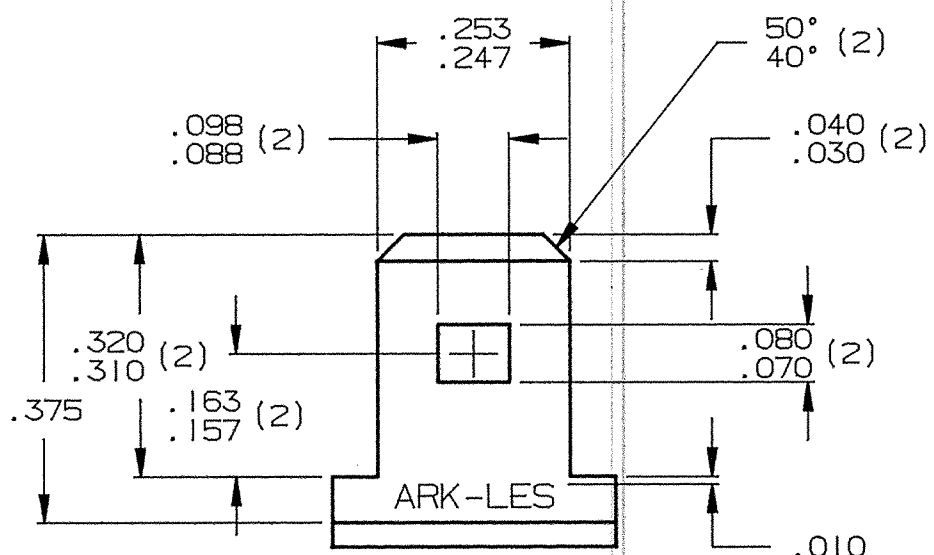

PART NUMBER	TYPE	MATERIAL	FINISH	"J" DIA
3000M159	1	.032 +/- .001 THICK BRASS C26000; 1/2 HARD R30T 56.5-68.0	NONE	.178/.172
3000M159-1	1		ELECTRO-TIN PCS 1002	.178/.172
3000M159-1A	1		NONE	.203/.199
3000M159A	1		NONE	.255/.250
3000M159B	2		NONE	.178/.172
3000M159C	2		NONE	.255/.250
3000M159C-2	2		SILVER PLATE PCS 1006	.255/.250
3000M159F	3		NONE	.178/.172
3000M159F-1	3		ELECTRO-TIN PCS 1002	.178/.172
3000M159F-2N	3		NICKEL PLATE PCS 1000	.178/.172
3000M159G	2		NONE	.143/.140
3000M159G-1	2		ELECTRO-TIN PCS 1002	.143/.140
3000M159K	3		NONE	.143/.140
3000M159K-1	3		ELECTRO-TIN PCS 1002	.143/.140
3000M159K-2	3		BRIGHT ACID TIN PCS 1015	.143/.140
3000M159N	2		ELECTRO-TIN PCS 1002	.178/.172
3000M159R	1		NONE	.226/.224
3000M159T	2		ELECTRO-TIN PCS 1002	.255/.250
3000M159T-1	2		ELECTRO-TIN PCS 1002	.203/.199
3000M159V	3		NONE	.255/.250
3000M159V-1	3	ZINC PLATE PCS 1009	.255/.250	
3000M159W	1	NONE	.098/.088	
3000M159Y	1	NONE	.143/.140	
3000M159Y-1	1	ELECTRO-TIN PCS 1002	.143/.140	
3000M159Y-2	1	BRIGHT ACID TIN PCS 1015	.143/.140	
3000M159Z	4	NONE	.202/.199	
3000M159Z-1	5	NONE	.202/.199	
3000M159Z-2	4	ELECTRO-TIN PCS 1004	.202/.199	

(T)

(U)

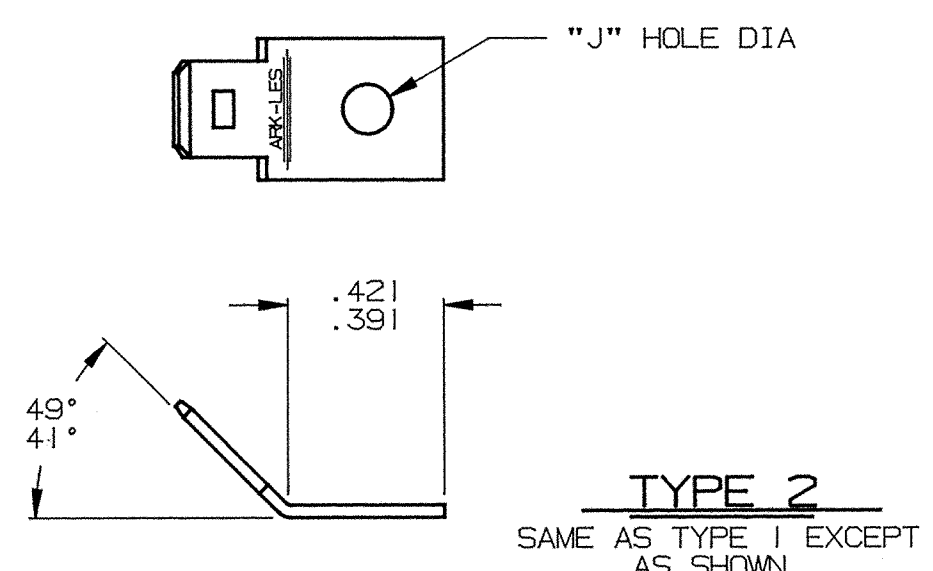

TYPE 2
SAME AS TYPE 1 EXCEPT AS SHOWN

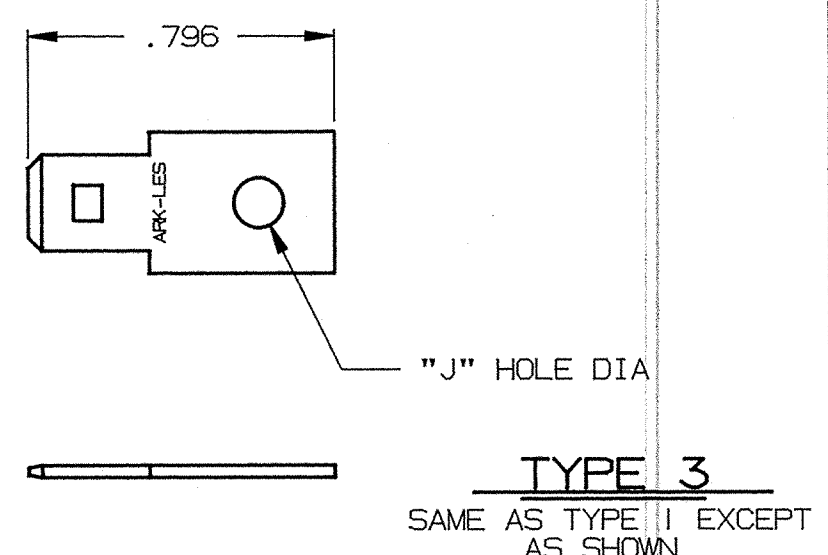

TYPE 3
SAME AS TYPE 1 EXCEPT AS SHOWN

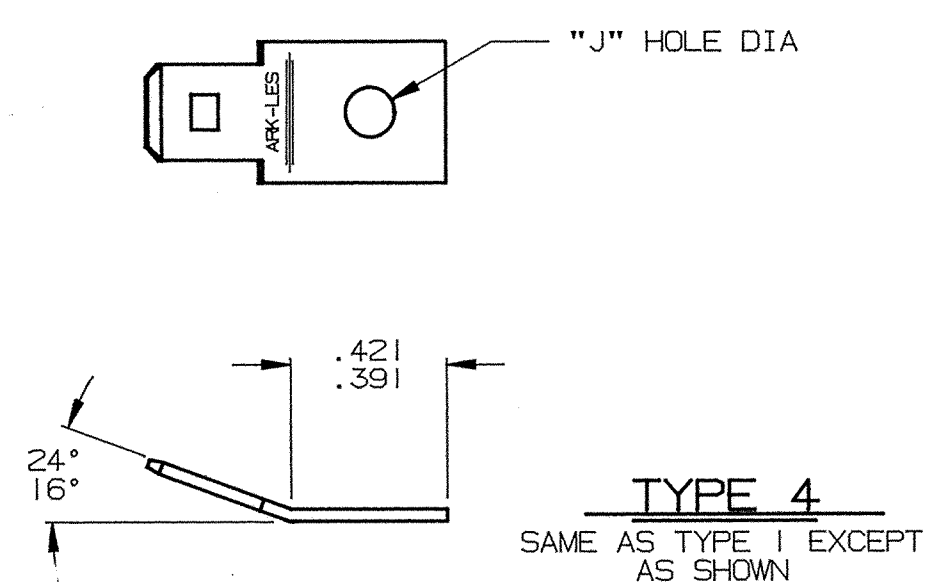

TYPE 4
SAME AS TYPE 1 EXCEPT AS SHOWN

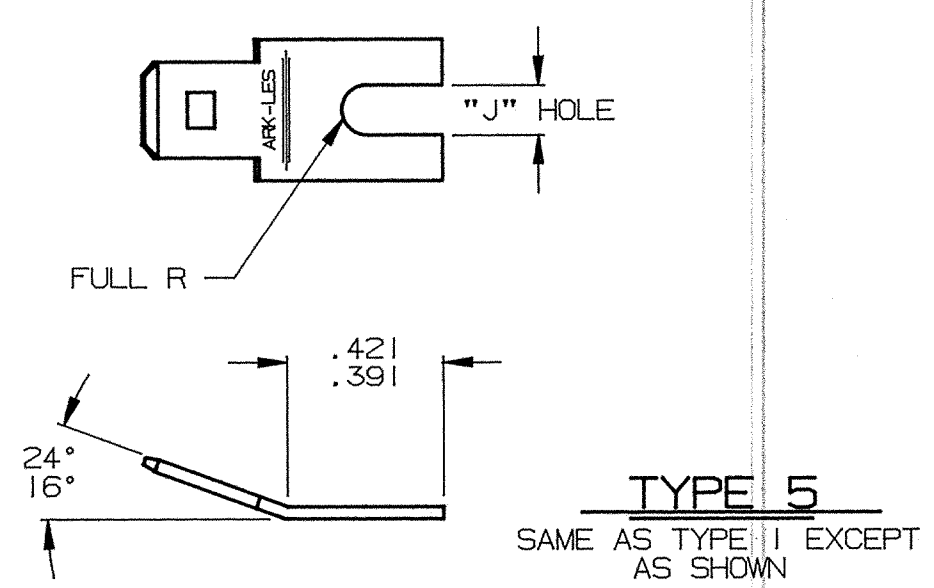

TYPE 5
SAME AS TYPE 1 EXCEPT AS SHOWN

- NOTES:
1. TO ACCEPT A .250 X .032 FEMALE RECEPTACLE.
 2. ALL PORTIONS OF TAB SHOWN SHALL BE FLAT AND FREE OF BURRS OR RAISED PLATEAUS, EXCEPT THAT THERE MAY BE, IN AN AREA .050 SURROUNDING THE DETENT, A RAISED PLATEAU OVER THE STOCK THICKNESS OF .001 PER SIDE.
 3. DETENT SHALL BE LOCATED WITHIN .005 OF THE TAB CENTERLINE.
 4. MALE TAB MUST CONFORM TO NEMA DC2 - 19XX.
 5. "ARK-LES" TO BE DIE STAMPED AS SHOWN.
 6. SWELLING AT BEND PERMISSIBLE. NO LIMITING DIMENSION REQUIRED.

ARK-LES UNCONTROLLED

U	REVISED PER ECR #10464	2/21/95	RT	CHK'D:	PROD. REL. PER TP 6/7/74 PC	TOLERANCES UNLESS OTHERWISE SPECIFIED:
T	3000M159Z-2 ADDED PER ECR #10287	8/31/94	RT	APP: COR 2/24/95	QUOTE REL.	DECIMALS ±.010 METRIC ±0.25mm ANGLES ±1°
S	REDRAWN WITHOUT CHANGE PER ECR #10168	5/11/94	BJC	SUPERCEDES DWG. DATED: 2/27/87	DR: C. O'REILLY 5/11/94	MATERIAL: SEE TABLE
REV.	DESCRIPTION	DATE	DR.	SCALE: 4:1	CAD NO: CTP0011	FINISH: SEE TABLE
						PART NO: 3000M159

ORIGINAL