



Solid State Devices, Inc.

14701 Firestone Blvd * La Mirada, Ca 90638
Phone: (562) 404-4474 * Fax: (562) 404-1773
ssdi@ssdi-power.com * www.ssdi-power.com

SPD9441

RADIATION DETECTOR PIN DIODE

Designer's Data Sheet

Part Number/Ordering Information ^{1/}

SPD9441 _ _

- L Screening ^{2/}
 - _ = Not Screened
 - TX = TX Level
 - TXV = TXV
 - S = S Level

Package Type

- _ = Axial Leaded
- SMS = Surface Mount Square Tab

- #### FEATURES:
- High Photocurrent Sensitivity
 - Linear Output > 4 Decades*
 - Fast Rise Time: <20 nsec
 - High Reliability Construction
 - Hardness to Neutron Bombardment
 - Tungsten Pins
 - Low Operating Voltage
 - Wide Dynamic Range
 - Effective Detector of Nuclear and Electromagnetic Radiation (i.e. Gamma Radiation, Electrons, and X-rays)
 - Not Restricted to Use at Low Temperatures; Temperature range of -65°C to +200°C
 - Replacement for UM9441
 - TX, TXV, and S-Level Screening Available ^{2/}

MAXIMUM RATINGS ^{3/}

RATING	SYMBOL	VALUE	UNIT
Peak Repetitive Reverse Voltage DC Blocking Voltage	V _R	100	Volts
Photocurrent	I _p	5	Amps
Operating & Storage Temperature	T _{OP} and T _{STG}	-65 to +200	°C

NOTES:

^{1/} For Ordering Information, Price, and Availability- Contact Factory.

^{2/} Screening Based on MIL-PRF-19500. Screening Flows Available on Request.

^{3/} Unless Otherwise Specified, All Electrical Characteristics @25°C.

Axial Leaded

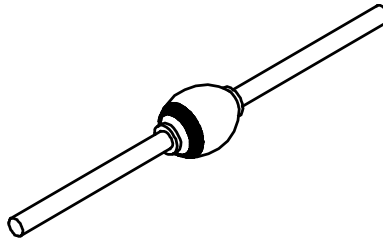

Surface Mount Square Tab

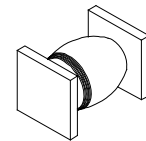

NOTE: All specifications are subject to change without notification. SCD's for these devices should be reviewed by SSDI prior to release.

DATA SHEET #: RC0130A

DOC



Solid State Devices, Inc.

14701 Firestone Blvd * La Mirada, Ca 90638
 Phone: (562) 404-4474 * Fax: (562) 404-1773
 ssdi@ssdi-power.com * www.ssdi-power.com

SPD9441

ELECTRICAL CHARACTERISTICS ^{3/}

CHARACTERISTICS	SYMBOL	MIN	TYP	MAX	UNIT
Photocurrent, Bias = 50V min 10 ⁶ (RAD(Si)/Sec) Gamma Radiation *Calc.	I_p*	4 4	6 6	-- --	nQ/(RAD(Si) mAdc
Capacitance (VR = 50V, f = 1MHz)	C_J	--	--	11	pF
Reverse Leakage Current (VR = 50Vdc)	I_R	--	--	200	nAdc
Breakdown Voltage (I _r = 100 μA)	BV_R	100	--	--	Vdc

AXIAL

DIMENSIONS

DIM	MIN	MAX
A	---	.200"
B*	---	.300"
C**	.037"	.041"
D	.75"	---

* .175" max special order available.
 ** .028/.032 special order available.

SMS

DIM	MIN	MAX
A	.195"	.200"
B	---	.350"
C	.019"	.027"
D	.002"	---

