

Male

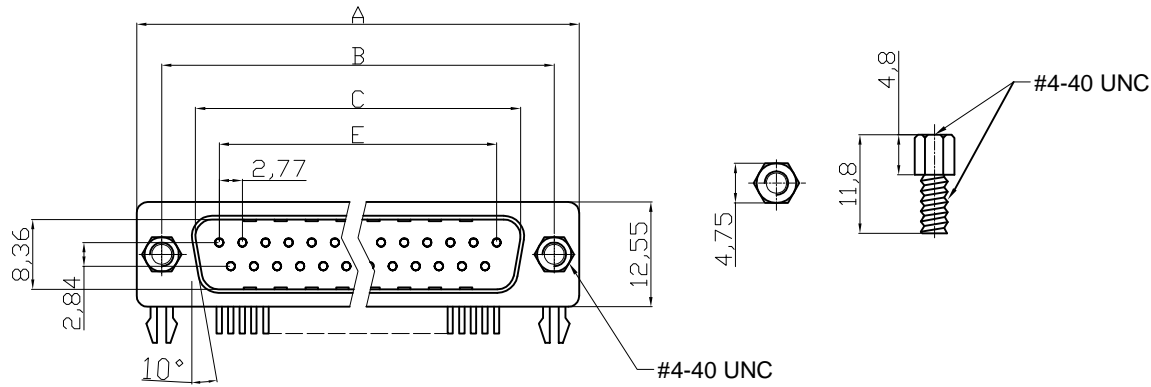

NOTES:

MATERIAL

- 1. Insulator Material: Glass-Filled Thermoplastic PBT ,UL 94V-0,Black
- 2. Contact Material : Brass
- 3. Contact plating : Gold flash full gold
- 4. Shell : Steel,100u" Tin over 50u" min copper
- 5. Clinch Nut : Copper alloy, Nickel plated
- 6. Boardlock : Brass , Tin plated
- 7. Screwlock : Steel, Nickel plated

ELECTRICAL

- 1. Current Rating : 3AMP
- 2. Voltage Rating : 250V AC/rms 60Hz
- 3. Contact Resistance : 20mΩ max at 1 AMP DC
- 4. Insulation Resistance: 1000MΩ at 500 V DC
- 5. Withstand Voltage : 1000V AC/rms 60Hz for 1 minute
- 6. Operating Temperature: -20°C~+85°C

UL No. E149426

Order Code:

A-Dx xx A/KG-xx * on request

Contact style: F - Female, S - Male
 No. of Contacts: 09 / 15 / 25 / 37

Version: T2 - with locking bolts UNC (Gold flash full gold), T2S - with locking bolts UNC (Gold flash selective gold), T4 - without locking bolts *(Gold flash full gold), T4S - without locking bolts *(Gold flash selective gold)
 Standard: Quality class III

Recommended PCB Layout

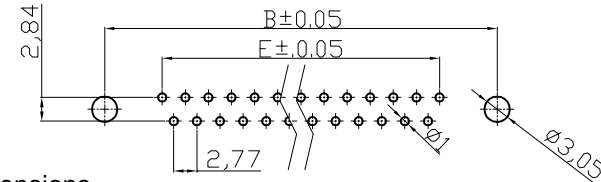

Dimensions

Positions	A	B	C	E
09	30.81	24.99	16.92	11.08
15	39.20	33.30	25.25	19.39
25	53.05	47.04	38.96	33.24
37	69.40	63.50	55.42	49.86

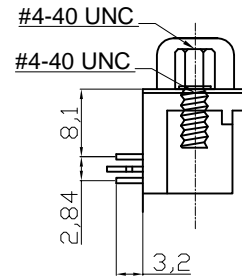
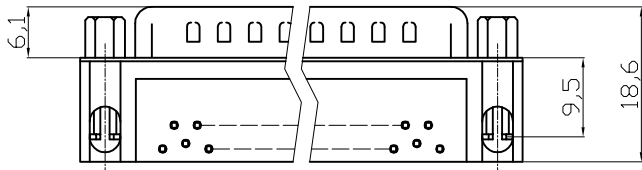

7.2mm Footprint

RoHS compliant

Unit: mm

Scale	Free					Date	Name	Customer-No.
TOLERANCE						Drawn	15.08.2012	Lucas
X.	±0.38					Approved	24.10.2012	Winnie
X.X	±0.25							
X.XX	±0.13							
DIM	TOL	①	Update	24.10.2012	Winnie			
X.°	±3°							
X.X°	±1.0°	②	Drawn	15.08.2012	Lucas			
Angle	TOL	Id.	Modification	Date	Name	Replace		Sheet 1/2

ASSMANN WSW-No.
A-Dx xx A/KG-T2/T2S/T4/T4S

Drawing-No.
ASS 4888 CO rev01

1

2

3

4

5

6

7

Female

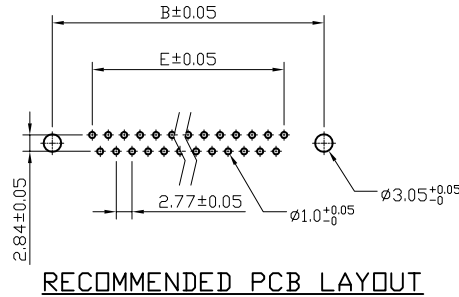
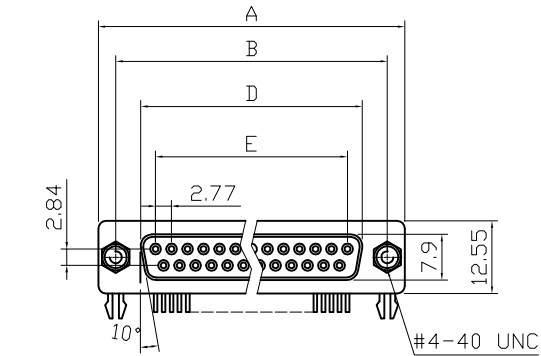

Product Specification

Material
 Insulator : Glass-Filled thermoplastic PBT UL94V-0 Black
 Contact : Copper alloy
 Contact Plating : Gold flash full gold

Shell : Steel, 100u" Tin over 50u" min copper
 Boardlock : Brass, Tin Plated
 Screwlock : Steel, Nickel Plated

Electrical

Contact Resistance : 20 milliohms Max at 1 AMP DC.
 Insulation Resistance : 1000 magohms at 500 VDC
 Dielectric Withstanding Voltage : 1000 VAC/rms 60Hz for 1 minute
 Current Rating : 3AMP
 Volatge Rating : 250 VAC/rms 60Hz
 OPERATING TEMPERATURE:-20°C+85°C
 UL No. E149426

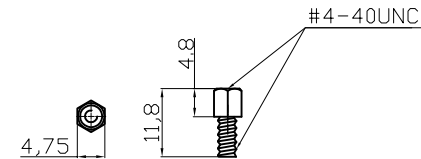
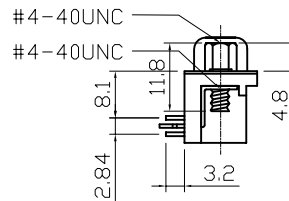
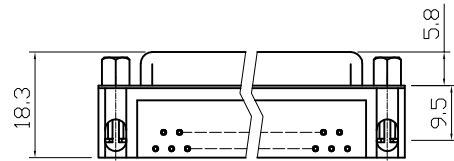

#4-40 unc screwlock installed

Dimensions

Positions	A	B	D	E
9	30.81	24.99	16.33	11.08
15	39.20	33.30	24.70	19.39
25	53.05	47.04	38.40	33.24
37	69.40	63.50	54.80	49.86

7.2mm Footprint

RoHS compliant

Unit: mm

Scale	Free					Date	Name	Customer-No.	
TOLERANCE						Drawn	15.08.2012	Lucas	
X.	±0.38					Approved	24.10.2012	Winnie	
X.X	±0.25							ASSMANN WSW-No. A-Dx xx A/KG-T2/T2S/T4/T4S	
X.XX	±0.13							Drawing-No.	
DIM	TOL	①	Update	24.10.2012	Winnie			ASS 4888 CO	rev01
X.°	±3°	②	Drawn	15.08.2012	Lucas			Replace	Sheet
X.X°	±1.0°							2/2	
Angle	TOL	Id.	Modification	Date	Name				