

1

2

3

4

5

6

7

A

A

B

B

C

C

D

D

E

E

F

F

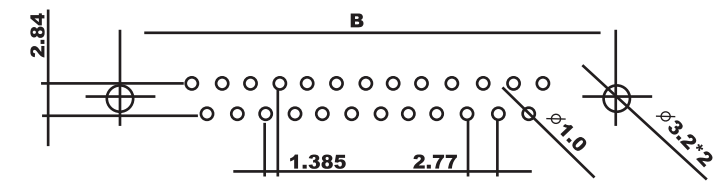
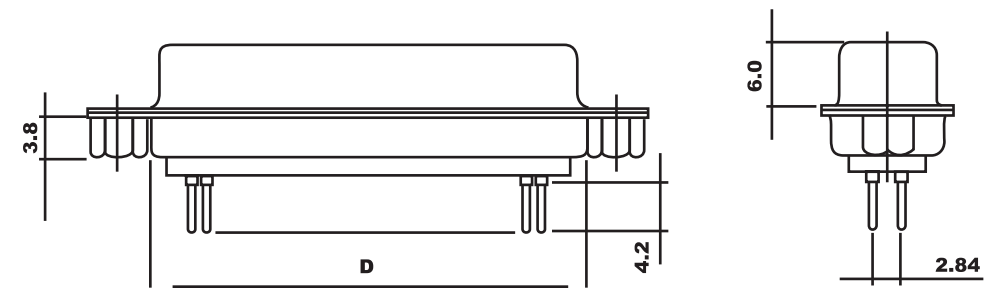
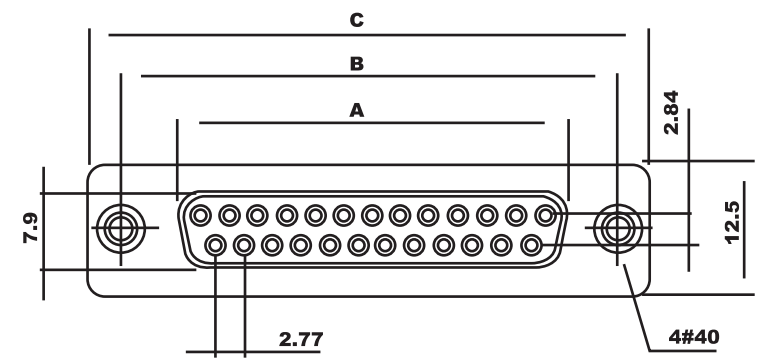

Recommended P.C.B. Layout (Top View)
Tolerances: +0.10mm

Position	A	B	C	D
9F	16.30	25.00	30.8	19.2
15F	24.60	33.30	39.2	27.7
25F	38.30	47.10	53.1	41.1
37F	54.80	63.50	69.4	57.3
50F	52.20	61.00	67.00	55.10

Specification:

Material:

Insulator: PBT, rated UL94V-0
Contacts: Brass
Shell: Steel
Rivet, Boardlock: Copper Alloy

Contact Plating:

Gold Flash over 50u"nickel

Electrical

Operation Voltage: 250 VAC max.
Current Rating: 3 Amps max.
Contact Resistance: 15 mohms max.
Insulation Resistance: 3000 Mohms min @ 500 VDC
Dielectric Withstanding Voltage: 1000 VAC/minute
Operating Temperature: -55°C to +105°C

Scale	1:1						Name
TOLERANCE						Drawn	11.16.11
X.X	±0.40					Approved	
X.XX	±0.25						
X.XXX	±0.15						
Angle	±3°						
		Modification	Date	Name			



Item No.	
A-DFxxPP-TAXM-B-R	
Title	
D-Sub Solder	
Drawing No.	
	rev00
Replace	Sheet

1

2

3

4

5

6

7

H

H