

RECOMMENDED PCB LAYOUT

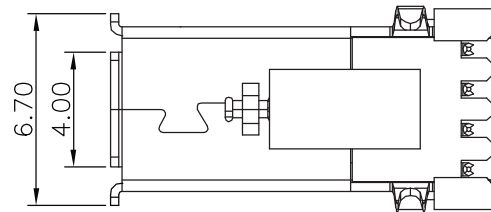

Material:

- Housing: PBT + 30% GF (UL 94V-0)
- Shell: Brass C2680-H T=0.3MM
- Terminal: Phosphor Bronze C5191-H T=0.25MM

Electrical:

- Voltage current rating: 1.0A 30V DC
- Insulation resistance: 1,000MΩ Min.
- Contact resistance terminal: 20MΩ Max.
- Withstanding voltage: 500V AC
- Mating force: 30N Max.
- Unmating force: 10N Min.

Unit: mm



Scale	1:1					Date	Name	Title USB1.1 Connector Side Entry for PCB mount, A Female type, 5μ"
TOLERANCE						Drawn	19.10.13	
X.	±0.40					Approved		
X.X	±0.25							ASSMANN WSW-No. A-USB-A-E/LP-R
X.XX	±0.15							Drawing-No.
DIM	TOL							
X.°	±3°							rev00
X.X°	±X°							
Angle	TOL	Id.	Modification	Date	Name			Replace



1840 W. Drake Drive, Suite 101 • Tempe, AZ 85283
Toll Free: 1-877-277-6266 • Email: info@assmann.us