

1

2

3

4

5

6

7

A

A

P.C.B. LAYOUT

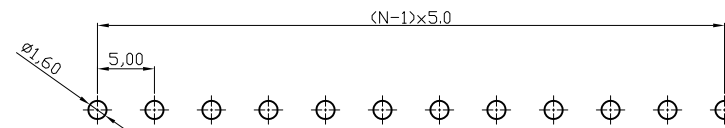

B

B

C

C

N = Number of contact

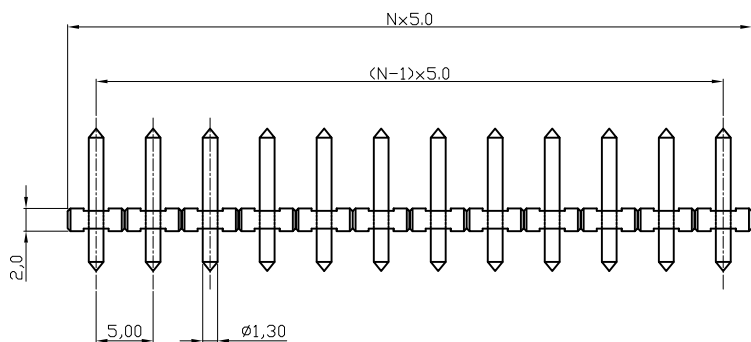

D

D

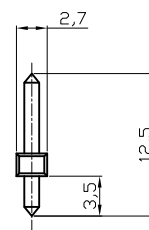

Material:

Solid PIN: Brass(CuZn)

Surface of solder tail: Tin plated

Insulator(housing): Thermoplastic (UL94V-0)

Electrical:

Voltage rating: UL 300V CSA 300V VDE 300V TUV 300V

Current rating: 10A 10A 12A 15A

Withstanding Voltage: 1.6KV 1.6KV 2.5KV 2.5KV

Operating temperature: -40°C to +115°C

Soldering temperature: 250°C±10°C/5 Sec

Safety Approval:    

E

E

F

F

RoHS compliant

Scale	1:1	Date	07.12.2006	Name	Hellwig	Customer-No.	
TOLERANCE		Drawn	07.12.2006	Hellwig	ASSMANN WSW-No.		
X.	±0.50	Approved	29.07.2009	Hellwig	A-TB500-OPxx		
X.X	±0.30	Update		29.07.2009	Dean	Drawing-No.	
X.XX	±0.10	Update technical date		28.07.2008	N.Schulz	ASS 1157 CO	
DIM	TOL	Drawn		07.12.2006	Hellwig	rev03	
X.°	±1°	Modification		Date	Name	Replace	
X.X°	±X°	Date		Date	Name	Sheet	
Angle	TOL	Date		Date	Name	Sheet	

H

H

1

2

3

4

5

6

7

SV1071