

1

2

3

4

5

6

7

A

A

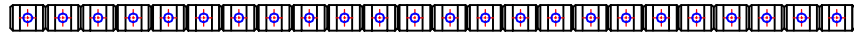

Material

Solid PIN: Brass(CuZn)
 Surface of solder tail: Tin plated.
 Insulator (housing): Thermoplastic (UL94V-0)

B

B

Electrical cULus

Voltage rating: 300V
 Current rating: 10A
 Withstanding Voltage: 1.6KV
 Operating temperature: -40°C to +115°C
 Soldering temperature: 250°C±10°C/5 Sec
 Safety Approval: US

C

C

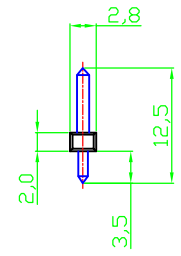
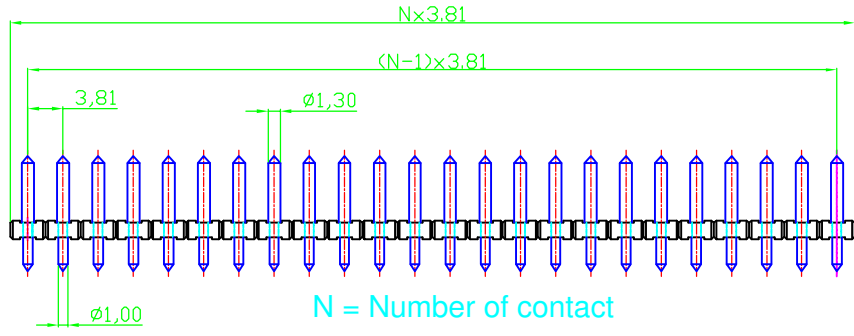

D

D

E

E

P.C.B. LAYOUT

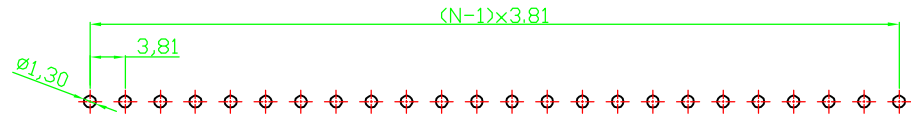

F

F

RoHS compliant

Scale	1:1					Date	Name	Customer-No.		
TOLERANCE					Drawn	29.07.2009	Dean			
X.	±0.50				Approved	29.07.2009	Hellwig	ASSMANN WSW-No. A-TB381-OPxx		
X.X	±0.30									
X.XX	±0.10							Drawing-No.		
DIM	TOL							ASS 3597 CO	rev01	
X.°	±1°									
X.X°	±X°	①	Drawn	29.07.2009				Dean		
Angle	TOL	Id.	Modification	Date	Name	Replace	Sheet			

G

G

H

H

1

2

3

4

5

6

7

SV/xxx