

REV.	DATE	DESCRIPTION
NC	05/01/04	INITIAL RELEASE
A	06/09/06	REMOVE "BULKHEAD" FROM PART DESCRIPTION

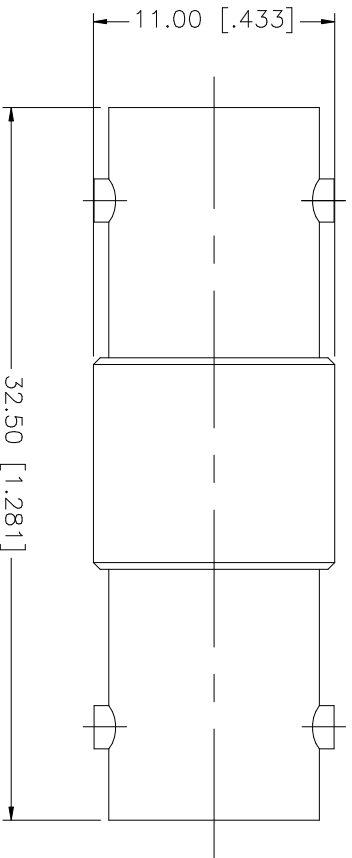

8						<p>UNLESS OTHERWISE SPECIFIED DIMENSIONS ARE IN INCHES AND FOR CUSTOMER REFERENCE ONLY.            TOLERANCES FOR MILLIMETERS ARE:            0.3 - 8mm ± 0.20mm            8 - 30mm ± 0.40mm            30 - 120mm ± 0.50mm</p> <p>UNLESS OTHERWISE SPECIFIED DIMENSIONS FOR INCHES ARE:            .020 - .315 = ± 0.007"            .315 - 1.180 = ± 0.015"            1.180 - 4.724 = ± 0.020"</p> <p>DO NOT SCALE DRAWING</p>					
7					APPROVALS		DATE	<p><b>Amphenol Connex</b></p> <p>PART DESCRIPTION</p> <p>BNC FEMALE TO FEMALE ADAPTER</p>			
6					DRAWN		G.R.S.				06/09/06
5					CHECKED						
4					ISSUED				PART NO.	112445	
3	CONTACT PIN	PHOS. BRONZE	GOLD	1					DWG. NO.	112445.DWG	
2	INSULATOR	DELRIIN	NATURAL	1					REV.	A	
1	BODY	BRASS	NICKEL	1					SIZE	A	
	DESCRIPTION	MATERIAL	FINISH	QTY	CAD FILE	C:/112/112445.DWG		SCALE	NA		