

| REV. | DATE | DESCRIPTION |
|------|----------|-------------------------------------|
| A | 05/17/04 | UPDATE BODY / UPDATE DRAWING FORMAT |

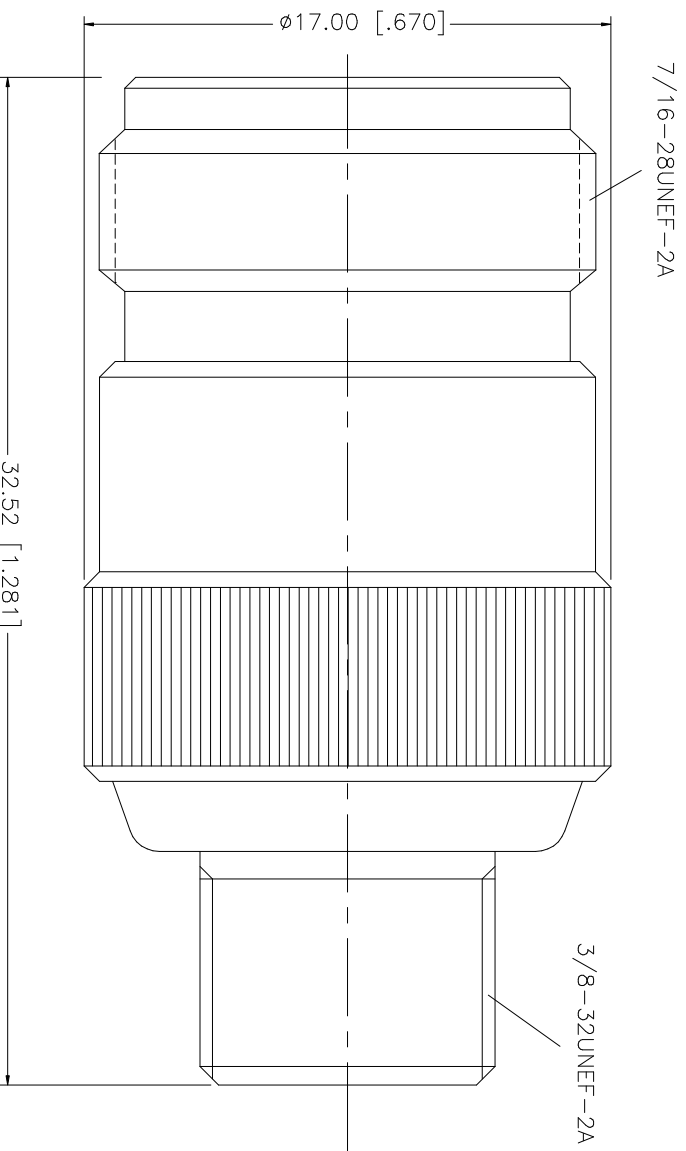

| QTY | FINISH | MATERIAL | DESCRIPTION |
|-----|---------|--------------|-------------|
| 1 | NICKEL | BRASS | BODY |
| 1 | NATURAL | TEFLON | INSULATOR |
| 1 | GOLD | PHOS. BRONZE | CONTACT PIN |

| |
|--|
| UNLESS OTHERWISE SPECIFIED DIMENSIONS ARE IN MILLIMETERS. DIMENSIONS IN [] ARE IN INCHES AND FOR CUSTOMER REFERENCE ONLY. |
| UNLESS OTHERWISE SPECIFIED TOLERANCES FOR MILLIMETERS ARE: |
| 0.5 - 8mm ± 0.20mm |
| 8 - 30mm ± 0.40mm |
| 30 - 120mm ± 0.50mm |
| UNLESS OTHERWISE SPECIFIED TOLERANCES FOR INCHES ARE: |
| .020 - .315 = ± 0.007" |
| .315 - 1.180 = ± 0.015" |
| 1.180 - 4.724 = ± 0.020" |
| DO NOT SCALE DRAWING |

| APPROVALS | DATE |
|--------------|----------|
| DRAWN G.R.S. | 05/17/04 |
| CHECKED | |
| ISSUED | |
| SHEET 1 OF 1 | |

| | | | | |
|----------------------------|---------------------|--------|--------|----------|
| CAD FILE C:/242/242120.DWG | DWG. NO. 242120.DWG | REV. A | SIZE A | SCALE NA |
|----------------------------|---------------------|--------|--------|----------|

Amphenol Connex

PART DESCRIPTION
N FEMALE TO F FEMALE ADAPTER
PART NO. 242120