

| REV. | DATE | DESCRIPTION |
|------|----------|----------------------------|
| A | 12/14/00 | MODIFY MOUNTING LEGS |
| B | 01/05/03 | MODIFY MOUNTING LEGS |
| C | 08/25/04 | ADD RECOMMENDED PCB LAYOUT |

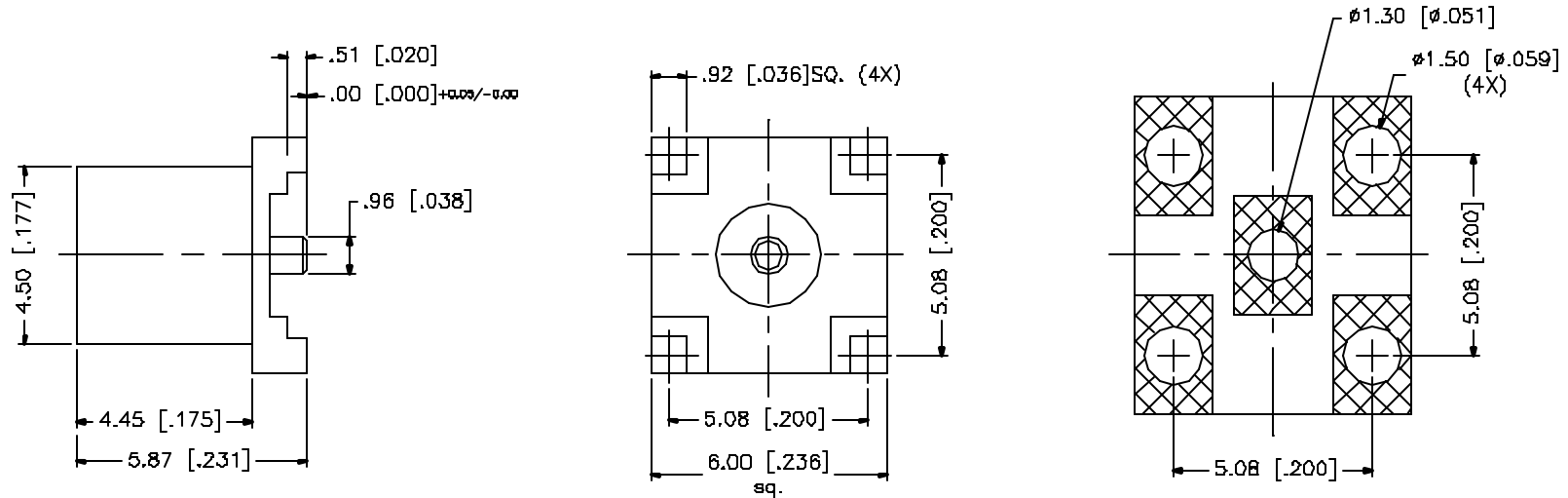

| | | | | | | | | | | | | |
|---|--------------|-------------|---------|-----|--|-----------|-------------------|---|--|-----------------|--|----------|
| 8 | | | | | <p>UNLESS OTHERWISE SPECIFIED DIMENSIONS ARE IN MILLIMETERS. DIMENSIONS IN [] ARE IN INCHES AND PER CUSTOMER PREFERENCE ONLY.</p> <p>UNLESS OTHERWISE SPECIFIED TOLERANCES FOR MILLIMETERS ARE: D - 8mm ± 0.20mm B - 30mm ± 0.40mm 30 - 120mm ± 0.50mm</p> <p>UNLESS OTHERWISE SPECIFIED TOLERANCES FOR INCHES ARE: .020 - .315 = ± 0.007" .315 - 1.180 = ± 0.015" 1.180 - 4.724 = ± 0.020"</p> | APPROVALS | DATE | <h1 style="color: blue; text-align: center;">Amphenol Connex</h1> | | | | |
| 7 | | | | | | DRAWN | G.R.S. | | | | | 08/25/04 |
| 6 | | | | | | CHECKED | | | PART DESCRIPTION MCX P.C. BOARD RECEPT. JACK (SURFACE MOUNT - 50ohms) | | | |
| 5 | | | | | | ISSUED | | | | | | |
| 4 | | | | | | | | | PART NO. 252117 | | | |
| 3 | INSULATOR | TEFLON | NATURAL | 1 | | | | | | | | |
| 2 | CONTACT PIN | BER. COPPER | GOLD | 1 | | | | | DWG. NO. 252117.DWG | | | |
| 1 | HOUSING/BODY | BRASS | GOLD | 1 | | SHEET | 1 OF 1 | | | | | |
| | DESCRIPTION | MATERIAL | FINISH | QTY | CAD FILE | | C:/252/252117.DWG | REV. C | SIZE A | SCALE NA | | |
| | | | | | DD NOT SCALE DRAWING | | | | | | | |