

| REV. | DATE | DESCRIPTION |
|------|----------|---|
| NC | 10/01/97 | INITIAL RELEASE |
| NC | 04/19/07 | REVISE PLATING TO NEXCOTE / UPDATE DRAWING FORMAT |

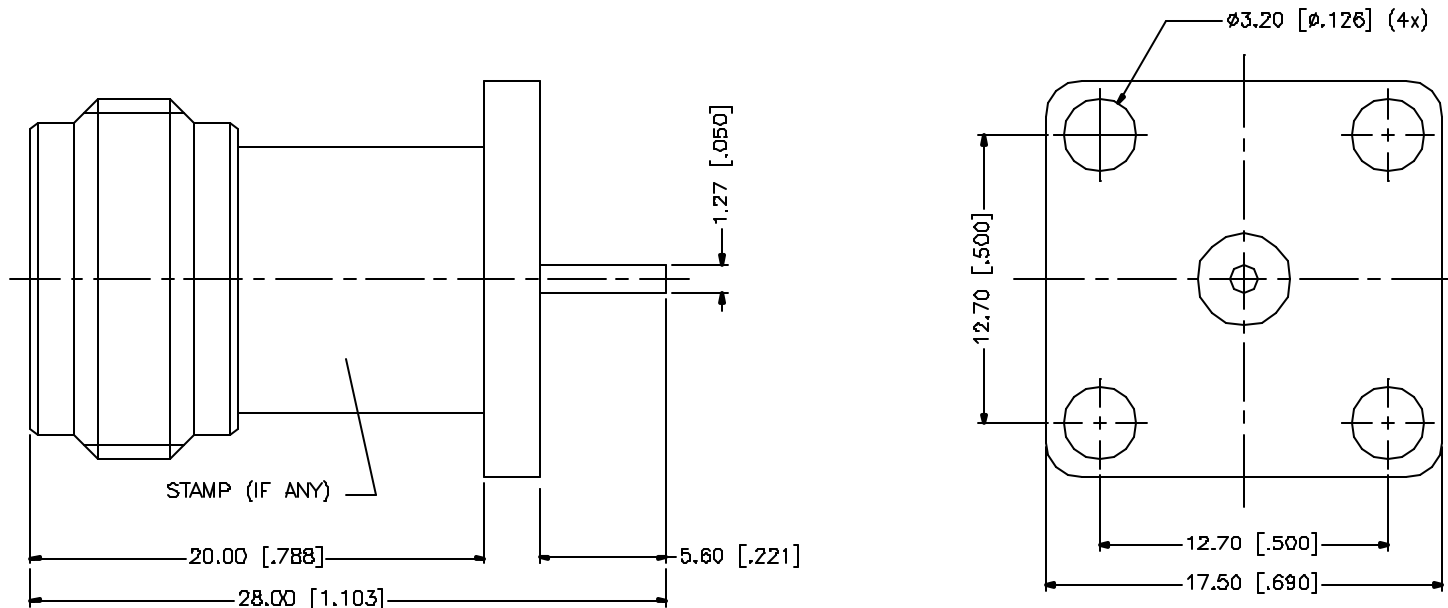

| | | | | UNLESS OTHERWISE SPECIFIED DIMENSIONS ARE IN MILLIMETERS. DIMENSIONS IN [] ARE IN INCHES AND FOR CUSTOMER REFERENCE ONLY. | APPROVALS | DATE | Amphenol Connex | | | | |
|-------------|-------------|--------------|---------|--|-----------|--------|------------------------|-------------------------------|--------|----------|--|
| 8 | | | | | DRAWN | G.R.S. | | | | 04/19/07 | PART DESCRIPTION N PANEL RECEPTACLE JACK / EXTENDED BODY |
| 7 | | | | | CHECKED | | | PART NO. 172190 | | | |
| 6 | | | | | ISSUED | | | | | | DWG. NO. 172190.DWG |
| 5 | | | | | SHEET | 1 OF 1 | | REV. A | SIZE A | SCALE NA | |
| 4 | | | | | | | | | | | |
| 3 | CONTACT PIN | PHOS. BRONZE | GOLD | 1 | | | | | | | |
| 2 | INSULATOR | TEFLON | NATURAL | 1 | | | | | | | |
| 1 | BODY | BRASS | NEXCOTE | 1 | | | | | | | |
| DESCRIPTION | | | | MATERIAL | FINISH | QTY | DO NOT SCALE DRAWING | | | | |
| | | | | UNLESS OTHERWISE SPECIFIED TOLERANCES FOR MILLIMETERS ARE: 0.5 - 8mm ± 0.20mm 8 - 30mm ± 0.40mm 30 - 120mm ± 0.50mm UNLESS OTHERWISE SPECIFIED TOLERANCES FOR INCHES ARE: .020 - .315 = ± 0.007" .315 - 1.180 = ± 0.015" 1.180 - 4.724 = ± 0.020" | | | | GAD FILE C:/172/172190.DWG | | | |