

| REV. | DATE     | DESCRIPTION                 |
|------|----------|-----------------------------|
| NC   | 09/18/96 | INITIAL RELEASE             |
| A    | 07/27/97 | UPDATE CONTACT PIN MATERIAL |
| B    | 11/07/05 | UPDATE DRAWING FORMAT       |

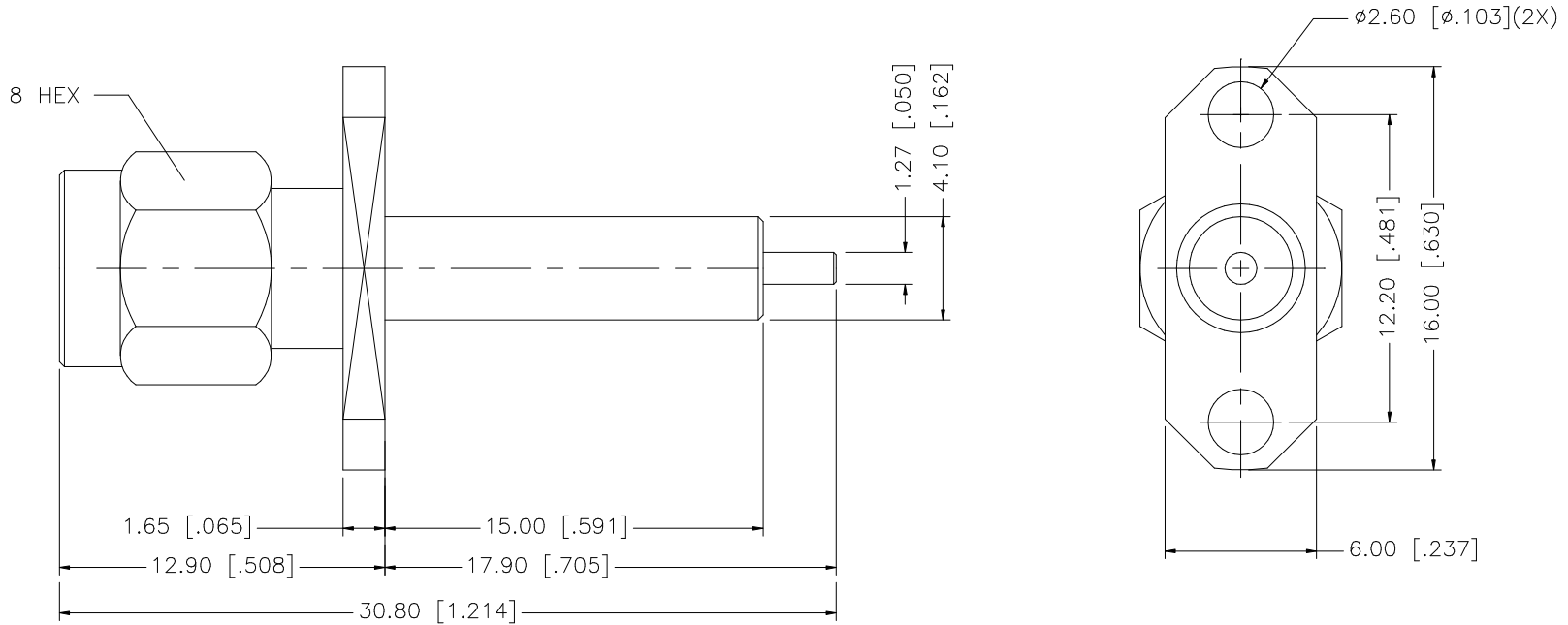

|   |             |          |         |     |
|---|-------------|----------|---------|-----|
| 8 |             |          |         |     |
| 7 |             |          |         |     |
| 6 |             |          |         |     |
| 5 |             |          |         |     |
| 4 |             |          |         |     |
| 3 | CONTACT PIN | BRASS    | GOLD    | 1   |
| 2 | INSULATOR   | TEFLON   | NATURAL | 1   |
| 1 | BODY        | BRASS    | GOLD    | 1   |
|   | DESCRIPTION | MATERIAL | FINISH  | QTY |

UNLESS OTHERWISE SPECIFIED DIMENSIONS ARE IN MILLIMETERS. DIMENSIONS IN [ ] ARE IN INCHES AND FOR CUSTOMER REFERENCE ONLY.

UNLESS OTHERWISE SPECIFIED TOLERANCES FOR MILLIMETERS ARE:  
0.5 - 8mm ± 0.20mm  
8 - 30mm ± 0.40mm  
30 - 120mm ± 0.50mm

UNLESS OTHERWISE SPECIFIED TOLERANCES FOR INCHES ARE:  
.020 - .315 = ± 0.007"  
.315 - 1.180 = ± 0.015"  
1.180 - 4.724 = ± 0.020"

DO NOT SCALE DRAWING

| APPROVALS |                   | DATE     |
|-----------|-------------------|----------|
| DRAWN     | G.R.S.            | 11/07/05 |
| CHECKED   |                   |          |
| ISSUED    |                   |          |
| SHEET     | 1 OF 1            |          |
| CAD FILE  | C:/132/132145.DWG |          |

**Amphenol Connex**

PART DESCRIPTION  
**SMA TWO HOLE PLUG  
(.591" - .705")**

PART NO.  
**132145**

DWG. NO. 132145.DWG    REV. B    SIZE A    SCALE NA