

REV.	DATE	DESCRIPTION
A	06/05/03	UPDATE DRAWING FORMAT

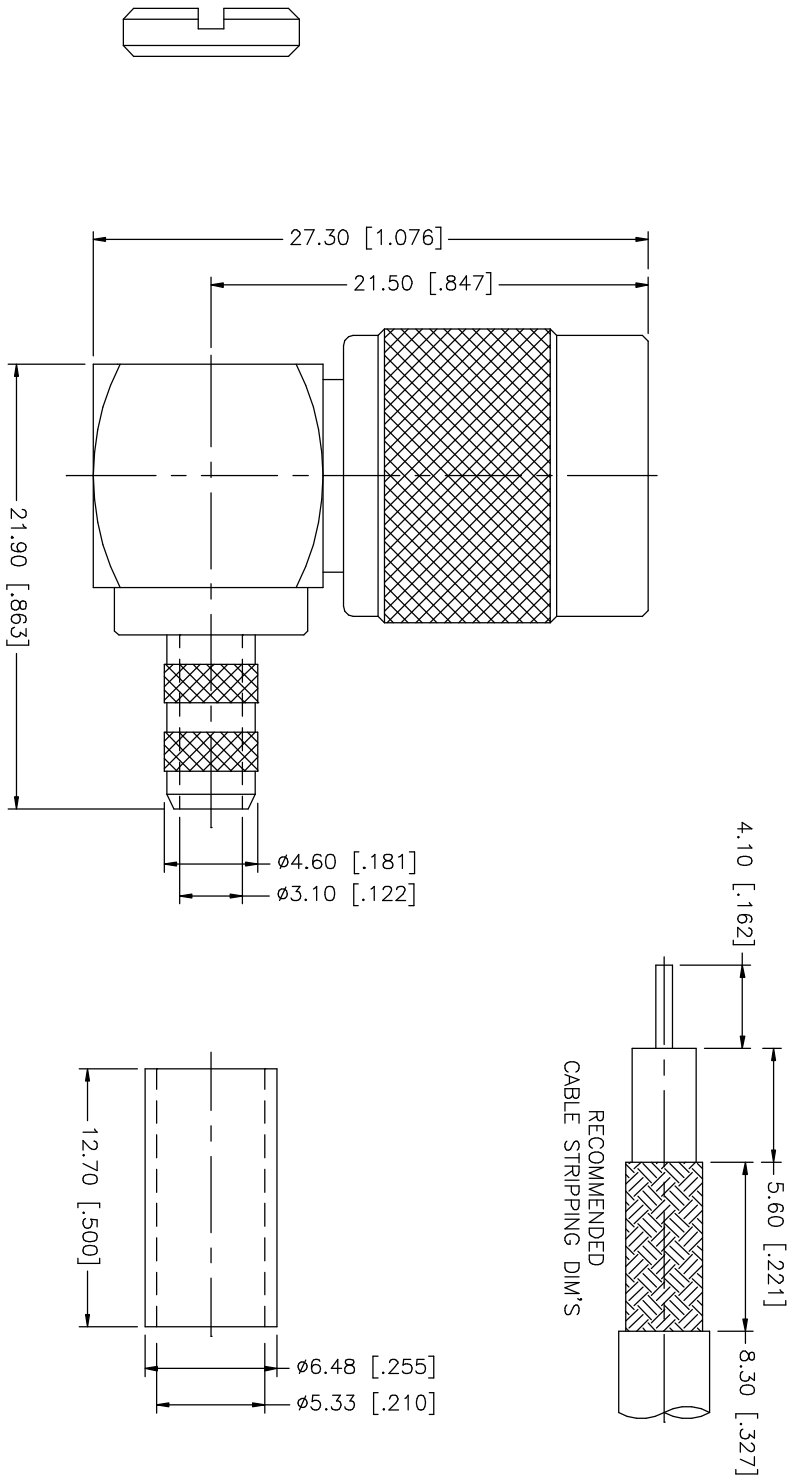

REV.	DATE	DESCRIPTION
8		
7		
6		
5		
4		
3		
2		
1		

DESCRIPTION	MATERIAL	FINISH	QTY
1	BRASS	NICKEL	1
2	INSULATOR	DELIRIN	1
3	CONTACT PIN	BRASS	1
4	FERRULE	COPPER	1
5	NUT	BRASS	1
6			
7			
8			

UNLESS OTHERWISE SPECIFIED DIMENSIONS ARE IN INCHES AND FOR CUSTOMER REFERENCE ONLY.	UNLESS OTHERWISE SPECIFIED DIMENSIONS ARE IN MILLIMETERS AND TOLERANCES FOR MILLIMETERS ARE:
0.5 - 8mm ± 0.20mm	8 - 30mm ± 0.40mm
30 - 120mm ± 0.50mm	
UNLESS OTHERWISE SPECIFIED DIMENSIONS FOR INCHES ARE:	
.020 - .315 = ± 0.007"	.315 - 1.180 = ± 0.015"
1.180 - 4.724 = ± 0.020"	

APPROVALS	DATE
DRAWN G.R.S.	06/05/03
CHECKED	
ISSUED	
SHEET 1 OF 1	

CAD FILE	DWG. NO.	REV.	SIZE	SCALE
C:/122/122140.DWG	122140.DWG	A	A	NA

Amphenol Connex

PART DESCRIPTION
TNC R/A CRIMP PLUG
(FOR RG-58/u, 58C/u, 141/u CABLE)

PART NO. 122140