

NOTES:

1. MATERIALS AND FINISHES:
 FRONT BODY - BRASS, NICKEL PLATING (.000100 MIN THICK)
 REAR CUBE BODY - BRASS, MATTE TIN PLATING (.000100 MIN THICK)
 FEMALE CONTACT - BERYLLIUM COPPER, GOLD PLATING (.000030 MIN THICK)
 INSULATOR - PTFE
2. ELECTRICAL:
 A. IMPEDANCE: 75 OHM
 B. FREQUENCY RANGE: DC - 1 GHz
 C. VSWR(RETURN LOSS): 1.12 (25dB), MAX DC - 1.5GHz
 1.22 (20dB), MAX 1.5 - 3 GHz
 VSWR PERFORMANCE DEPENDANT UPON PCB LAUNCH CONFIGURATION
4. PACKAGING:
 A. QUANTITY: TRAY PACK
 B. MARKING: TRAY TO BE MARKED
 "AMPHENOL, 31-70352, AND DATE CODE"

THIRD ANGLE PROJ.

REVISIONS

REV	DESCRIPTION	DATE	ECO	APPR
A	RELEASE TO MFG.	11/9/07	46835	SH
B	ADD STAKING TWO PLACES/RD-DMI2050401J7	30-May-12	49112	SH

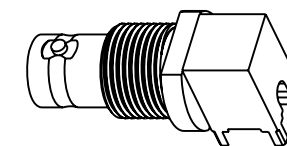

SCALE 1.000

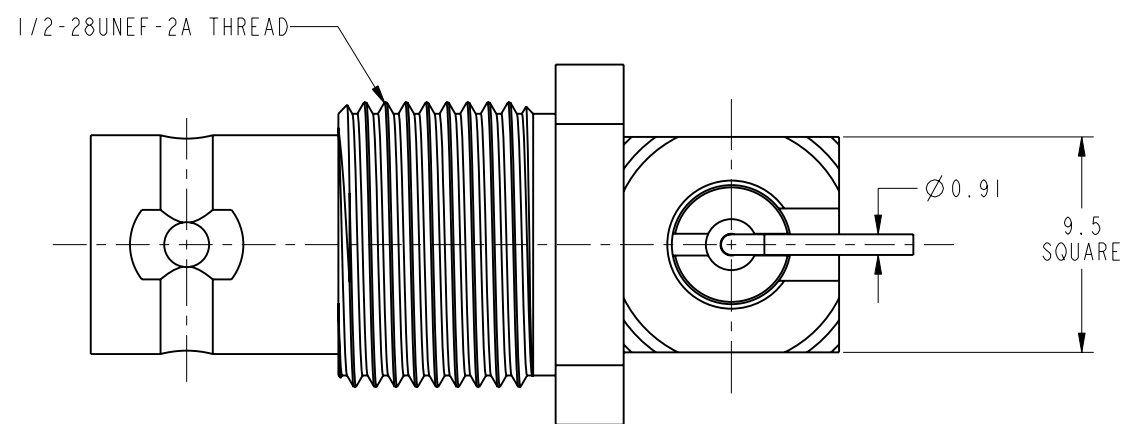
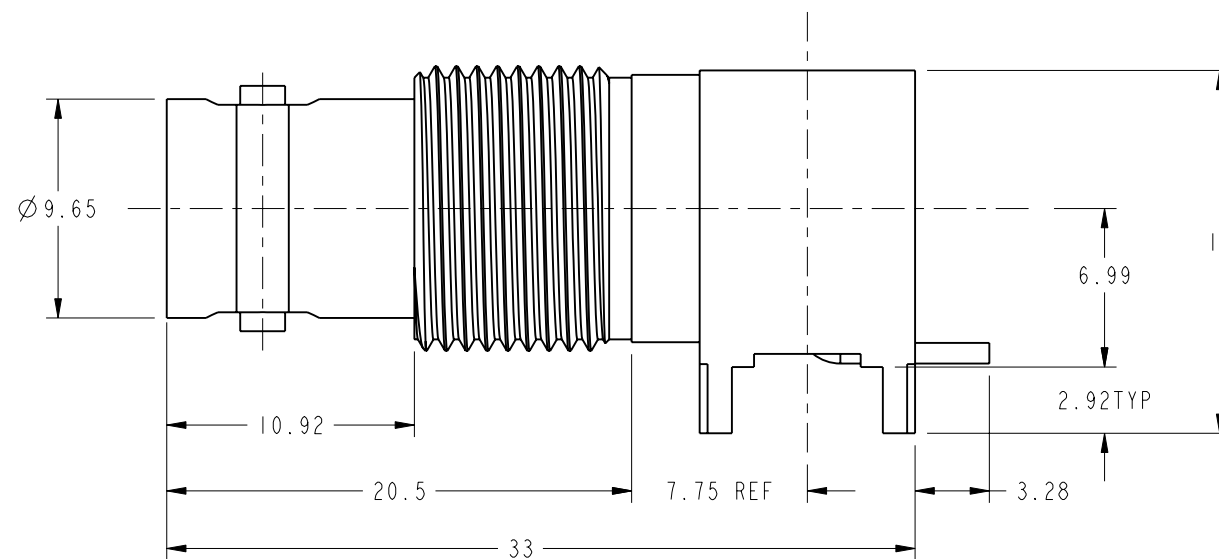
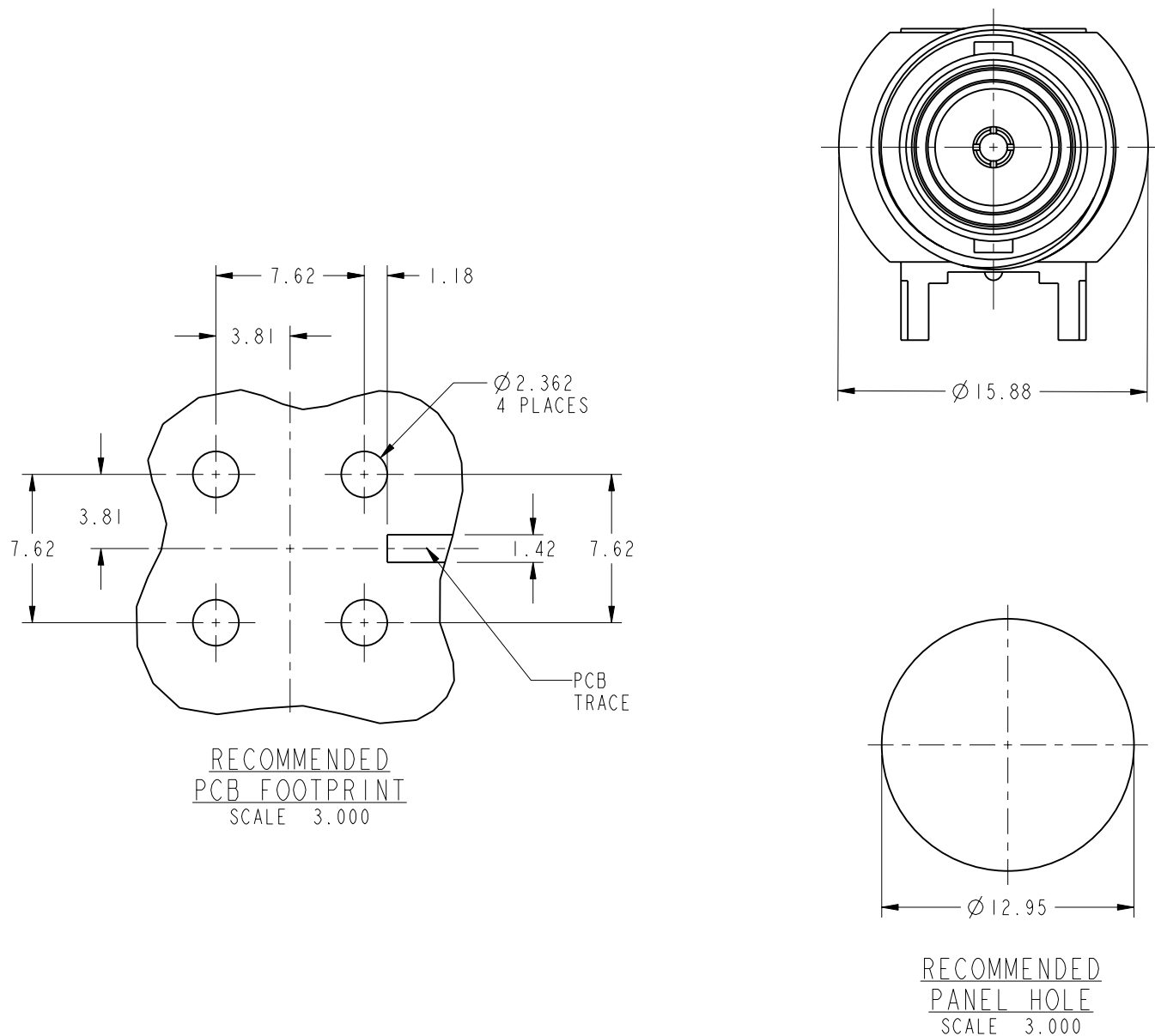

CUSTOMER OUTLINE DRAWING

ALL OTHER SHEETS ARE FOR INTERNAL USE ONLY

UNLESS OTHERWISE SPECIFIED, DIMENSIONS ARE IN METRIC AND TOLERANCES ARE:
 < 0.5mm ± 0.05mm 0.5 - 6mm ± 0.1mm 6 - 30mm ± 0.2mm 30 - 120mm ± 0.3mm ANGLES ± 1°

NOTICE - These drawings, specifications, or other data (1) are, and remain the property of Amphenol corp. (2) must be returned upon request; and (3) are confidential and not to be disclosed to any person other than those to whom they are given by Amphenol Corp. the furnishing of these drawings, specifications, or other data by Amphenol Corp., or to any other person to anyone for any purpose is not to be regarded by implication or otherwise in any manner licensing, granting rights to permitting such holder or any other person to manufacture, use or sell any product, process or design, patented or otherwise, that may in any way be related to or disclosed by said drawings, specifications, or other data.

MATERIAL	DRAWN J. SHAO	DATE 29-May-12	TITLE BNC R/A PCB JACK THRU LEG, SMT CONTACT BULKHEAD	Amphenol RF Danbury CT USA, Tainan, Taiwan, Shenzhen, China www.amphenolrf.com
REFERENCE *** AND ***	ENGINEER M. HOYACK	DATE 31-Oct-07		
TEKTRONIX PN: 131-8271-00	APPROVED S. HSIEH	DATE 29-May-12	SCALE: 3.0:1.0	DRAWING NO. 31-70352
FINISH	CAD FILE I:BNC/31-70352		SHEET 2 OF 2	ITEM NO. 31-70352
			DWG SIZE B	PART NO. 31-70352
			REV B	