



1.0mm Pin Header SMT (S/T) Type

MATERIAL

Insulator : High Temperature Polyester
Contact Pin : Brass

SPECIFICATION

Current Rate : 1 AMP
Insulation Resistance : 5000MΩMin. at DC 500V
Contact Resistance : 15mΩMax. at DC 100mA
Operation Temperature : -40°C to + 105°C



Detail Dimensions

250-97-xxGBxx

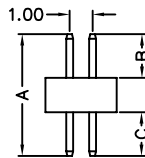
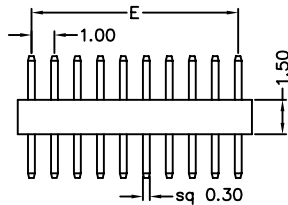
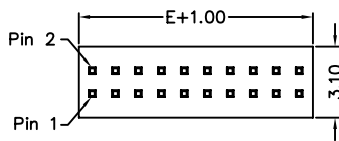

252-97-xxGBxx

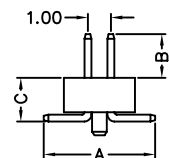
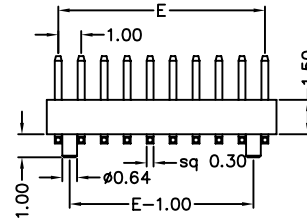
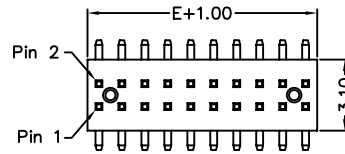

Recommended P.C.B Layout

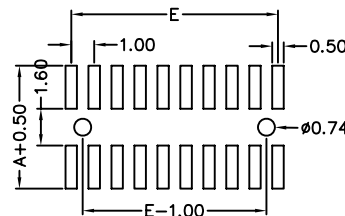
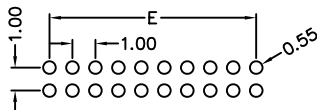

Order Information

25 x -97- xx G B xx
1 2 3 4

1. 0: S/T Type
2: SMT S/T Type
2. No. of contacts per row
3. G: Gold Flash
S: Selective Gold Plating
4. Pinrex internal code

If you need other dimensions,
please fill out DIM A/B/C and
contact our sales representatives.

DIM A	DIM B	DIM C

Number Of Contacts

Unit: mm

Poles	DIM E	Poles	DIM E	Poles	DIM E	Poles	DIM E	Poles	DIM E	Poles	DIM E	Poles	DIM E	Poles	DIM E
		8	7.00	15	14.00	22	21.00	29	28.00	36	35.00	43	42.00	50	49.00
3	2.00	9	8.00	16	15.00	23	22.00	30	29.00	37	36.00	44	43.00		
4	3.00	10	9.00	17	16.00	24	23.00	31	30.00	38	37.00	45	44.00		
5	4.00	11	10.00	18	17.00	25	24.00	32	31.00	39	38.00	46	45.00		
6	5.00	12	11.00	19	18.00	26	25.00	33	32.00	40	39.00	47	46.00		
7	6.00	13	12.00	20	19.00	27	26.00	34	33.00	41	40.00	48	47.00		
		14	13.00	21	20.00	28	27.00	35	34.00	42	41.00	49	48.00		