



1.27*1.27mm Pin Header SMT Straight Type

MATERIAL

Insulator : High Temperature Polyester
Contact Pin : Brass

SPECIFICATION

Current Rate : 1 AMP
Insulation Resistance : 5000MΩMin. at DC 500V
Contact Resistance : 20mΩMax. at DC 100mA
Operation Temperature : -40°C to + 105°C

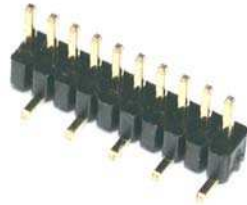

Detail Dimensions

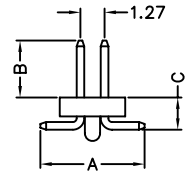
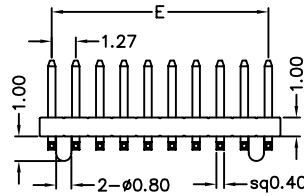
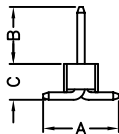
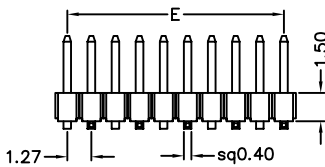
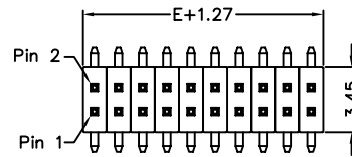
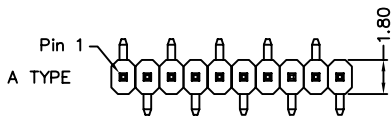
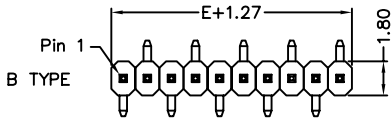

Recommended P.C.B Layout

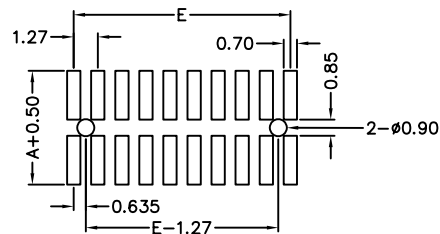
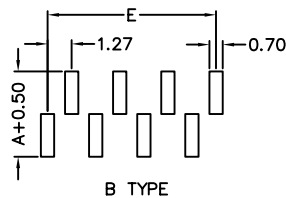
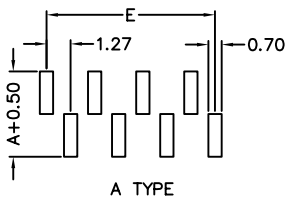

Order Information

232-9 x - xx G B xx
1 2 3 4

- 1. 1: Single row Plastic Height=1.0mm
- 2: Dual rows Plastic Height=1.0mm
- 6: Single row Plastic Height=1.5mm
- 7: Dual rows Plastic Height=1.5mm
- C: Single row Plastic Height=1.7mm
- B: Dual rows Plastic Height=2.5mm
- 2. No. of contacts per row

- 3. G: Gold Flash
- S: Selective Gold Plating
- 4. Pinrex internal code

If you need other dimensions, please fill out DIM A/B/C and contact our sales representatives.

DIM A	DIM B	DIM C

* Locating peg ONLY available for plastic height 1.0mm!

Number Of Contacts

Unit: mm

Poles	DIM E	Poles	DIM E	Poles	DIM E	Poles	DIM E	Poles	DIM E	Poles	DIM E	Poles	DIM E	Poles	DIM E
		8	8.89	15	17.78	22	26.67	29	35.56	36	44.45	43	53.34	50	62.23
2	1.27	9	10.16	16	19.05	23	27.94	30	36.83	37	45.72	44	54.61		
3	2.54	10	11.43	17	20.32	24	29.21	31	38.10	38	46.99	45	55.88		
4	3.81	11	12.70	18	21.59	25	30.48	32	39.37	39	48.26	46	57.15		
5	5.08	12	13.97	19	22.86	26	31.75	33	40.64	40	49.53	47	58.42		
6	6.35	13	15.24	20	24.13	27	33.02	34	41.91	41	50.80	48	59.69		
7	7.62	14	16.51	21	25.40	28	34.29	35	43.18	42	52.07	49	60.96		