



2.0mm Pin Header Straight Type

MATERIAL

Insulator : High Temperature Polyester
Contact Pin : Brass

SPECIFICATION

Current Rate : 1 AMP
Insulation Resistance : 5000MΩMin. at DC 500V
Contact Resistance : 20mΩMax. at DC 100mA
Operation Temperature : -55°C to + 105°C



Detail Dimensions

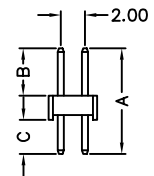
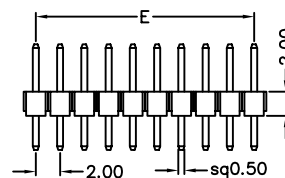
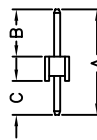
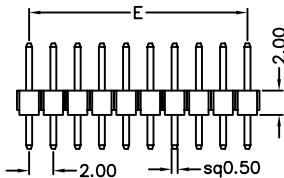
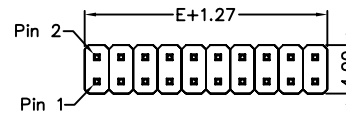
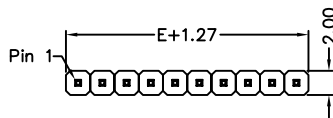

Recommended P.C.B Layout

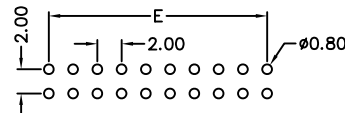
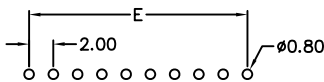

Order Information

220-x x - xx G B xx
1 2 3 4 5

- 7: Green Product
- 9: Green Product High Temp
- 1: Single row Plastic Height=1.5mm
- 2: Dual rows Plastic Height=1.5mm
- 6: Single row Plastic Height=2.0mm
- 7: Dual rows Plastic Height=2.0mm
3. No. of contacts per row
4. G: Gold Flash

4x30 ways available

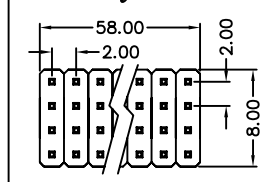

Standard Parts	DIM A	DIM B	DIM C
220-x1-xxGB01	8.20	3.90	2.80
220-x6-xxGB01	8.70	3.90	2.80
220-x2-xxGB01	8.20	3.90	2.80
220-x7-xxGB01	8.70	3.90	2.80

If you need other dimensions, please fill out DIM A/B/C and contact our sales representatives.

- S: Selective Gold Plating
T: Tin Plating
5. Pinrex internal code

DIM A	DIM B	DIM C

Number Of Contacts

Unit: mm

Poles	DIM E	Poles	DIM E	Poles	DIM E	Poles	DIM E	Poles	DIM E	Poles	DIM E	Poles	DIM E	Poles	DIM E
		8	14.00	15	28.00	22	42.00	29	56.00	36	70.00				
2	2.00	9	16.00	16	30.00	23	44.00	30	58.00	37	72.00				
3	4.00	10	18.00	17	32.00	24	46.00	31	60.00	38	74.00				
4	6.00	11	20.00	18	34.00	25	48.00	32	62.00	39	76.00				
5	8.00	12	22.00	19	36.00	26	50.00	33	64.00	40	78.00				
6	10.00	13	24.00	20	38.00	27	52.00	34	66.00						
7	12.00	14	26.00	21	40.00	28	54.00	35	68.00						