



1.27x2.54mm Box Header Straight (Elevated) Type

MATERIAL

Insulator : High Temperature Polyester
Contact Pin : Brass

SPECIFICATION

Current Rate : 1 AMP
Insulation Resistance : 5000MΩMin. at DC 500V
Contact Resistance : 10mΩMax. at DC 100mA
Operation Temperature : -40°C to +105°C

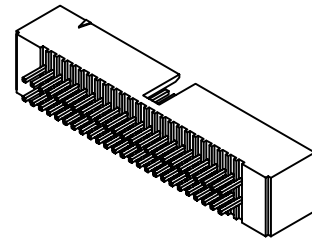

Detail Dimensions

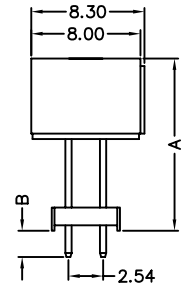
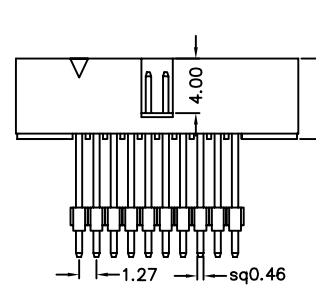
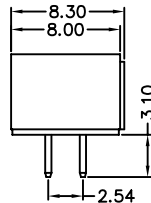
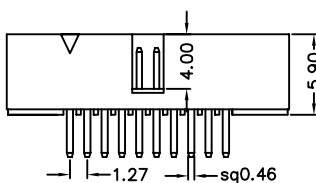
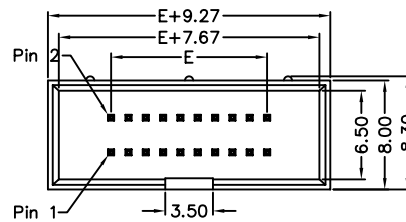
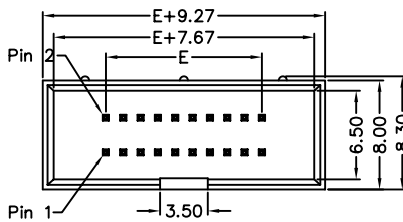

Recommended P.C.B Layout

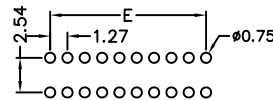
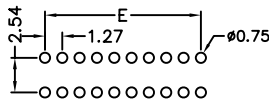

Order Information

54x-x 0 - xx G B xx
1 2 3 4 5

Standard Parts
540-x0-xxGB00

- 1. 0: Straight Type
- 6: Straight Elevated Type
- 2. 7: Green Product
- 9: Green Product High Temp
- 3. No. of contacts
- 4. G: Gold Flash
- S: Selective Gold Plating
- T: Tin Plating

5. Pinrex internal code

If you need other dimensions please fill out DIM A/B and contact our sales representatives.

DIM A	DIM B

Number Of Contacts

Unit: mm

Poles	DIM E	Poles	DIM E	Poles	DIM E										
		36	21.59	100	21.59										
20	11.43	40	24.13												
24	13.97	44	26.67												
26	15.24	50	30.48												
30	17.78	60	31.75												
32	19.05	68	36.83												
34	20.32	80	20.32												