



# 1.27x2.54mm Box Header Right Angle (Elevated) Type

## MATERIAL

Insulator : High Temperature Polyester  
Contact Pin : Brass

## SPECIFICATION

Current Rate : 1 AMP  
Insulation Resistance : 5000MΩMin. at DC 500V  
Contact Resistance : 10mΩMax. at DC 100mA  
Operation Temperature : -40°C to +105°C

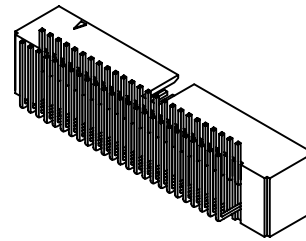

## Detail Dimensions

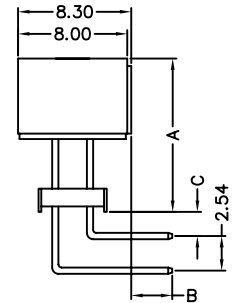
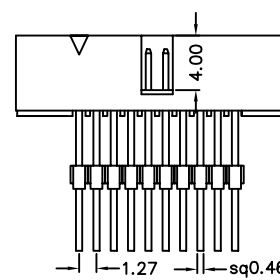
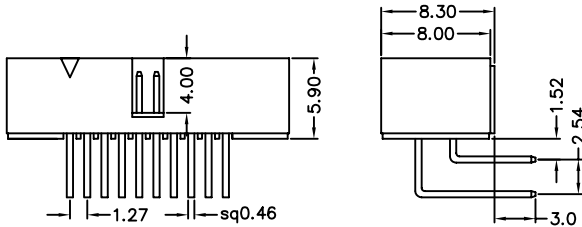
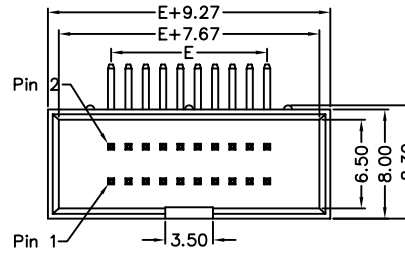
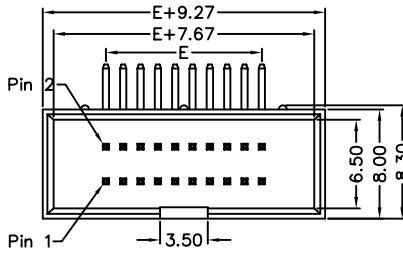

## Recommended P.C.B Layout

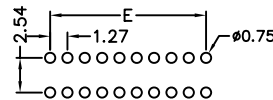
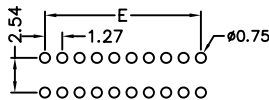

## Order Information

54x-x 0 - xx G B xx  
1 2 3 4 5

Standard Parts  
541-x0-xxGB00

- 1: Right Angle Type
- 7: Right Angle Elevated Type
- 2: 7: Green Product
- 9: Green Product High Temp
- 3: No. of contacts
- 4: G: Gold Flash
- S: Selective Gold Plating
- T: Tin Plating

5. Pinrex internal code

If you need other dimensions please fill out DIM A/B/C and contact our sales representatives.

DIM A	DIM B	DIM C

## Number Of Contacts

Unit: mm

Poles	DIM E	Poles	DIM E	Poles	DIM E
20	11.43	36	21.59	100	21.59
24	13.97	40	24.13		
26	15.24	44	26.67		
30	17.78	50	30.48		
32	19.05	60	31.75		
34	20.32	68	36.83		
		80	20.32		