



# 2.0mm Box Header Right Angle (Elevated) Type

## MATERIAL

Insulator : High Temperature Polyester  
Contact Pin : Brass

## SPECIFICATION

Current Rate : 1 AMP  
Insulation Resistance : 5000MΩMin. at DC 500V  
Contact Resistance : 20mΩMax. at DC 100mA  
Operation Temperature : -40°C to +105°C

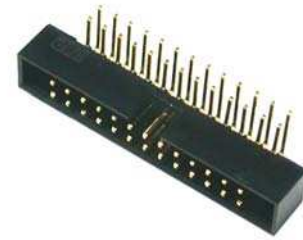

## Detail Dimensions

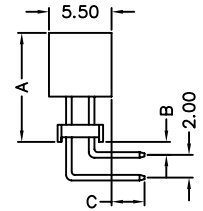
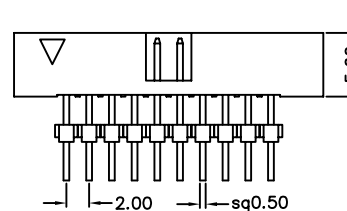
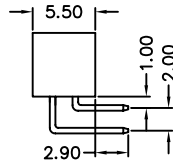
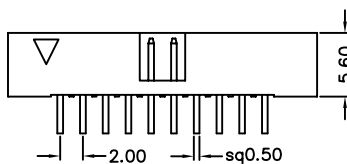
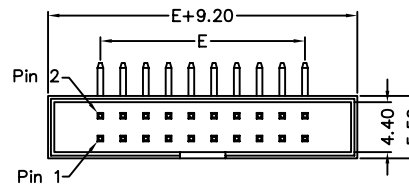
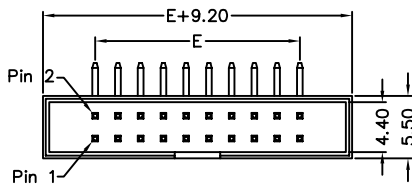

## Recommended P.C.B Layout

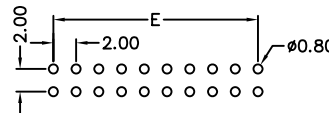
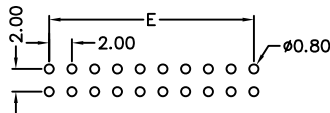

## Order Information

52 $\underline{x}$ - $\underline{x}$  0 -  $\underline{xx}$  G B  $\underline{xx}$   
1 2 3 4 5

Standard Parts  
521-x0-xxGB11

- 1: Right Angle Type
- 7: R/A Elevated Type
- 2: 7: Green Product
- 9: Green Product High Temp
- 3: No. of contacts
- 4: G: Gold Flash
- S: Selective Gold Plating
- T: Tin Plating

5. Pinrex internal code

If you need other dimensions please fill out DIM A/B/C and contact our sales representatives.

DIM A	DIM B	DIM C

## Number Of Contacts

Unit: mm

Poles	DIM E	Poles	DIM E	Poles	DIM E	Poles	DIM E								
		18	16.00	32	30.00	64	62.00								
6	4.00	20	18.00	34	32.00	68	66.00								
8	6.00	22	20.00	36	34.00										
10	8.00	24	22.00	40	38.00										
12	10.00	26	24.00	44	42.00										
14	12.00	28	26.00	50	48.00										
16	14.00	30	28.00	60	58.00										