



2.0mm Box Header SMT (Elevated) Type

MATERIAL

Insulator : High Temperature Polyester
Contact Pin : Brass

SPECIFICATION

Current Rate : 1 AMP
Insulation Resistance : 5000MΩMin. at DC 500V
Contact Resistance : 20mΩMax. at DC 100mA
Operation Temperature : -40°C to +105°C

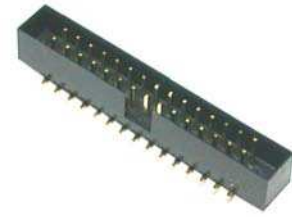

Detail Dimensions

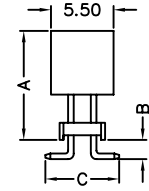
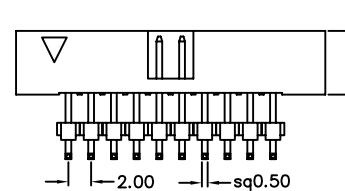
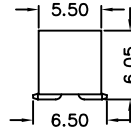
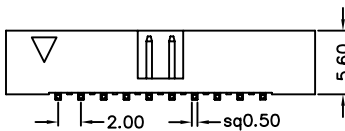
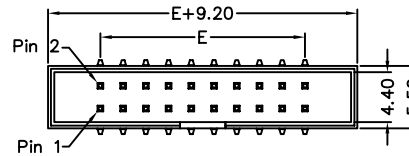
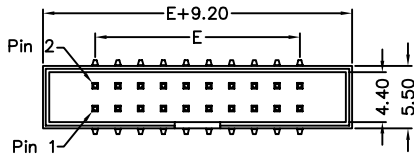

Recommended P.C.B Layout

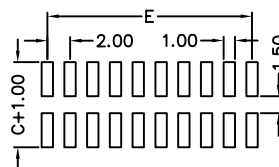
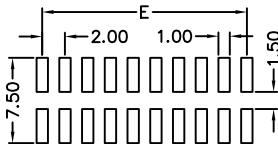

Order Information

52 \underline{x} - \underline{x} 0 - \underline{xx} G B \underline{xx}
1 2 3 4 5

Standard Parts
522-x0-xxGB00

- 1. 2: SMT Type
- 8: SMT Elevated Type
- 2. 7: Green Product
- 9: Green Product High Temp
- 3. No. of contacts
- 4. G: Gold Flash
- S: Selective Gold Plating
- T: Tin Plating

5. Pinrex internal code

If you need other dimensions please fill out DIM A/B/C and contact our sales representatives.

DIM A	DIM B	DIM C

Number Of Contacts

Unit: mm

Poles	DIM E	Poles	DIM E	Poles	DIM E	Poles	DIM E							
6	4.00	18	16.00	32	30.00	64	62.00							
8	6.00	20	18.00	34	32.00	68	66.00							
10	8.00	22	20.00	36	34.00									
12	10.00	24	22.00	40	38.00									
14	12.00	26	24.00	44	42.00									
16	14.00	28	26.00	50	48.00									
		30	28.00	60	58.00									