



2.5mm Wire to Board Header Straight (R/A) Type

■ MATERIAL

Insulator : Polyester
Contact Pin : Brass

■ SPECIFICATION

Current Rate : 3 AMP
Insulation Resistance : 1000MΩ MIN.
Contact Resistance : 10mΩ Max.
Operation Temperature : -25°C to +85°C



■ Detail Dimensions

753-71-xxTW01

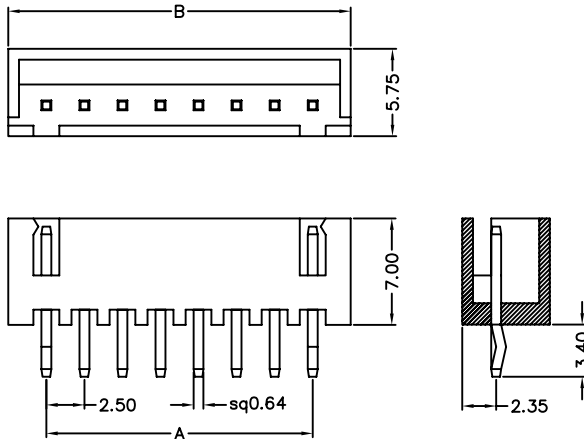

753-72-xxTW01

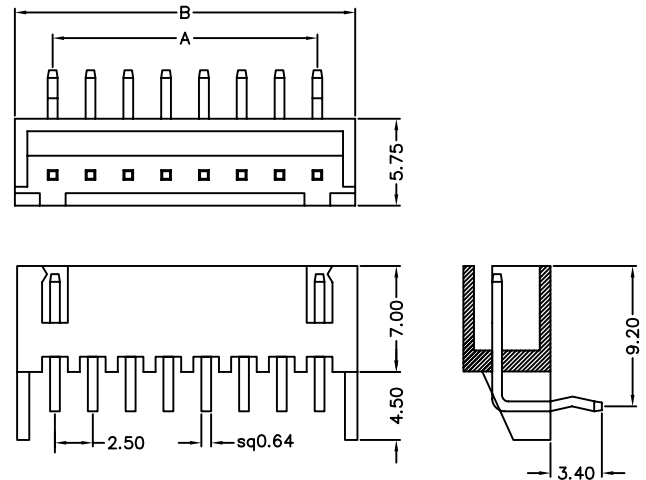

■ Recommended P.C.B Layout

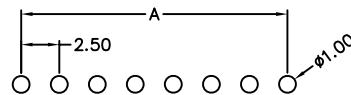
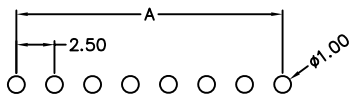

■ Order Information

753-7 x - xx T W xx
1 2 3 4 5

Standard Parts	Type
753-71-xxTW01	Straight
753-72-xxTW01	Right Angle

1. 1: Straight Type
2: Right Angle Type
2. No. of contacts
3. T: Tin Plating
4. W: White Insulator
5. Pinrex internal code

■ Number Of Contacts

Unit: mm

Poles	DIM A	DIM B	Poles	DIM A	DIM B	Poles	DIM A	DIM B							
2	2.50	7.50	9	20.00	25.00	16	37.50	42.50							
3	5.00	10.00	10	22.50	27.50	17	40.00	45.00							
4	7.50	12.50	11	25.00	30.00	18	42.50	47.50							
5	10.00	15.00	12	27.50	32.50	19	45.00	50.00							
6	12.50	17.50	13	30.00	35.00	20	47.50	52.50							
7	15.00	20.00	14	32.50	37.50										
8	17.50	22.50	15	35.00	40.00										