



# 2.5mm Wire to Board Header Straight (R/A) Type

## ■ MATERIAL

Insulator : Polyester  
Contact Pin : Brass

## ■ SPECIFICATION

Current Rate : 3 AMP  
Insulation Resistance : 1000MΩ MIN.  
Contact Resistance : 10mΩMax.  
Operation Temperature : -25°C to +85°C

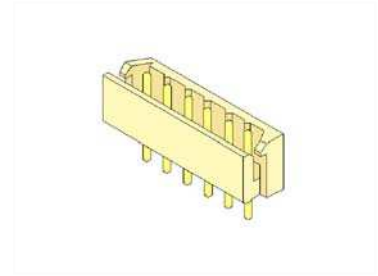

## ■ Detail Dimensions

756-71-xxTW01

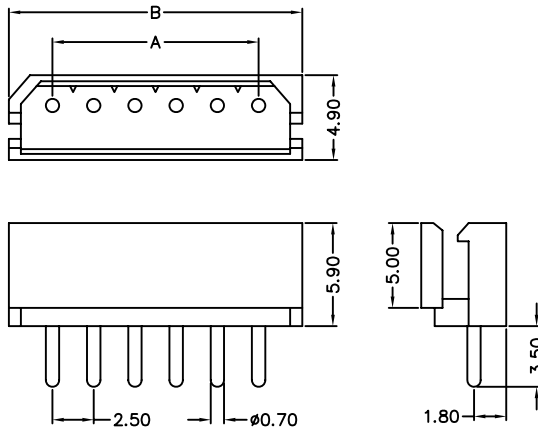

756-72-xxTW01

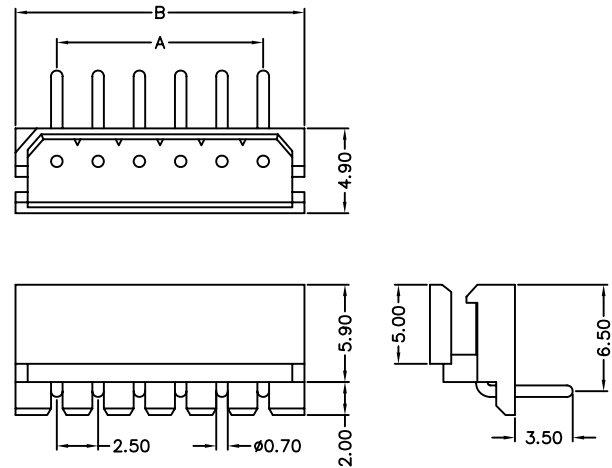

## ■ Recommended P.C.B Layout

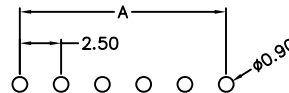
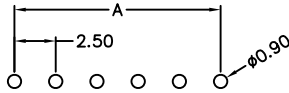

## ■ Order Information

756-7 x - xx T W xx  
1 2 3 4 5

Standard Parts	Type
756-71-xxTW01	Straight
756-72-xxTW01	Right Angle

- 1: Straight Type  
2: Right Angle Type
2. No. of contacts
3. T: Tin Plating
4. W: White Insulator
5. Pinrex internal code

## ■ Number Of Contacts

Unit: mm

Poles	DIM A	DIM B	Poles	DIM A	DIM B	Poles	DIM A	DIM B						
2	2.50	7.50	9	20.00	25.00	16	37.50	42.50						
3	5.00	10.00	10	22.50	27.50	17	40.00	45.00						
4	7.50	12.50	11	25.00	30.00	18	42.50	47.50						
5	10.00	15.00	12	27.50	32.50	19	45.00	50.00						
6	12.50	17.50	13	30.00	35.00	20	47.50	52.50						
7	15.00	20.00	14	32.50	37.50									
8	17.50	22.50	15	35.00	40.00									