



2.5mm Wire to Board Header Straight (R/A) Type

MATERIAL

Insulator : Polyester
Contact Pin : Brass

SPECIFICATION

Current Rate : 2 AMP
Insulation Resistance : 1000MΩ MIN.
Contact Resistance : 10mΩMax.
Operation Temperature : -25°C to +85°C



Detail Dimensions

743-71-xxTW02

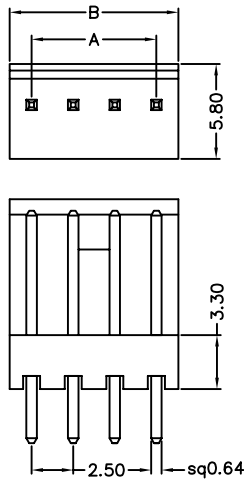

743-72-xxTW02

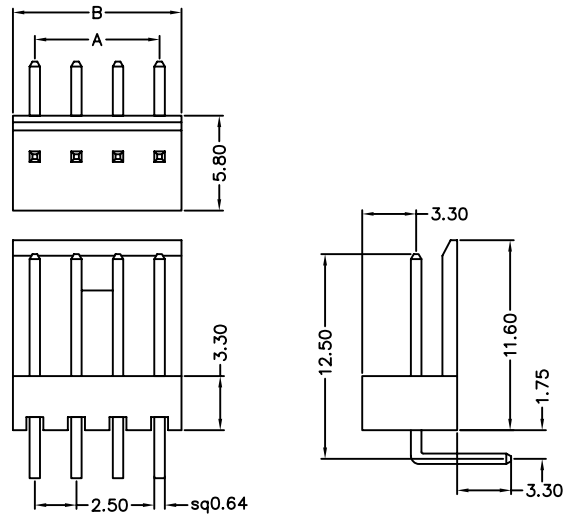

Recommended P.C.B Layout

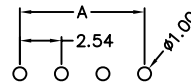
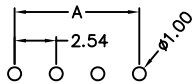

Order Information

743-7x - xx T W xx
1 2 3 4 5

- 1: Straight Type
- 2: Right Angle Type
- 2: No. of contacts
- 3: T: Tin Plating
- 4: W: White Insulator
- 5: Pinrex internal code

Standard Parts	Type
743-71-xxTW01	Straight
743-72-xxTW01	Right Angle

743-72-04TW12 (with wall)

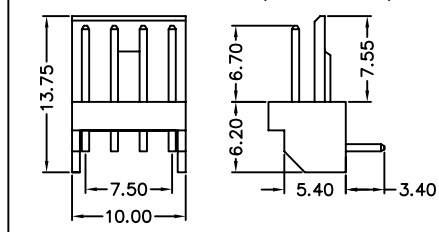

Number Of Contacts

Unit: mm

Poles	DIM A	DIM B	Poles	DIM A	DIM B
2	2.50	5.00	9	20.00	22.50
3	5.00	7.50	10	22.50	25.00
4	7.50	10.00	11	25.00	27.50
5	10.00	12.50	12	27.50	30.00
6	12.50	15.00			
7	15.00	17.50			
8	17.50	20.00			