



2.5mm Wire to Wire Crimping Connector

MATERIAL

Insulator : Polyester
Contact Pin : Copper Alloy

SPECIFICATION

Current Rate : 2 AMP
Insulation Resistance : 1000MΩ MIN.
Contact Resistance : 20mΩMax.
Operation Temperature : -25°C to +85°C



Detail Dimensions

750-75-MxxW01 (Male Housing)

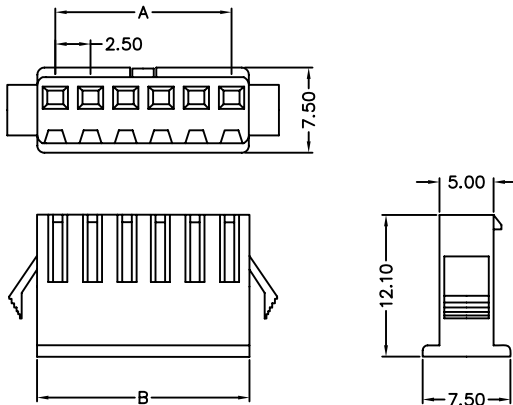

750-75-FxxW01 (Female Housing)

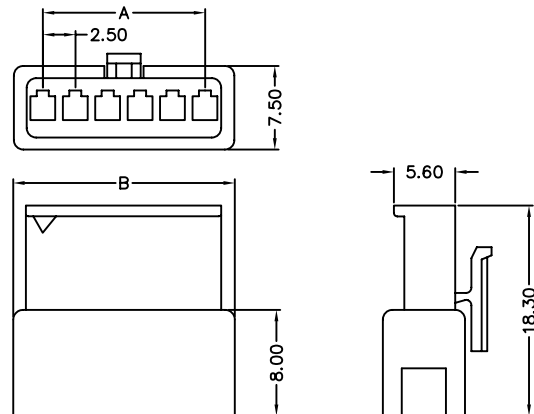

750-70-Fx0001 (Female Terminal)

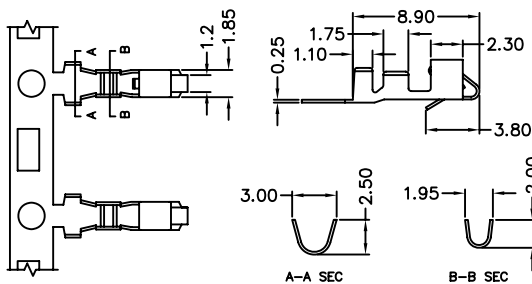

750-70-Mx0001 (Male Terminal)

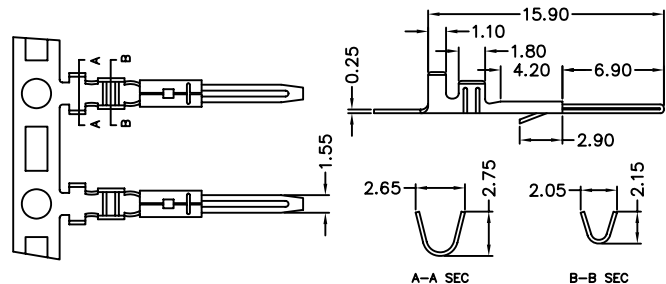

Order Information

750-75 - x xx W 01
1 2 3 4

750-70 - x T 0001
5 6 7

1. M: Male Housing
F: Female Housing
2. No. of contacts
3. W: White Insulator
4. Pinrex internal code

5. M: Male Terminal
F: Female Terminal
6. T: Tin Plating
G: Gold Flash
S: Selective Gold Plating
7. Pinrex internal code

Standard Parts	Type
750-75-MxxW01	Male Housing
750-75-FxxW01	Female Housing
750-70-MT0001	Male Terminal
750-70-FT0001	Female Terminal

Number Of Contacts

Unit: mm

Poles	DIM A	DIM B	Poles	DIM A	DIM B	Poles	DIM A	DIM B	Poles	DIM A	DIM B
2	2.50	8.00	9	20.00	25.50	2	2.50	5.50	9	20.00	23.00
3	5.00	10.50	10	22.50	28.00	3	5.00	8.00	10	22.50	25.50
4	7.50	13.00	11	25.00	30.50	4	7.50	10.50	11	25.00	28.00
5	10.00	15.50	12	27.50	33.00	5	10.00	13.00	12	27.50	30.50
6	12.50	18.00				6	12.50	15.50			
7	15.00	20.50				7	15.00	18.00			
8	17.50	23.00				8	17.50	20.50			