



HEYClean® Brass Pressure Equalization and Drain Plugs

For Pressure Equalization and Drainage Applications

Pressure Equalization Plugs

- Allow the passage of air for ventilation and heat dissipation, yet prevent moisture intrusion.
- Filter membrane prevents moisture and particulate contamination in electronic enclosures.
- Pressure compensating seal prevents buildup of pressure inside of electronic enclosures due to environmental temperature cycling.
- Quick and easy installation into Clearance or Threaded Holes. For Metric Brass Locknuts, see page 3-40.
- Nickel-plated finish over brass provides excellent corrosion resistance and durability.
- Head Thickness: .37" (9,5 mm) to .39" (10 mm).
- Hex shaped body for wrench installation.
- Filter element:
Liquid Tight Membrane: Polyethersulfone (PES)
Sintered Disc: Bronze

Drain Plugs

- Drainage Plugs are ideal for applications where condensation is expected.
- Stainless steel mesh allows water to drain quickly, but protects enclosure from bugs and dust.
- Drainage Plugs feature a cutout section to allow water to completely drain from enclosure, and should be installed at enclosure's lowest point.
- Head Thickness: .37" (9,5 mm) to .39" (10 mm).
- Hex shaped body for wrench installation.

Drain Plug Locknuts

- Quick and easy installation into Clearance Holes only.
- Locknuts feature special cutout to allow water to completely drain from enclosure, when used with HEYClean™ Threaded Drainage Plugs.

THREAD Type/Size	PART NO.	DESCRIPTION	PART DIMENSIONS								PROTECTION CLASS
			A Clearance Hole		B Overall Length		C Thread Length		D Wrenching Flats		
			in.	mm.	in.	mm.	in.	mm.	in.	mm.	

Liquid Tight Pressure Equalization Plugs - Ultimate in Liquid Tight Pressure Equalization

M12	4350	BRASS LTPEP M12	.47	12,0	.69	17,5	.31	8,0	.71	18,0	IP 66,67,68
M16	4351	BRASS LTPEP M16	.63	16,0							
M20	4352	BRASS LTPEP M20	.79	20,0	.71	18,0	.31	8,0	.87	22,0	

Liquid Resistant Pressure Equalization Plugs - Maximize Airflow for Extreme Pressure and Moisture Fluctuations

M12	4354	BRASS LRPEP M12	.47	12,0	.69	17,5	.31	8,0	.71	18,0	IP 55, x9K
M16	4355	BRASS LRPEP M16	.63	16,0							
M20	4356	BRASS LRPEP M20	.79	20,0	.71	18,0	.31	8,0	.87	22,0	

Threaded Drain Plug - For Applications Where Condensation Is Expected*

M12	4357	BRASS TDP M12	.47	12,0	.69	17,5	.39	10,0	.71	18,0	IP 4x
M16	4358	BRASS TDP M16	.63	16,0							
M20	4359	BRASS TDP M20	.79	20,0	.79	20,0	.39	10,0	.87	22,0	

Stainless Steel available. Consult Heyco.

*Heyco Drainage Plug Brass Locknuts sold separately

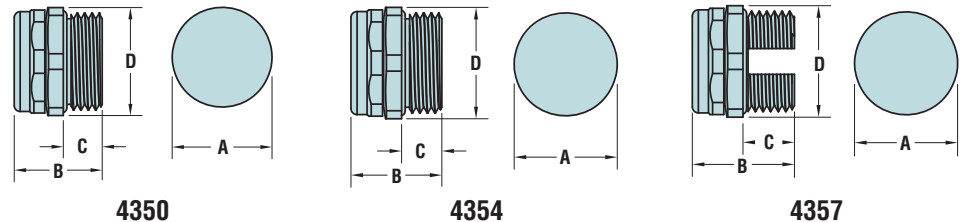

HEYClean® Drain Plug Brass Locknuts

For Use with HEYClean™ Threaded Drainage Plugs

THREAD Type/Size	PART NO.	DESCRIPTION	PART DIMENSIONS			
			A Thickness		B Wrenching Flats	
			in.	mm.	in.	mm.
M12	4360	BRASS DPLN M12	.18	4,5	.59	15,0
M16	4361	BRASS DPLN M16	.22	5,5	.75	19,0
M20	4362	BRASS DPLN M20	.22	5,5	.95	24,0

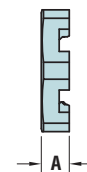
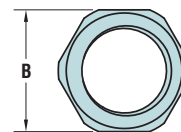

Quick
Specs

Material	Nickel-Plated Brass
Temperature Rating	-40°F (-40°C) to 230°F (110°C)
IP Rating	Membrane - IP66/IP68/IP69 Filter Disc - IP55/ IPX9K Drainage Element - IP4X