



Heyco® Rubber Grommets

For Panels from .063" (1,6 mm) to .125" (3,2 mm) Thick

MOUNTING HOLE DIAMETER		PART NO.	DESCRIPTION	MATERIAL	PART DIMENSIONS					
in.	mm.				A Inside Diameter		B Head Diameter		C Overall Height	
		Black			in.	mm.	in.	mm.	in.	mm.
For .063" (1,6 mm) Thick Panels (continued)										
1.750	44,5	G1369	RG 1750-48-2	SBR	1.500	38,1	2.125	54,0	.438	11,1
2.375	60,3	G1409	RG 2.375-40-2	Nitrile	1.250	31,8	2.750	69,9	.438	11,1
2.500	63,5	G1418	RG 2.5-40-2	Nitrile	1.250	31,8	2.875	73,0	.438	11,1
		G1422	RG 2.5-68-2	SBR	2.125	54,0				
For .078" (2,0 mm) Thick Panels										
1.000	25,4	G1253	RG 1000-22-3	SBR	.688	17,5	1.313	33,4	.375	9,5
For .094" (2,4 mm) Thick Panels										
.281	7,1	G1010	RG 281-6-3	SBR	.188	4,8	.438	11,1	.219	5,6
.312	7,9	G1014	RG 312-6-3	SBR	.188	4,8	.500	12,7	.281	7,1
.375	9,5	G1033	RG 375-4-3	SBR	.125	3,2	.500	12,7	.313	8,0
		G1038	RG 375-8-3	SBR	.250	6,4	.500	12,7	.250	6,4
		G1039	RG 375-8-3A	SBR	.250	6,4	.563	14,3	.281	7,1
.437	11,1	G1062	RG 437-10-3	SBR	.313	8,0	.625	15,9	.313	8,0
.750	19,1	G1178	RG 750-16-3	SBR	.500	12,7	.875	22,2	.344	8,7
		G1179	RG 750-16-3A	SBR	.500	12,7	.969	24,6	.281	7,1
1.125	28,6	G1281	RG 1125-28-3	SBR	.875	22,2	1.500	38,1	.344	8,7
2.000	50,8	G1387	RG 2000-48-3	SBR	1.500	38,1	2.375	60,3	.375	9,5
For .110" (2,8 mm) Thick Panels										
.630	16,0	G1140	RG 630-16-3	SBR	.500	12,7	.810	20,6	.300	7,6
For .125" (3,2 mm) Thick Panels										
.312	7,9	G1020	RG 312-6-4	SBR	.188	4,8	.438	11,8	.250	6,4
.406	10,3	G1047	RG 406-9-4	SBR	.281	7,1	.625	15,9	.375	9,5
.437	11,1	G1056	RG 437-8-4	SBR	.250	6,4	.625	15,9	.250	6,4
.500	12,7	G1092	RG 500-12-4	SBR	.375	9,5	.625	15,9	.313	8,0
		G1093	RG 500-12-4A	SBR	.375	9,5	.625	15,9	.406	10,3
.562	14,3	G1114	RG 562-10-4	SBR	.313	8,0	.813	20,7	.375	9,5
.625	15,9	G1127	RG 625-6-4	Nitrile	.188	4,8	.875	22,2	.250	6,4
		G1132	RG 625-12-4	SBR	.375	9,5	.875	22,2	.375	9,5
.687	17,5	G1152	RG 687-14-4	SBR	.438	11,1	.938	23,8	.375	9,5
		G1188	RG 812-12-4	SBR	.375	9,5	1.063	27,0		
		G1193	RG 812-16-4	SBR	.500	12,7	1.063	27,0	.375	9,5
.875	22,2	G1198	RG 812-18-4	SBR	.563	14,3	1.063	27,0		
		G1218	RG 875-20-4	SBR	.625	15,9	1.125	28,6	.375	9,5
		G1244	RG 1000-12-4	SBR	.375	9,5	1.250	31,8	.313	8,0
1.000	25,4	G1247	RG 1000-16-4	SBR	.500	12,7	1.250	31,8	.313	8,0
		G1255	RG 1000-22-4	SBR	.688	17,5	1.313	33,4	.438	11,1
		G1259	RG 1000-24-4	EPDM	.750	19,1	1.188	30,2	.375	9,5
1.250	31,8	G1260	RG 1000-24-4A	SBR	.750	19,1	1.250	31,8		
		G1291	RG 1250-16-4	SBR	.500	12,7	1.500	38,1	.313	8,0
		G1299	RG 1250-24-4	SBR	.750	19,1	1.625	41,3		
		G1304	RG 1250-28-4	SBR	.875	22,2	1.625	41,3	.500	12,7

- **Used to protect through holes.** Help eliminate sharp edges so your wires are protected and add aesthetic value to your application.
- 113 sizes available that will accommodate mounting holes ranging from .250" (6,4 mm) to holes as large as 2.375" (60,3 mm) diameter and panel thicknesses from .063" (1,6 mm) to .188" (4,8 mm).
- Rubber grommets are constructed of SBR (unless otherwise noted) with an operating temperature range of -40°F (-40°C) to 221°F (105°C).
- SBR grommets have good water resistant characteristics and are suitable for most moderate chemicals and wet or dry organic acids.
- Provide vibration dampening.

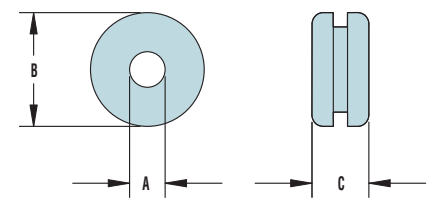

Standard color black.

Material	SBR, Nitrile or EPDM
Temperature Rating	-40°F (-40°C) to 221°F (105°C)

Quick Specs