



# Heyco® Sheet Metal Plugs - Flush Head

For Panel Thicknesses from .02" (0,5 mm) to .11" (2,8 mm)  
Mounting Hole Diameter Range: .18" (4,6 mm) to 3.00" (76,2 mm)



PANEL DIMENSIONS				PART NO.	DESCRIPTION	PART DIMENSIONS					
Thickness Range		Mounting Hole Diameter Range				Black	A Head Diameter		B Bottom Diameter		C Overall Height
in.	mm.	in.	mm.		in.		mm.	in.	mm.	in.	mm.
<b>Molded from EVA</b>											
.02-.04	0,51-1,02	.18-.19	4,6-4,9	<b>9640</b>	SMP F-M5	.39	9,9	.21	5,3	.21	5,3
.02-.06	0,51-1,52	.23-.24	5,8-6,1	<b>9641</b>	SMP F-M6	.50	12,7	.29	7,4	.45	11,4
.02-.07	0,51-1,78	.24-.25	6,1-6,4	<b>9642</b>	SMP F-250	.50	12,7	.28	7,1	.21	5,3
<b>Molded from LDPE</b>											
.02-.05	0,51-1,27	.37-.38	9,4-9,7	<b>9644</b>	SMP F-375	.75	19,1	.41	10,4	.19	4,8
.03-.06	0,76-1,52	.43-.45	10,9-11,4	<b>9646</b>	SMP F-437	.69	17,5	.47	11,9	.22	5,6
.03-.08	0,76-2,03	.49-.51	12,5-13,0	<b>9647</b>	SMP F-500	.86	21,8	.54	13,7	.25	6,4
		.55-.56	14,0-14,2	<b>9648</b>	SMP F-562	.87	22,1	.60	15,2		
.06-.08	1,52-2,03	.62	15,7	<b>9649</b>	SMP F-625	.81	20,6	.67	17,0	.25	6,4
.03-.08	0,76-2,03	.68-.70	17,3-17,8	<b>9650</b>	SMP F-687	1.01	25,7	.73	18,5	.25	6,4
.05-.11	1,27-2,79	.73-.76	18,5-19,3	<b>9651</b>	SMP F-750	1.01	25,7	.79	20,1	.29	7,4
.03-.08	0,76-2,03	.86-.88	21,8-22,4	<b>9654</b>	SMP F-875	1.16	29,5	.91	23,1	.25	6,4
		.92-.95	23,4-24,1	<b>9656</b>	SMP F-937	1.31	33,3	.98	24,9		
		1.00	25,4	<b>9657</b>	SMP F-1000	1.38	35,1	1.04	26,4		
.02-.18	0,51-4,57	1.10-1.15	27,9-29,2	<b>9660</b>	SMP F-1125	1.53	38,9	1.18	30,0	.43	10,9
.03-.08	0,76-2,03	1.16-1.20	29,5-30,5	<b>9661</b>	SMP F-1187	1.56	39,6	1.22	31,0	.25	6,4
		1.25	31,8	<b>9663</b>	SMP F-1250	1.62	41,1	1.29	32,8		
		1.29-1.33	32,8-33,8	<b>9664</b>	SMP F-1312	1.68	42,7	1.36	34,6		
		1.50	38,1	<b>9665</b>	SMP F-1500	1.88	47,8	1.54	39,1		
		1.75	44,5	<b>9666</b>	SMP F-1750	2.12	53,8	1.79	45,5		
		1.98-2.01	50,3-51,1	<b>9667</b>	SMP F-2000	2.36	59,9	2.04	51,8		
		2.50	63,5	<b>9669</b>	SMP F-2.5	3.00	76,2	2.56	65,0		
		3.00	76,2	<b>9671</b>	SMP F-3.0	3.36	85,3	3.06	77,7		

- Close unneeded sheet metal panel holes in equipment such as automobile bodies, tanks, refrigeration units, etc.
- **Flush button head style.**
- Retaining bead snaps easily into place.
- Available in multiple sizes from .18" (4,6 mm) through 3.0" (76,2 mm) diameter holes.
- For easier to install Sheet Metal Plugs made from flexible Santoprene, see Heyco Metric Ergonomic Plugs on page 6-15.

Standard color black.

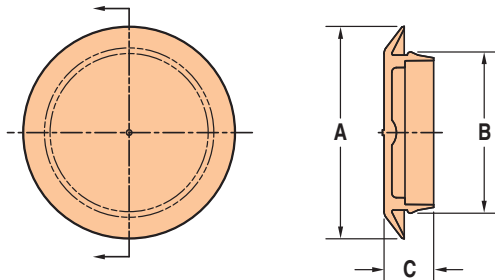

<b>Material</b>	EVA	LDPE
<b>Maximum Temperature Rating</b>	EVA 140°F (60°C)	LDPE 175°F (79°C)

*Quick  
Specs*