

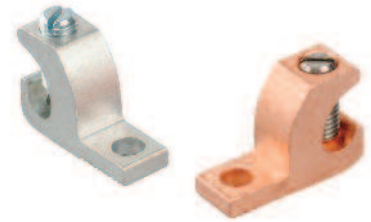

ALL NEW PRODUCTS!

# Heyco® Copper and Aluminum Lay-In Connectors



Wire Range AWG	PART NO.	DESCRIPTION	CONSTRUCTION	PART DIMENSIONS (in.)					
				A	B	C	D	F	H
4-14	S6525	LC 14-4 1-Pole Cu Tinned	Tinned Copper with Stainless Steel Set Screw	1.07	.75	.38	.22	.19	.15
	S6526	LC 14-4 1-Pole Cu	Copper with Stainless Steel Set Screw						
	S6527	LC 14-4 1-Pole Al	Aluminum with Steel Set Screw						

- Copper construction parts available in plated and unplated versions.
- Copper construction parts UL/CSA approved for direct burial and suitable for both indoor and out door use.
- Least expensive aluminum option suitable for indoor use only.
- **Recommended wire range AWG 4 thru AWG 14.**

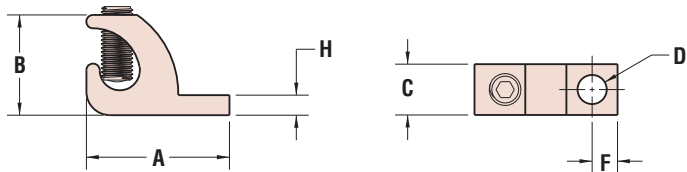

LCC and LCA Series

# Heyco® Aluminum Neutral Bars



WIRE RANGE AWG	CIRCUITS No.	MOUNTING HOLE(S)		LENGTH in.	PART NO.	DESCRIPTION	UL/CSA	PART DIMENSIONS (in.)				
		No.	Pos(s).					Width A	Height B	C	Pitch D	E
4-14 Cu or 4-12 Al	2	1	2	1.00	S6535	NB 14-4 2-Pole	CU9AL	.312	.437	.187	.312	.187
	3	2	1 & 5	1.63	S6536	NB 14-4 3-Pole						
	5	2	1 & 7	2.25	S6537	NB 14-4 5-Pole						
	6	1	4	2.25	S6538	NB 14-4 6-Pole						
		2	1 & 8	2.56	S6539							
	10	2	1 & 12	3.81	S6540	NB 14-4 10-Pole						
12	2	1 & 14	4.44	S6541	NB 14-4 12-Pole							

Other wire ranges, bar sizes, materials and configurations are available, consult Heyco

- Neutral bar for ground or power; **not** for power distribution.
- Rated at **85 Amps for Copper** wire and **70 Amps for Aluminum** wire.
- Wire range: AWG 4-14 CU (copper wire), 4-12 Al (aluminum wire) Dual Rated, Solid & Stranded, rigid or semi rigid stranding.
- Set screws are slotted, headless, zinc plated steel and will hold the smaller wires when the appropriate torque is fully applied.
- Use #10 mounting screw.

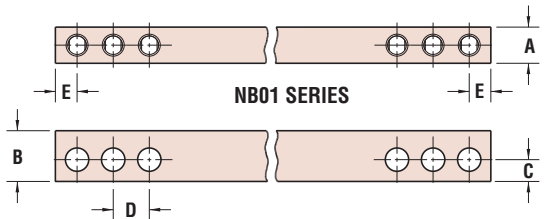

**Materials** High strength tempered aluminum Alloy 6061, tin plated to resist oxidation and galvanic corrosion and with conductivity of approximately 43% IACS. Zinc plated steel screws with trivalent (Cr+3) chromate conversion top layer.

**Certifications** UL Recognized Class ZMVV2.E80121 and CSA Certified File 8919

**Temperature Rating** CU9AL - 194°F (90°C).

Quick Specs