



Model Number

DM 60-31-15

Permanent magnet for magnetic field sensors

Dimensions

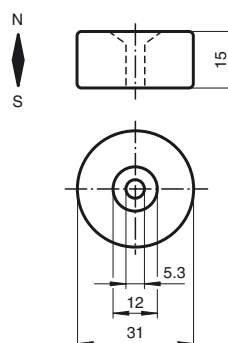

Technical data

Ambient conditions

Ambient temperature max. 200 °C

Mechanical specifications

Material SrFe acc. to ratio 22/14
 Dimensions Height: 15 mm
 Diameter: 31 mm

Technical details

The hard ferrite magnet consists of strontium ferrite (SrFe). The magnetisation already takes place during the shaping and is thus in imposed axial direction (anisotropic).

The magnetic clamp disk can be screwed onto a surface through a centre hole with a counter-sunk screw to save space. For fastening, use a M5 countersunk screw made of unmagnetic, non-conducting material, e. g. V2A or brass. The dimensional tolerance usually amounts to ± 0.1 mm.

Characteristic		Value	
Power product	(W x H) max.	27 ... 32	kJ/m^3
Remanence	B_r	380 ... 400	mT
Coercive field strength	$J_H C$	235 ... 290	kA/m
Coercive field strength	$B_H C$	130 ... 275	kA/m
Relative remanent permeability	$\mu_0 \mu_r$	1.45 ... 1.65	mT/ kA/m
Temperature coefficient of the remanence	α	-0.20	%/°C
Density	r	5.0	g/cm^3