



■ Features:

- Universal AC input/ Full range
- High Efficiency, and High reliability
- Output protections: OLP/OVP/SCP
- Wide operating ambient temperature (-20°C~70°C)
- All using 105°C long life electrolytic capacitors.
- 100% full load burn-in test
- 3 year warranty



SPECIFICATION

MODEL		PD-15-3.3	PD-15-5	PD-15-12	PD-15-15	PD-15-24	
OUTPUT	DC Output	3.3V	5V	12V	15V	24V	
	Rated Current	4A	3A	1.3A	1A	0.7A	
	Current Range	Note 1 0~4A	0~3A	0~1.3A	0~1.0A	0~0.7A	
	Ripple and Noise	0~50°C Note 2 -20°C	50mV	50mV	120mV	120mV	120mV
	Voltage ADJ. Range	3.135V-3.465V	4.75V-5.255V	11.4V-12.6V	14.25V-15.75V	22.8V-25.2V	
	Voltage Accuracy	±3.0%	±3.0%	±3.0%	±3.0%	±3.0%	
	Line Regulation	±1.0%	±1.0%	±1.0%	±1.0%	±1.0%	
	Load Regulation	±2.0%	±2.0%	±2.0%	±2.0%	±2.0%	
	Set-up Time	<2.0S (115Vac input, Full load); <1.0S (230Vac input, Full load)					
	Hold up Time	>10mS(115Vac input, Full load); >20mS(230Vac input, Full load)					
	Temperature Coefficient	±0.03%/°C					
	Overshoot and Undershoot	<5.0%					
INPUT	Voltage Range	88Vac~264Vac					
	Frequency Range	47Hz~63Hz					
	Efficiency (Typical)	70%(230Vacinput)	76%(230Vacinput)	80%(230Vacinput)	81%(230Vacinput)	83%(230Vacinput)	
	AC Current (max.)	0.7A	0.7A	0.7A	0.7A	0.7A	
	Inrush Current (Typical)	20A@115Vac 40A@230Vac Cold start					
	Leakage Current	Input—output:<0.25mA Input—PG:<3.5mA					
PROTECTION	Over Load	105%~150% of rated output current, Hiccup mode,auto recovery					
	Over Voltage	105%~150% of rated output voltage, Constant Voltage					
	Shorted Circuit	Long-term mode, auto recovery					
ENVIRONMENT	Operating amb. Temp. & Hum.	-20°C~70°C; 20%~90%RH No condensing					
	Storage Temp. & Hum.	-40°C~85°C; 10%~95%RH No condensing					
SAFETY & EMC Note 3	Safety Standards	GB4943-2001; EN60950-1: 2006					
	Withstand Voltage	Primary-Secondary:3.0KVac; ≤10mA .Primary-PG:1.5KVac; ≤10mA. Secondary-PG:0.5KVDC;≤10mA.					
	Isolation Resistance	≥100M ohms					
	EMI Conduction&Radiation	Compliance to EN55022(CISPR22)ClassB					
	Harmonic Current	Compliance to EN61000-3-2,-3					
	EMS Immunity	Compliance to EN61000-4-2,3,4,5,6,8,11;ENV50204,light industry level,criteriaA					
OTHERS	MTBF (MIL-HDBK-217F)	More than 100,000Hrs (25°C, Full load)					
	Dimension (L*W*H)	79x51x28mm					
	Packing	48PCS/CTN, 10.4KGS, 0.03CBM					
	Cooling method	Cooling by free air convection					
NOTE	<ol style="list-style-type: none"> 1. All parameters NOT specially mentioned are measured at rated input, rated load and 25°C of ambient temperature. 2. Measured at 20MHz of bandwidth by using a 12" twisted pair-wire terminated with a 0.1 uF & 47uF parallel capacitor. 3. The SPS is considered a component which will be installed into final equipment. The equipment must be re-confirmed that it still meets EMC directives. 						

Mechanical Specification

Unit: mm

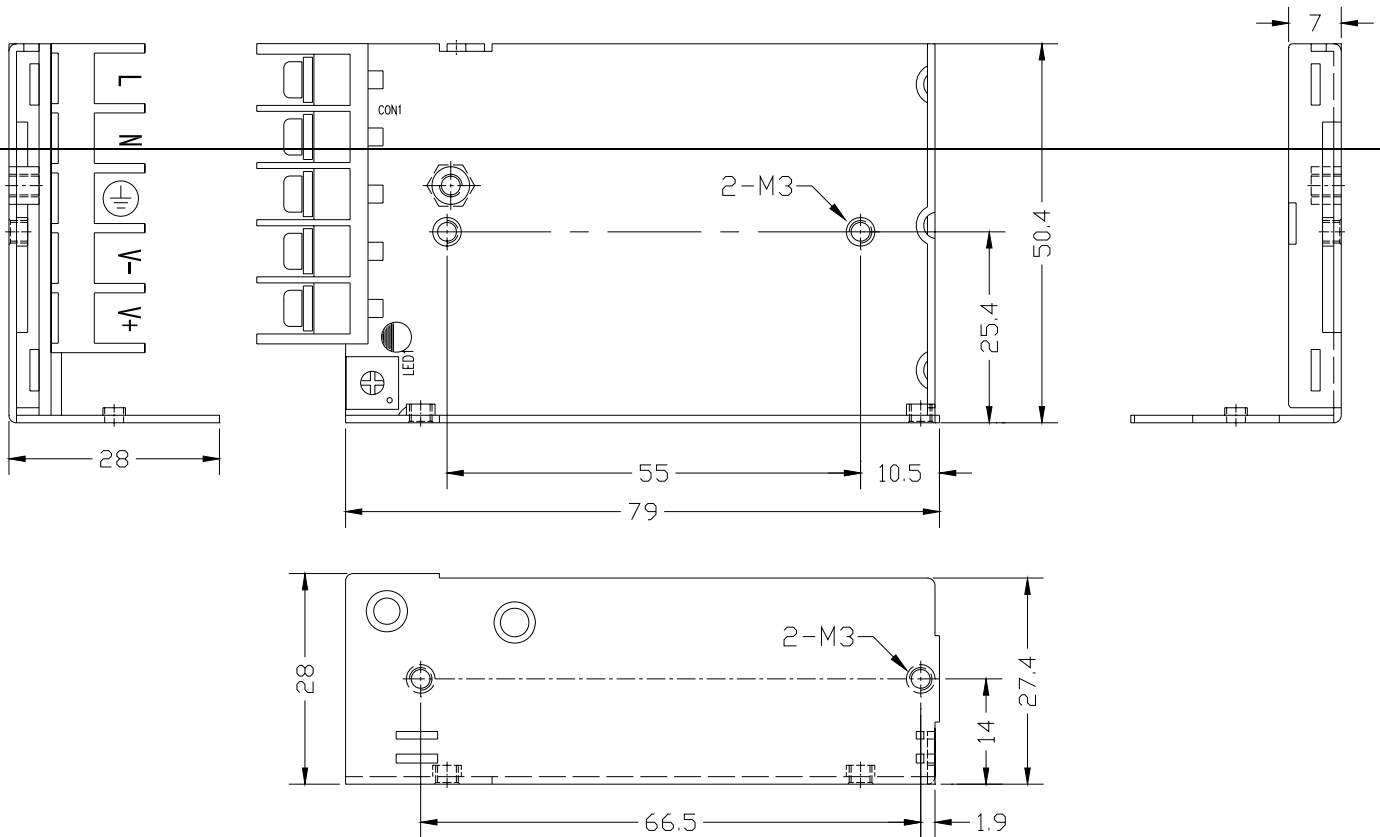

Block Diagram

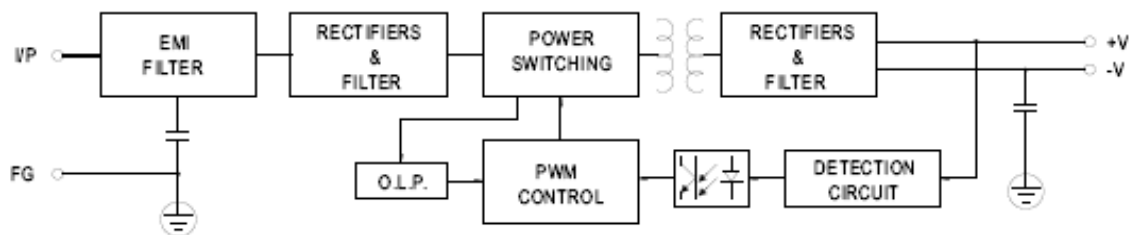

Derating Curve

