

# Customer Information Sheet

DRAWING No.: M90-25042-1XXX

SHEET 2 OF 2

IF IN DOUBT - ASK

©

NOT TO SCALE

THIRD ANGLE PROJECTION

ALL DIMENSIONS IN mm

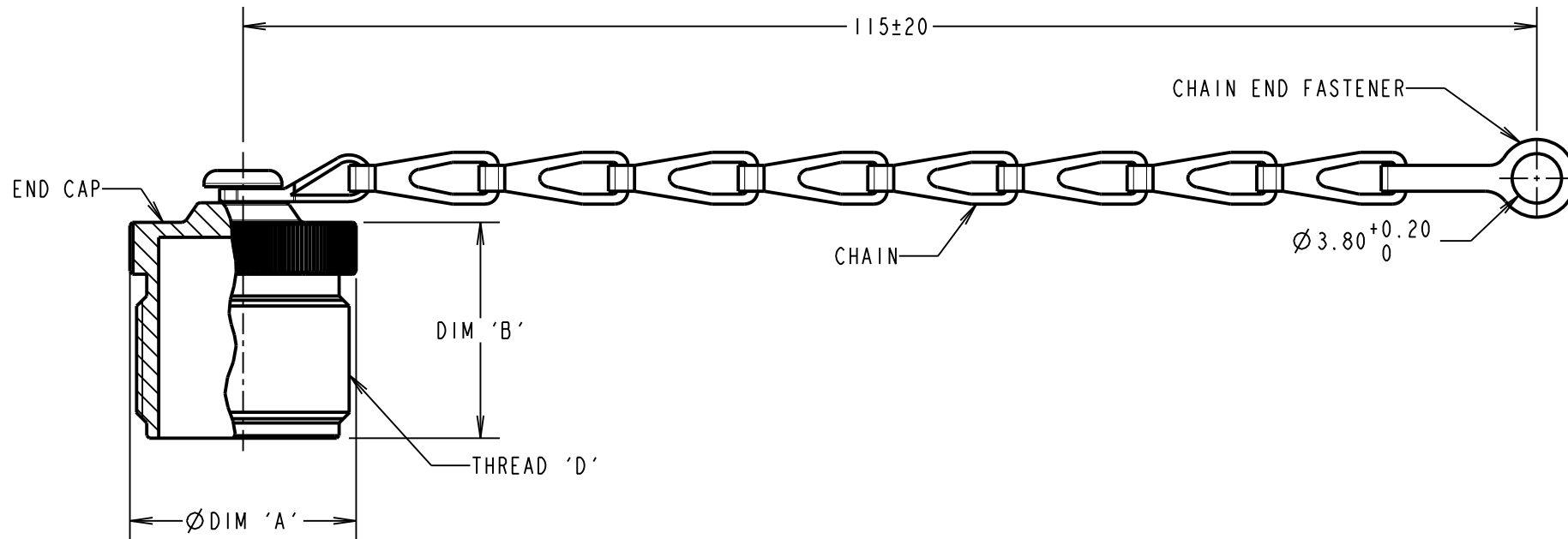

| PART No.       | DIM Ø 'A' MAX | DIM 'B' MAX | THREAD 'D'    |
|----------------|---------------|-------------|---------------|
| M90-25042-10SL | 17.45         | 16.66       | 5/8-24UNEF-2A |
| M90-25042-12S  | 20.62         | 16.66       | 3/4-20UNEF-2A |
| M90-25042-14S  | 23.80         | 16.66       | 7/8-24UNEF-2A |

**SPECIFICATION:**

**MATERIAL:**

END CAP: ALUMINIUM

CHAIN & CHAIN END FASTENER:  
COPPER ALLOY

**FINISH:**

END CAP: ZINC PLATED WITH BLACK  
CHROMATE COATING

CHAIN & CHAIN END FASTENER: BLACK CHROMATE  
COATING

ALL MATERIALS ARE RoHS COMPLIANT

|                |      |             |        |
|----------------|------|-------------|--------|
| RA             | 4    | 11.08.10    | 10894  |
| NAME           | ISS. | DATE        | C/NOTE |
| APPROVED:      |      | R.ADDE      |        |
| CHECKED:       |      | M.G.PLESTED |        |
| DRAWN:         |      | R.ADDE      |        |
| CUSTOMER REF.: |      |             |        |
| ASSEMBLY DRG:  |      |             |        |

**HARWIN**

HARWIN USA  
TEL: 603 893 5376  
FAX: 603 893 5396  
mis@harwin.com

HARWIN Europe (UK)  
TEL: 023 9231 4545  
FAX: 023 9231 4590  
mis@harwin.co.uk

HARWIN Asia  
TEL: +65 6 779 4909  
FAX: +65 6 779 3868  
mis@harwin.com.sg

THIS DRAWING AND ANY INFORMATION OR DESCRIPTIVE MATTER SET OUT HEREON ARE CONFIDENTIAL AND COPYRIGHT PROPERTY OF THE HARWIN GROUP AND MUST NOT BE DISCLOSED, LOANED, COPIED OR USED FOR MANUFACTURING, TENDERING OR FOR ANY OTHER PURPOSE WITHOUT THEIR WRITTEN PERMISSION.

**TOLERANCES**

X. = ±1mm  
X.X = ±0.25mm  
X.XX = ±0.10mm  
X.XXX = ±0.01mm

ANGLES = ±5°  
UNLESS STATED

**MATERIAL:**

SEE ABOVE

FINISH: SEE ABOVE

S/AREA: mm<sup>2</sup>

**TITLE:**

END CAP AND CHAIN

**DRAWING NUMBER:**

M90-25042-1XXX

SHT  
2  
OF  
2