

# Customer Information Sheet

DRAWING No.: M50-310XX45P

SHEET 3 OF 3

IF IN DOUBT - ASK

(C)

NOT TO SCALE

THIRD ANGLE PROJECTION

ALL DIMENSIONS IN mm

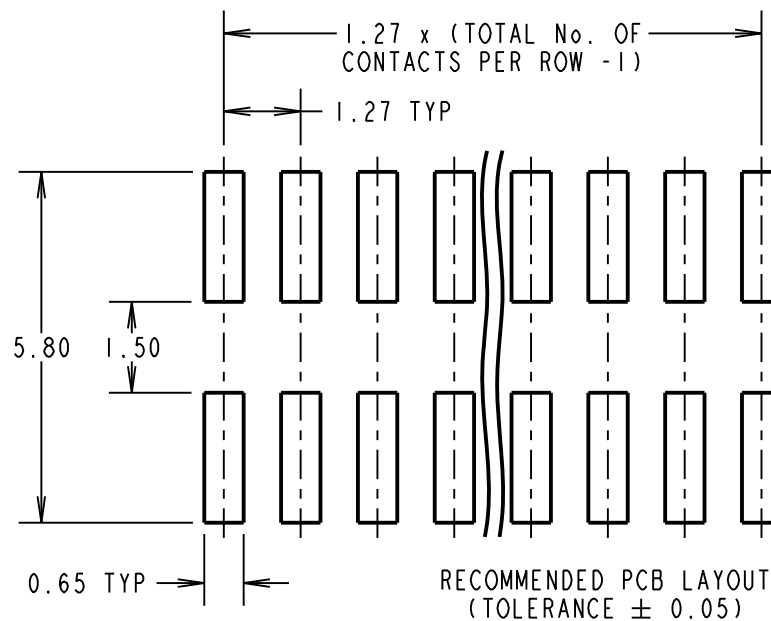
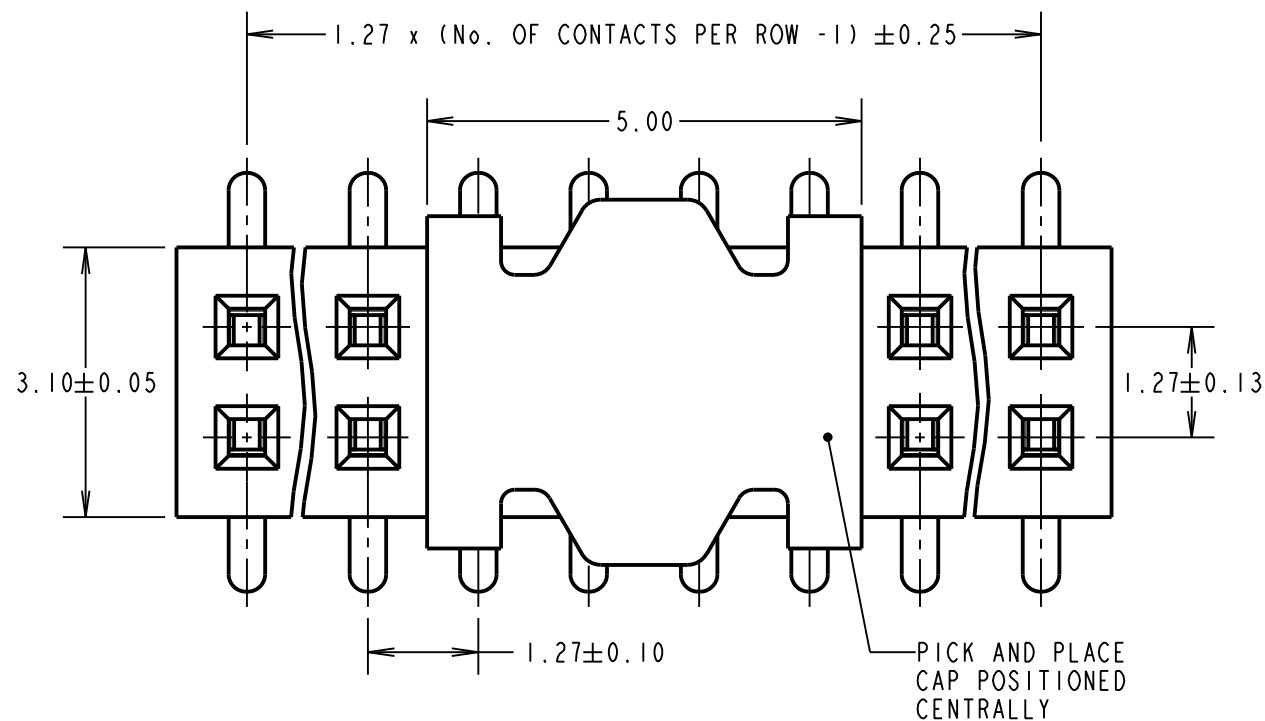

**SPECIFICATIONS:**

**MATERIAL:**

MOULDING = NYLON 6T UL94V-0, BLACK  
 CONTACT = PHOSPHOR BRONZE

**FINISH:**

CONTACT = GOLD FLASH OVER NICKEL

**ELECTRICAL:**

VOLTAGE RATING = 250V AC/DC  
 CURRENT RATING = 1A  
 VOLTAGE PROOF = 300V AC, 500V DC FOR ONE MINUTE  
 CONTACT RESISTANCE =  $20\text{m}\Omega$  MAX INITIAL,  
 $30\text{m}\Omega$  MAX AFTER CONDITIONING

INSULATION RESISTANCE =  $1000\text{M}\Omega$  MIN

**MECHANICAL:**

DURABILITY = 100 CYCLES  
 INSERTION FORCE = 2N MAX PER CONTACT  
 WITHDRAWAL FORCE = 0.15N MIN PER CONTACT

**ENVIRONMENTAL:**

OPERATING TEMPERATURE =  $-40^\circ\text{C}$  TO  $+105^\circ\text{C}$

**PACKING:**

TUBE  
 FOR COMPLETE SPECIFICATION, SEE COMPONENT SPECIFICATION C029XX (LATEST ISSUE)

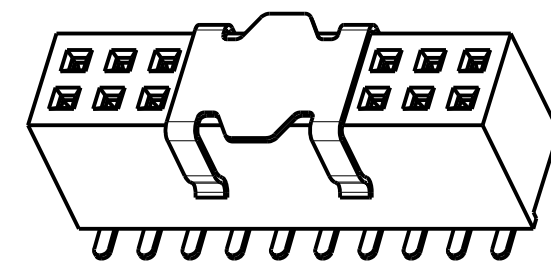
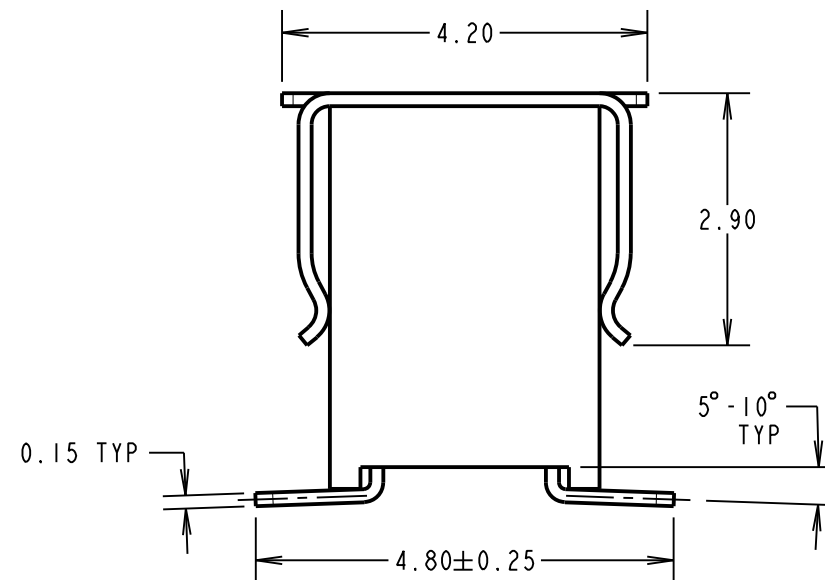
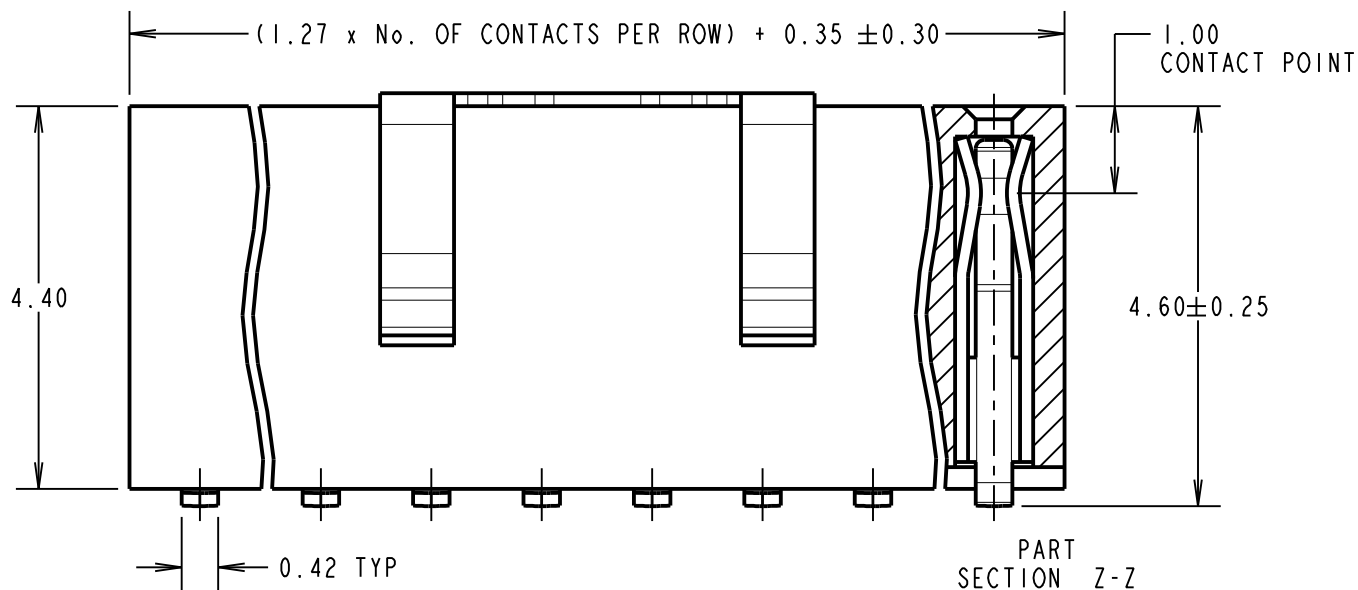

ORDER CODE:

**M50-310XX45P**

No. OF CONTACTS PER ROW: \_\_\_\_\_  
 03 TO 50

FINISH: \_\_\_\_\_  
 GOLD FLASH OVER NICKEL

**NOTES:**

1. ALL TOLERANCES ARE  $\pm 0.12$  UNLESS OTHERWISE STATED.

SB	3	15.01.13	11828
NAME	ISS.	DATE	C/NOTE
APPROVED:		S. BENNETT	
CHECKED:		S. FLOWER	
DRAWN:		JM BROOKES	
CUSTOMER REF.:			
ASSEMBLY DRG:			

**HARWIN**

www.harwin.com  
 technical@harwin.com

THIS DRAWING AND ANY INFORMATION OR DESCRIPTIVE MATTER SET OUT HEREON ARE CONFIDENTIAL AND COPYRIGHT PROPERTY OF THE HARWIN GROUP AND MUST NOT BE DISCLOSED, LOANED, COPIED OR USED FOR MANUFACTURING, TENDERING OR FOR ANY OTHER PURPOSE WITHOUT THEIR WRITTEN PERMISSION.

**TOLERANCES**  
~~X =  $\pm 1\text{mm}$~~   
~~X.X =  $\pm 0.25\text{mm}$~~   
~~X.XX =  $\pm 0.10\text{mm}$~~   
~~X.XXX =  $\pm 0.01\text{mm}$~~   
 ANGLES =  $\pm 5^\circ$   
 UNLESS STATED

**MATERIAL:**

SEE ABOVE

**FINISH:**

SEE ABOVE

**S/AREA:**

mm<sup>2</sup>

**TITLE:** 1.27mm PITCH DIL VERTICAL SMT SOCKET ASSY WITH PICK AND PLACE CAP

**DRAWING NUMBER:**

**M50-310XX45P**

SHT  
 3 OF 3