

## SPECIFICATIONS:

## MATERIAL:-

MOULDING: PBT G.F. UL94V-0, WHITE  
CONTACT: PHOSPHOR BRONZE, T=0.25

## FINISH:-

SELECTIVE GOLD

## ELECTRICAL:-

CURRENT RATING: 1.5 AMP

WORKING VOLTAGE: 30V AC/DC

WITHSTANDING VOLTAGE: 500V AC/MINUTE

CONTACT RESISTANCE: 30 mΩ MAX.

INSULATION RESISTANCE: 1000 MΩ MIN.

## MECHANICAL:-

DURABILITY: 1500 CYCLES MIN.

MATING FORCE: 35N MAX.

WITHDRAWAL FORCE: 10N MIN.

## ENVIRONMENTAL:-

TEMPERATURE RANGE: -55°C TO +85°C

NOTES: ALL DIMENSIONS AND NOTES  
MARKED \* ARE CRITICAL AND  
MUST BE CHECKED IN ACCORDANCE  
WITH QUALITY DOC. Q1-02A

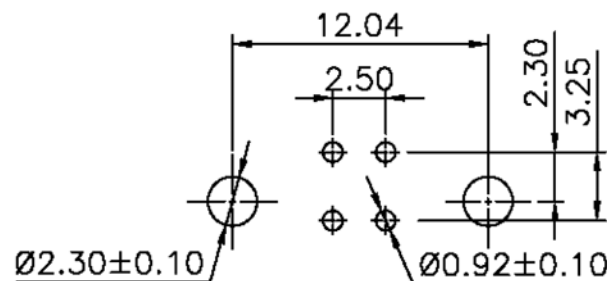

Recommended PCB Layout

Allan	2	15.07.07	A220
Allan	1	01.08.06	-
NAME	ISS.	DATE	C/NOTE
APPROVED: <i>Pran</i>			
CHECKED: <i>Pran</i>			
DRAWN: Allan			
CUSTOMER REF.:			
ASSEMBLY DRG:			

# HARWIN

HARWIN USA  
TEL: 603 893 5376  
FAX: 603 893 5396  
mis@harwin.com

HARWIN Europe (UK)  
TEL: 023 9231 4545  
FAX: 023 9231 4590  
mis@harwin.co.uk

HARWIN Asia  
TEL: +65 6 779 4909  
FAX: +65 6 779 3868  
mis@harwin.com.sg

THIS DRAWING AND ANY  
INFORMATION OR DESCRIPTIVE  
MATTER SET OUT HEREON ARE  
CONFIDENTIAL AND COPYRIGHT  
PROPERTY OF THE HARWIN  
GROUP AND MUST NOT BE  
DISCLOSED, LOANED, COPIED  
OR USED FOR MANUFACTURING,  
TENDERING OR FOR ANY  
OTHER PURPOSE WITHOUT  
THEIR WRITTEN PERMISSION.

## TOLERANCES

X. = ±0.5mm  
X.X = ±0.38mm  
X.XX = ±0.13mm  
X.XXX = ±0.05mm

ANGLES = ±5°  
UNLESS STATED

## MATERIAL:

SEE NOTES

## FINISH:

SEE NOTES

## S/AREA:

mm<sup>2</sup>

## TITLE:

USB B TYPE FEMALE DIP 180°

## DRAWING NUMBER:

M701-330442

SHT  
1  
OF  
1