

MOLEX P/N	CONTACT PLATING	DIM "B"	P.C.B THICKNESS
87715-9900	GOLD 15	3.00	2.36
87715-9901	MICROINCH	2.54	1.58
87715-9922	GOLD 30	2.54	1.58
87715-9923	MICROINCH	3.00	2.36

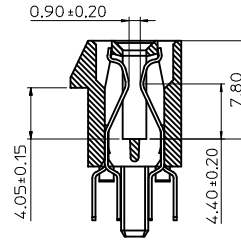

SECTION A-A

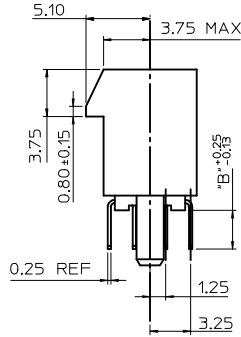
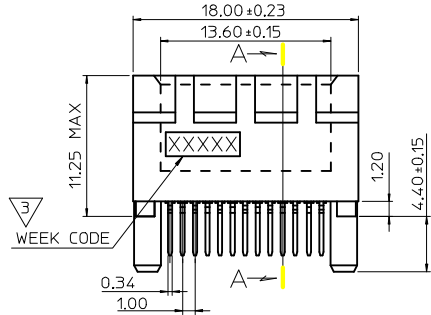
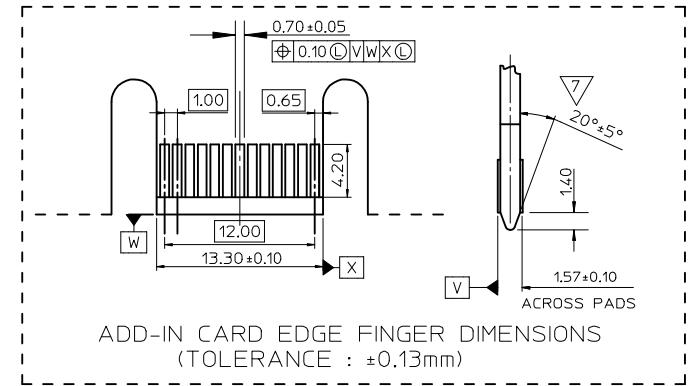
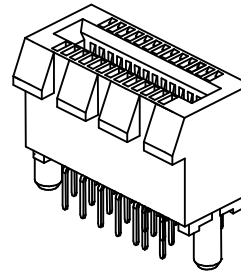
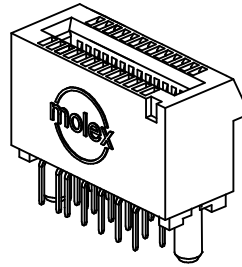

- NOTES:
- MATERIALS:
HOUSING: NYLON 46, GLASS FIBER FILLED UL94V-0
COLOR:BLACK
TERMINAL: PHOSPHOR BRONZE
 - PLATING:
TERMINAL :
CONTACT AREA: SEE TABLE
SOLDER TAIL: TIN, THICKNESS = 100 MICROINCH MIN.
UNDER PLATING: NICKEL OVERALL
 - WEEK CODE: XX(YEAR), XX(WEEK), X(LOCATION)
 - PRODUCT SPECIFICATION REFER TO PS-87715-200
 - PACKAGE SPECIFICATION REFER TO PK-87715-201
 - TEST SUMMARY: REFER TO TS-87715-209
 - CHAMFER EDGES MUST BE FREE OF CUTTING BURRS.
 - LEAD FREE AND ROHS COMPLIANCE PRODUCT.

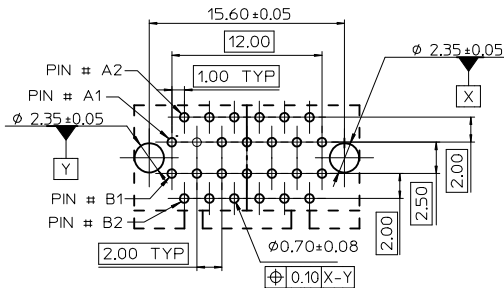
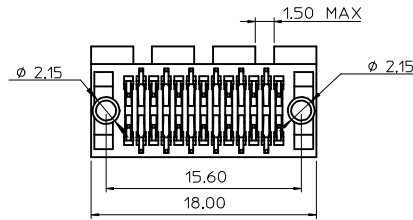

RECOMMENDED PCB LAYOUT

NEW RELEASED
EC NO: SH2006-0194
DRAWN:ALL IN 2006/04/18
CHKD: 2006/04/18
APPR:WWSCHANG 2006/04/18

QUALITY SYMBOLS
▽=0
◁=0

GENERAL TOLERANCES (UNLESS SPECIFIED)

	mm	INCH
4 PLACES	± ---	± ---
3 PLACES	± ---	± ---
2 PLACES	± 0.25	± ---
1 PLACE	± 0.25	± ---

ANGULAR ± 3 °

DRAFT WHERE APPLICABLE
MUST REMAIN
WITHIN DIMENSIONS

DIMENSION STYLE
MM/IN

DRAWN BY
TOM

DATE
2005/03/15

CHECKED BY
ALL IN

DATE
2005/03/15

APPROVED BY
WWSCHANG

DATE
2005/03/15

MATERIAL NO.
SEE TABLE

SIZE
A 4

SCALE

DESIGN UNITS
METRIC

THIRD ANGLE PROJECTION

TITLE
1.00MM PITCH EDGE CARD
26 PIN VERT CONNECTOR
(LEAD FREE VERSION)

MOLEX MOLEX INCORPORATED

DOCUMENT NO.
SD-87715-209

SHEET NO.
1 OF 1