

MATERIALS AND FINISHES

SMA JACK:
SEE SD-73391-026

MCX PLUG:
SEE SD-73366-001

CABLE: RG316

SHRINK TUBE: VERSAFIT OR
EQUIVALENT

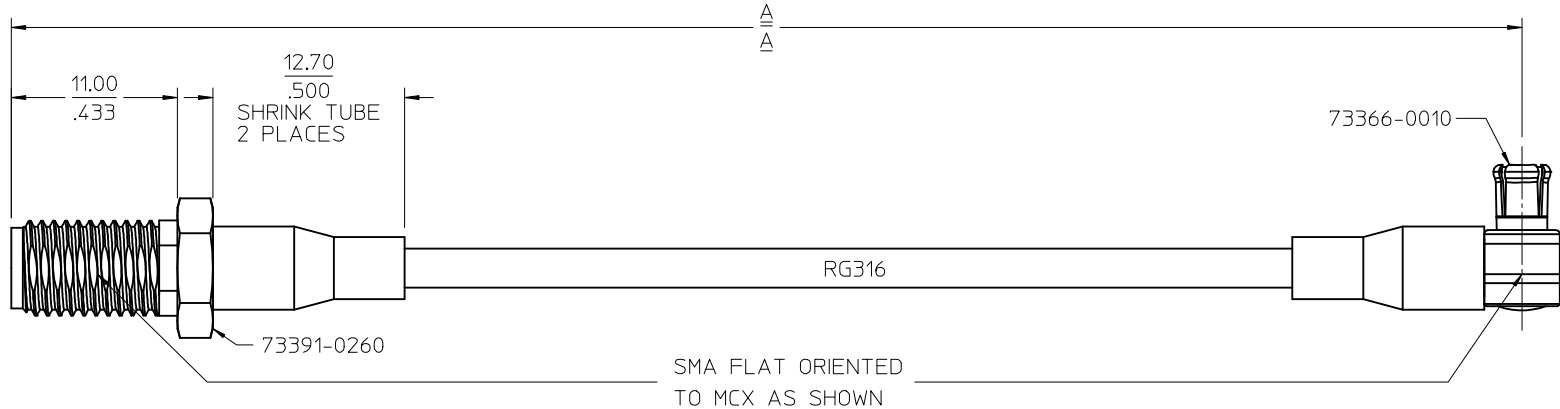
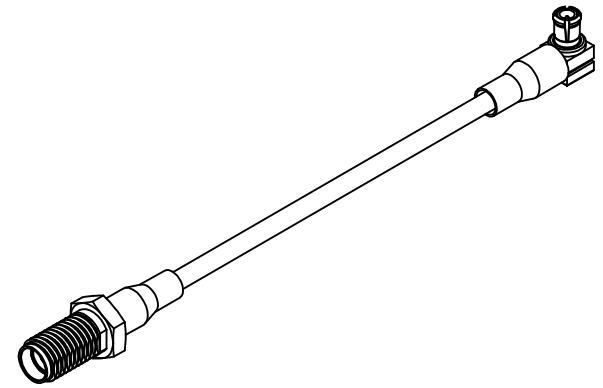

SMA FLAT ORIENTED
TO MCX AS SHOWN

CABLES WILL BE INDIVIDUALLY BAGGED

BAG LABEL:
MOLEX: P/N
DATE CODE

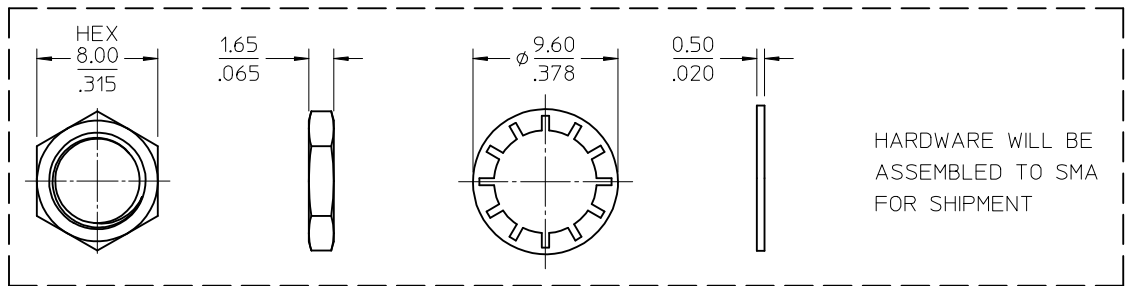

89761-6772	18.00±.35	457.20±8.89	POLYBAG
89761-6771	12.00±.25	304.80±6.35	POLYBAG
89761-6770	6.00±.25	152.40±6.35	POLYBAG
PART NO.	IN	MM	PACKAGING
	DIM A	DIM A	

CECC-22-220	INTERFACE MCX
MIL-STD-348A, FIG. 310.2	INTERFACE SMA
SPECIFICATION	DESCRIPTION

CHG: REGENERATED IN SYSTEM PER RF12-E082 EC NO: URF2013-0035 DRWNR: YEH CHKD: APPR: MHIANG 2012/07/11 2012/07/28 DESCRIPTION REV: A2	QUALITY SYMBOLS ▽=0 ▽=0 ▽=0	GENERAL TOLERANCES (UNLESS SPECIFIED) <table border="1"> <tr> <th></th> <th>mm</th> <th>INCH</th> </tr> <tr> <td>4 PLACES</td> <td>± .005</td> <td>± .0005</td> </tr> <tr> <td>3 PLACES</td> <td>± .005</td> <td>± .0005</td> </tr> <tr> <td>2 PLACES</td> <td>± .005</td> <td>± .0005</td> </tr> <tr> <td>1 PLACE</td> <td>± .005</td> <td>± .0005</td> </tr> <tr> <td>0 PLACE</td> <td>± .005</td> <td>± .0005</td> </tr> </table>		mm	INCH	4 PLACES	± .005	± .0005	3 PLACES	± .005	± .0005	2 PLACES	± .005	± .0005	1 PLACE	± .005	± .0005	0 PLACE	± .005	± .0005	DIMENSION STYLE MM/IN	SCALE 4:1	DESIGN UNITS METRIC	THIRD ANGLE PROJECTION
		mm	INCH																					
	4 PLACES	± .005	± .0005																					
	3 PLACES	± .005	± .0005																					
2 PLACES	± .005	± .0005																						
1 PLACE	± .005	± .0005																						
0 PLACE	± .005	± .0005																						
DRAFT WHERE APPLICABLE MUST REMAIN WITHIN DIMENSIONS		ANGULAR ± 2°	DRAWN BY JDW	DATE 2009/01/08	TITLE CA SMA JACK STR BKHD TO MCX PLUG R/A WITH RG316 CA-SMAJ/MCXP, EWR-3874																			
MATERIAL NO. SEE TABLE		DOCUMENT NO. SD-89761-677		SHEET NO. 1 OF 1																				
THIS DRAWING CONTAINS INFORMATION THAT IS PROPRIETARY TO MOLEX INCORPORATED AND SHOULD NOT BE USED WITHOUT WRITTEN PERMISSION																								