

2 BAY EDGE LINE

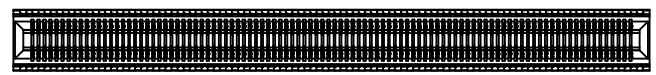

1 BAY EDGE LINE

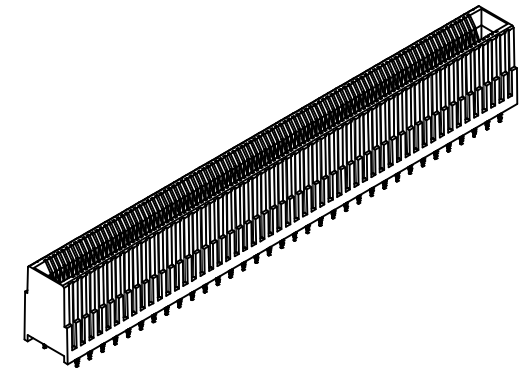
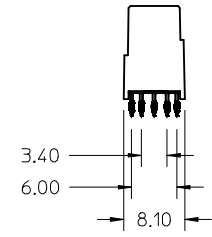
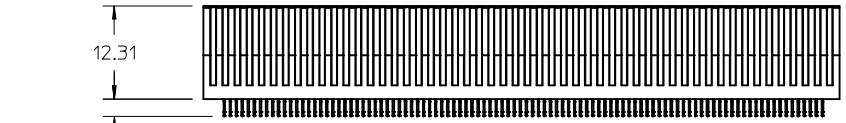

| PART NUMBER | VERSION | BAY 1/BAY 2 | TOTAL CIRCUITS | DIM A | SALES DRAWING (SEE NOTE 9) |
|-------------|---------|-------------|----------------|--------|----------------------------|
| 76693-2294 | 2 BAY | 122/172 | 294 | 125.03 | RSD-76693-110 |
| 76693-2274* | 2 BAY | 122/172 | 294 | 125.03 | RSD-76693-107 |
| 76693-2278 | 2 BAY | 146/132 | 278 | 118.63 | RSD-76693-2278 |
| 76693-1200 | 1 BAY | 200 | 200 | 84.20 | RSD-76693-1200 |
| 76693-1170 | 1 BAY | 170 | 170 | 72.20 | RSD-76693-1170 |
| 76693-3170 | 1 BAY | 170 | 170 | 72.20 | RSD-76693-3170 |

- NOTES:
- MATERIAL:
HOUSING - GLASS FILLED THERMOPLASTIC, 94-VO, BLACK
TERMINALS - COPPER ALLOY
 - FINISH:
CONTACT AREA: HARD GOLD - 0.76μm MIN OVER 3.80μm NICKEL
COMPLIANT AREA: TIN - 0.76/1.52μm OVER NICKEL
 - REFER TO PS-75594-999 PRODUCT SPECIFICATION FOR ALL ELECTRICAL, MECHANICAL AND ENVIRONMENTAL SPECIFICATIONS.
 - REFER TO PK-76693-900 FOR ALL PACKAGING SPECIFICATIONS.
 - PROCESSING: PRESSFIT TO PC BOARD.
 - MATING PC BOARD THICKNESS = 2.36±0.16MM OVER CONTACT PADS.
 - THIS PART CONFORMS TO CLASS B REQUIREMENTS OF COSMETIC SPEC PS-45499-002
 - FOR EDGE CARD AND MOUNTING PCB LAYOUT DETAIL SEE CORRESPONDING SALES DRAWING.

| | | | | | | | |
|--|-------------------------|--|---------------------------------------|---|--|--------------|------------------------|
| INITIAL RELEASE EC NO: UCP2015-1097 DRWR:RWHIPPLE 2014/09/17 CHKD:MPOFF 2014/09/17 APPR:SMILLER 2014/09/29 | DESCRIPTION REV A | QUALITY SYMBOLS | GENERAL TOLERANCES (UNLESS SPECIFIED) | DIMENSION STYLE | SCALE | DESIGN UNITS | THIRD ANGLE PROJECTION |
| | | ▽=0 | mm INCH | MM ONLY | 2:1 | METRIC | |
| | | ▽=0 | 4 PLACES ± --- ± --- | DRAWN BY DATE | EDGELINE 12.5GB 0.093*PCB 0.8MM PITCH | | |
| | | ▽=0 | 3 PLACES ± --- ± --- | RWHIPPLE 2014/09/17 | | | |
| | | ANGULAR ±1/2° | CHECKED BY DATE | molex DOCUMENT NO. RSD-76693-100 SHEET NO. 1 OF 1 | | | |
| | | DRAFT WHERE APPLICABLE MUST REMAIN WITHIN DIMENSIONS | MPOFF 2014/09/17 | | | | |
| | | | APPROVED BY DATE | THIS DRAWING CONTAINS INFORMATION THAT IS PROPRIETARY TO MOLEX INCORPORATED AND SHOULD NOT BE USED WITHOUT WRITTEN PERMISSION | | | |
| | | | SMILLER 2014/09/29 | | | | |
| | | | MATERIAL NO. | | | | |
| | | | SIZE | | | | |

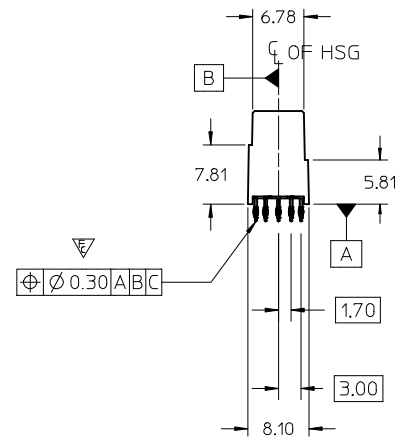
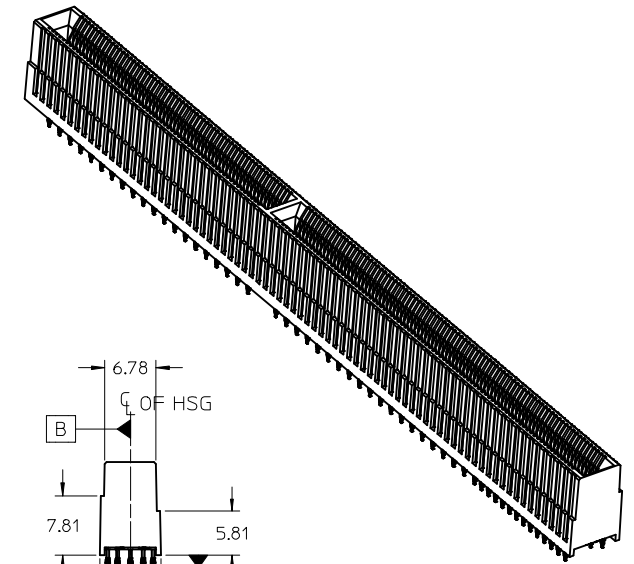
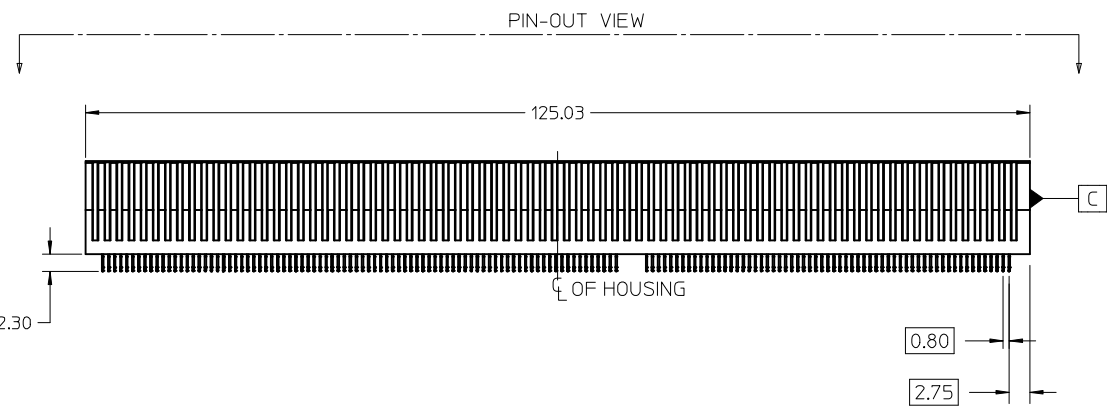
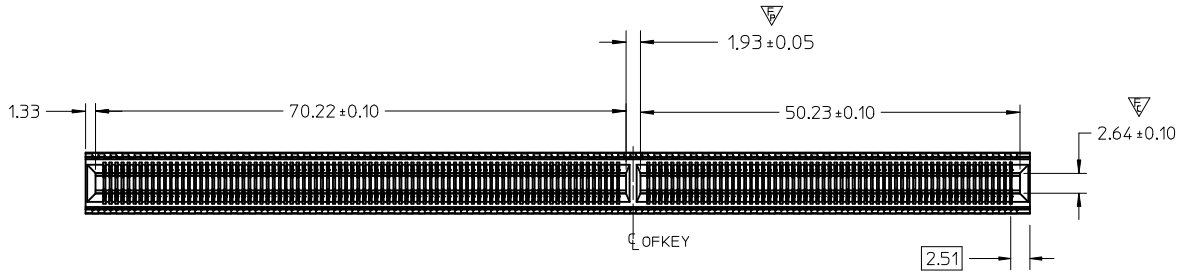

- NOTES:
- MATERIAL:
HOUSING - GLASS FILLED THERMOPLASTIC, 94-V0, BLACK
TERMINALS - COPPER ALLOY
 - FINISH:
CONTACT AREA: HARD GOLD -1.27µm MIN OVER 3.80µ NICKEL
COMPLIANT AREA: TIN - 0.76/1.52µm OVER NICKEL.
 - REFER TO PS-75594-999 PRODUCT SPECIFICATION FOR ALL ELECTRICAL, MECHANICAL AND ENVIRONMENTAL SPECIFICATIONS.
 - TERMINAL LUBRICATION: EB1
 - REFER TO PK-76693-900 FOR ALL PACKAGING SPECIFICATIONS.
 - PROCESSING: PRESSFIT TO PC BOARD.
 - MATING PC BOARD THICKNESS = 2.36±0.16MM OVER CONTACT PADS.
 - THIS PART CONFORMS TO CLASS B REQUIREMENTS OF COSMETIC SPEC PS-45499-002

| | | | | | | | | | | |
|---|--------------------|-----------------|--|------|----------------------------|-------------------------------|--|------------------------|--|--|
| INITIAL RELEASE EC NO: UCP2015-1097 DRWNR:RWHIPPLE 2014/09/17 CHKD:MPOFF 2014/09/17 APPR:SMILLER 2014/09/29 | DESCRIPTION REV | QUALITY SYMBOLS | GENERAL TOLERANCES (UNLESS SPECIFIED) | | DIMENSION STYLE MM ONLY | SCALE 2:1 | DESIGN UNITS METRIC | THIRD ANGLE PROJECTION | | |
| | | ▽=0 | mm | INCH | DRAWN BY RWHIPPLE | DATE 2014/09/17 | TITLE EDGE LINE 12.5GB 0.093"PCB/0.8MM PITCH 294 CIRCUITS | | | |
| | | ▽=2 | 4 PLACES ± --- ± --- | | CHECKED BY MPOFF | DATE 2014/09/17 | | | | |
| | | ▽=1 | 3 PLACES ± --- ± --- | | APPROVED BY SMILLER | DATE 2014/09/29 | | | | |
| A | | ANGULAR ± 2 ° | DRAFT WHERE APPLICABLE MUST REMAIN WITHIN DIMENSIONS | | MATERIAL NO. 766932274 | DOCUMENT NO. RSD-76693-107 | SHEET NO. 1 OF 5 | | | |
| THIS DRAWING CONTAINS INFORMATION THAT IS PROPRIETARY TO MOLEX INCORPORATED AND SHOULD NOT BE USED WITHOUT WRITTEN PERMISSION | | | | | | | | | | |

P.C. BOARD MOUNTING

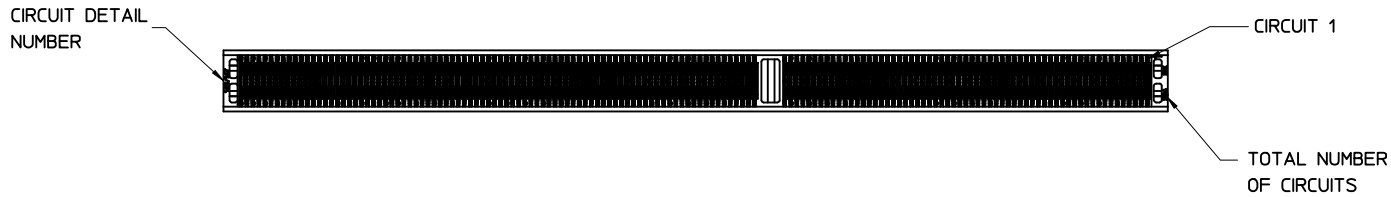
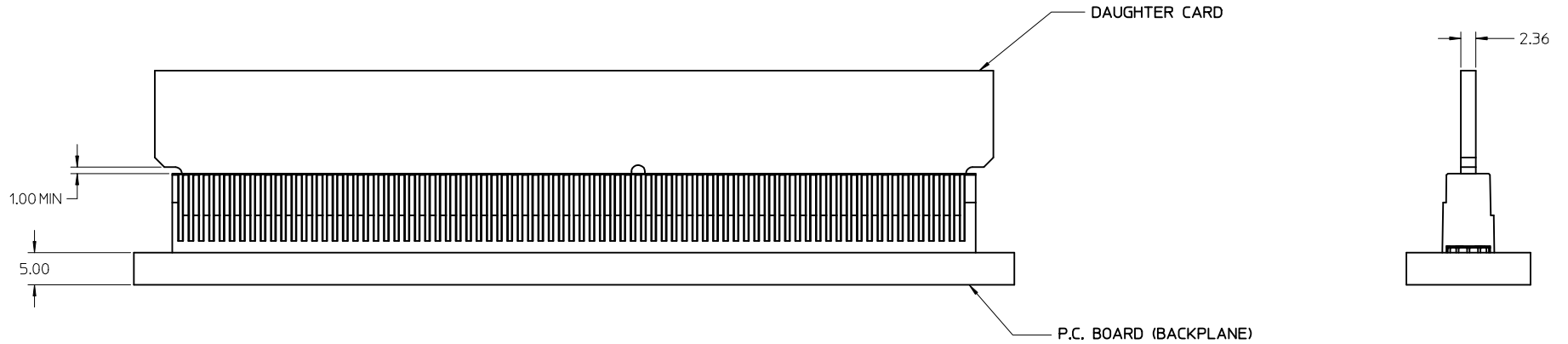

| SEE SHEET 1 EC NO: UCP2015-1097 DRWN:RWHIPPLE 2014/09/17 CHKD:MPOFF 2014/09/17 APPR:SMILLER 2014/09/29 | QUALITY SYMBOLS ▽=0 ▽=0 ▽=0 | GENERAL TOLERANCES (UNLESS SPECIFIED) | DIMENSION STYLE MM ONLY | SCALE 2:1 | DESIGN UNITS METRIC | THIRD ANGLE PROJECTION | | | | | | | | | | | | | | | | | | | |
|--|--------------------------------------|---|---|---|-------------------------------|------------------------|----------|-------|-------|----------|-------|-------|----------|--------|-------|---------|--------|-------|---------|-------|-------|---|---|--|--|
| | | | <table border="1" style="width: 100%; border-collapse: collapse;"> <thead> <tr> <th></th> <th>mm</th> <th>INCH</th> </tr> </thead> <tbody> <tr> <td>4 PLACES</td> <td>± ---</td> <td>± ---</td> </tr> <tr> <td>3 PLACES</td> <td>± ---</td> <td>± ---</td> </tr> <tr> <td>2 PLACES</td> <td>± 0.13</td> <td>± ---</td> </tr> <tr> <td>1 PLACE</td> <td>± 0.25</td> <td>± ---</td> </tr> <tr> <td>0 PLACE</td> <td>± ---</td> <td>± ---</td> </tr> </tbody> </table> | | mm | INCH | 4 PLACES | ± --- | ± --- | 3 PLACES | ± --- | ± --- | 2 PLACES | ± 0.13 | ± --- | 1 PLACE | ± 0.25 | ± --- | 0 PLACE | ± --- | ± --- | DRAWN BY DATE RWHIPPLE 2014/09/17 CHECKED BY DATE MPOFF 2014/09/17 APPROVED BY DATE SMILLER 2014/09/29 | TITLE EDGE LINE 12.5GB 0.093*PCB/0.8MM PITCH 294 CIRCUITS | | |
| | | mm | INCH | | | | | | | | | | | | | | | | | | | | | | |
| | 4 PLACES | ± --- | ± --- | | | | | | | | | | | | | | | | | | | | | | |
| 3 PLACES | ± --- | ± --- | | | | | | | | | | | | | | | | | | | | | | | |
| 2 PLACES | ± 0.13 | ± --- | | | | | | | | | | | | | | | | | | | | | | | |
| 1 PLACE | ± 0.25 | ± --- | | | | | | | | | | | | | | | | | | | | | | | |
| 0 PLACE | ± --- | ± --- | | | | | | | | | | | | | | | | | | | | | | | |
| | | ANGULAR ± 2 ° DRAFT WHERE APPLICABLE MUST REMAIN WITHIN DIMENSIONS | MATERIAL NO. SEE SHEET 1 | DOCUMENT NO. RSD-76693-107 | SHEET NO. 2 OF 5 | | | | | | | | | | | | | | | | | | | | |
| A | REV | | SIZE C | THIS DRAWING CONTAINS INFORMATION THAT IS PROPRIETARY TO MOLEX INCORPORATED AND SHOULD NOT BE USED WITHOUT WRITTEN PERMISSION | | | | | | | | | | | | | | | | | | | | | |

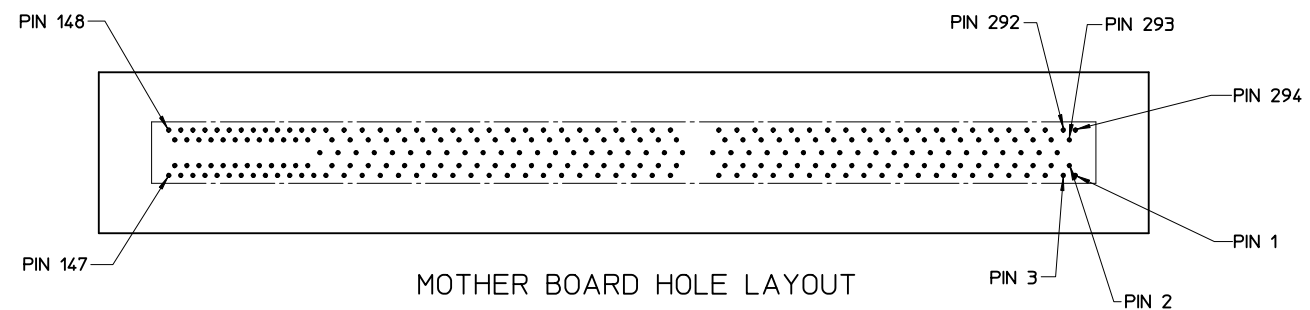
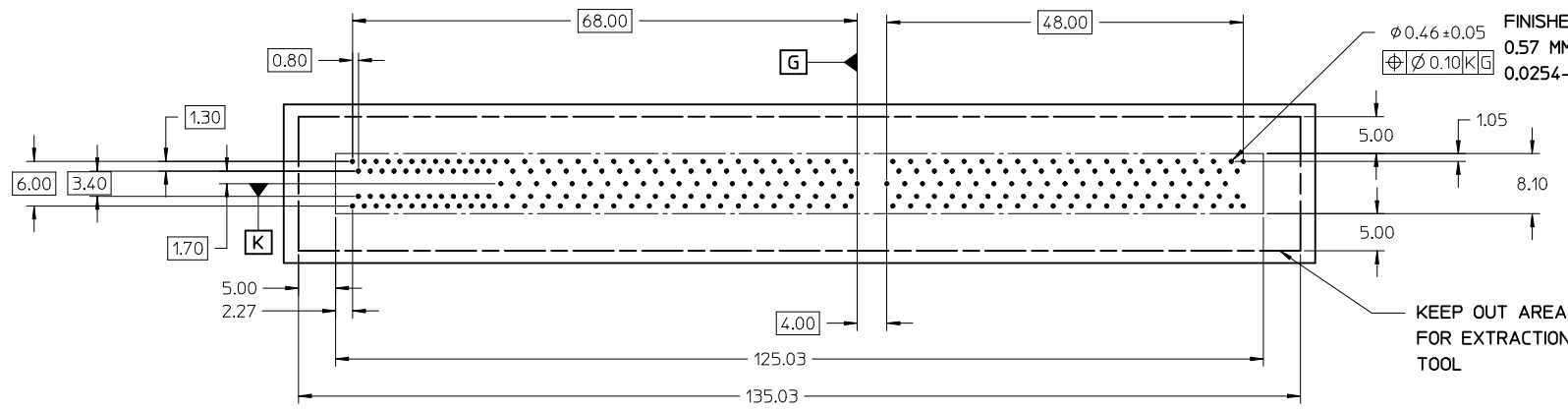

MOTHER BOARD HOLE LAYOUT
(COMPONENT SIDE)

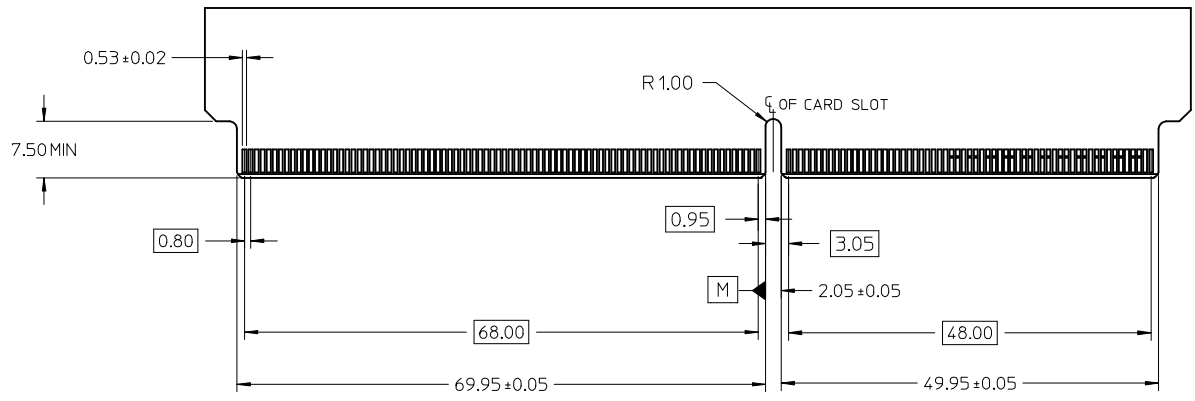

DAUGHTER CARD

| | | | | | |
|--|---|---|--|---|---|
| SEE SHEET 1 EC NO: UCP2015-1097 DRWR:RWHIPPLE 2014/09/17 CHKD:MPOFF 2014/09/17 APPR:SMILLER 2014/09/29 REV: A | QUALITY SYMBOLS $\nabla = 0$ $\nabla = 0$ $\nabla = 0$ | GENERAL TOLERANCES (UNLESS SPECIFIED) mm INCH 4 PLACES ± --- ± --- 3 PLACES ± --- ± --- 2 PLACES ± 0.13 ± --- 1 PLACE ± 0.25 ± --- 0 PLACE ± --- ± --- ANGULAR ± 2 ° | DIMENSION STYLE MM ONLY DRAWN BY DATE RWHIPPLE 2014/09/17 CHECKED BY DATE MPOFF 2014/09/17 APPROVED BY DATE SMILLER 2014/09/29 MATERIAL NO. SEE SHEET 1 | SCALE 2:1 DESIGN UNITS METRIC THIRD ANGLE PROJECTION | TITLE EDGE LINE 12.5GB 0.093*PCB/0.8MM PITCH 294 CIRCUITS molex DOCUMENT NO. RSD-76693-107 SHEET NO. 3 OF 5 |
| | DRAFT WHERE APPLICABLE MUST REMAIN WITHIN DIMENSIONS | | SIZE C | THIS DRAWING CONTAINS INFORMATION THAT IS PROPRIETARY TO MOLEX INCORPORATED AND SHOULD NOT BE USED WITHOUT WRITTEN PERMISSION | |

| LEGEND 294 CIRCUITS / 0.093"PCB BAY1 | | | | | |
|--------------------------------------|-----------------|-----------------|------------------|---------|--|
| COMPONENT SIDE 1 | | | COMPONENT SIDE 2 | | |
| PIN NO. | SIGNAL | ALLEGRO PIN NO. | SIGNAL | PIN NO. | |
| 294 | Low Freq | ○ | Low Freq | 1 | |
| 293 | Low Freq | ○ | Low Freq | 2 | |
| 292 | Low Freq | ○ | Low Freq | 3 | |
| 291 | VR | ○ | VR | 4 | |
| 290 | Signal + | ○ | Signal + | 5 | |
| 289 | Signal - | ○ | Signal - | 6 | |
| 288 | GND/ Pwr Return | ○ | GND/ Pwr Return | 7 | |
| 287 | Signal + | ○ | Signal + | 8 | |
| 286 | Signal - | ○ | Signal - | 9 | |
| 285 | VR | ○ | VR | 10 | |
| 284 | Signal + | ○ | Signal + | 11 | |
| 283 | Signal - | ○ | Signal - | 12 | |
| 282 | GND/ Pwr Return | ○ | GND/ Pwr Return | 13 | |
| 281 | Signal + | ○ | Signal + | 14 | |
| 280 | Signal - | ○ | Signal - | 15 | |
| 279 | VR | ○ | VR | 16 | |
| 278 | Signal + | ○ | Signal + | 17 | |
| 277 | Signal - | ○ | Signal - | 18 | |
| 276 | GND/ Pwr Return | ○ | GND/ Pwr Return | 19 | |
| 275 | Signal + | ○ | Signal + | 20 | |
| 274 | Signal - | ○ | Signal - | 21 | |
| 273 | VR | ○ | VR | 22 | |
| 272 | Signal + | ○ | Signal + | 23 | |
| 271 | Signal - | ○ | Signal - | 24 | |
| 270 | GND/ Pwr Return | ○ | GND/ Pwr Return | 25 | |
| 269 | Signal + | ○ | Signal + | 26 | |
| 268 | Signal - | ○ | Signal - | 27 | |
| 267 | VR | ○ | VR | 28 | |
| 266 | Signal + | ○ | Signal + | 29 | |
| 265 | Signal - | ○ | Signal - | 30 | |
| 264 | GND/ Pwr Return | ○ | GND/ Pwr Return | 31 | |
| 263 | Signal + | ○ | Signal + | 32 | |
| 262 | Signal - | ○ | Signal - | 33 | |
| 261 | VR | ○ | VR | 34 | |
| 260 | Signal + | ○ | Signal + | 35 | |
| 259 | Signal - | ○ | Signal - | 36 | |
| 258 | GND/ Pwr Return | ○ | GND/ Pwr Return | 37 | |
| 257 | Signal + | ○ | Signal + | 38 | |
| 256 | Signal - | ○ | Signal - | 39 | |
| 255 | VR | ○ | VR | 40 | |
| 254 | Signal + | ○ | Signal + | 41 | |
| 253 | Signal - | ○ | Signal - | 42 | |
| 252 | GND/ Pwr Return | ○ | GND/ Pwr Return | 43 | |
| 251 | Signal + | ○ | Signal + | 44 | |
| 250 | Signal - | ○ | Signal - | 45 | |
| 249 | VR | ○ | VR | 46 | |
| 248 | Signal + | ○ | Signal + | 47 | |
| 247 | Signal - | ○ | Signal - | 48 | |
| 246 | GND/ Pwr Return | ○ | GND/ Pwr Return | 49 | |
| 245 | Signal + | ○ | Signal + | 50 | |
| 244 | Signal - | ○ | Signal - | 51 | |
| 243 | VR | ○ | VR | 52 | |
| 242 | Signal + | ○ | Signal + | 53 | |
| 241 | Signal - | ○ | Signal - | 54 | |
| 240 | GND/ Pwr Return | ○ | GND/ Pwr Return | 55 | |
| 239 | Signal + | ○ | Signal + | 56 | |
| 238 | Signal - | ○ | Signal - | 57 | |
| 237 | VR | ○ | VR | 58 | |
| 236 | Signal + | ○ | Signal + | 59 | |
| 235 | Signal - | ○ | Signal - | 60 | |
| 234 | GND/ Pwr Return | ○ | GND/ Pwr Return | 61 | |

| LEGEND 294 CIRCUITS / 0.093"PCB BAY2 | | | | | |
|--------------------------------------|-----------------|-----------------|------------------|---------|--|
| COMPONENT SIDE 1 | | | COMPONENT SIDE 2 | | |
| PIN NO. | SIGNAL | ALLEGRO PIN NO. | SIGNAL | PIN NO. | |
| 233 | GND/ Pwr Return | ○ | GND/ Pwr Return | 62 | |
| 232 | Signal + | ○ | Signal + | 63 | |
| 231 | Signal - | ○ | Signal - | 64 | |
| 230 | GND/ Pwr Return | ○ | GND/ Pwr Return | 65 | |
| 229 | Signal + | ○ | Signal + | 66 | |
| 228 | Signal - | ○ | Signal - | 67 | |
| 227 | VR | ○ | VR | 68 | |
| 226 | Signal + | ○ | Signal + | 69 | |
| 225 | Signal - | ○ | Signal - | 70 | |
| 224 | GND/ Pwr Return | ○ | GND/ Pwr Return | 71 | |
| 223 | Signal + | ○ | Signal + | 72 | |
| 222 | Signal - | ○ | Signal - | 73 | |
| 221 | VR | ○ | VR | 74 | |
| 220 | Signal + | ○ | Signal + | 75 | |
| 219 | Signal - | ○ | Signal - | 76 | |
| 218 | GND/ Pwr Return | ○ | GND/ Pwr Return | 77 | |
| 217 | Signal + | ○ | Signal + | 78 | |
| 216 | Signal - | ○ | Signal - | 79 | |
| 215 | VR | ○ | VR | 80 | |
| 214 | Signal + | ○ | Signal + | 81 | |
| 213 | Signal - | ○ | Signal - | 82 | |
| 212 | GND/ Pwr Return | ○ | GND/ Pwr Return | 83 | |
| 211 | Signal + | ○ | Signal + | 84 | |
| 210 | Signal - | ○ | Signal - | 85 | |
| 209 | VR | ○ | VR | 86 | |
| 208 | Signal + | ○ | Signal + | 87 | |
| 207 | Signal - | ○ | Signal - | 88 | |
| 206 | GND/ Pwr Return | ○ | GND/ Pwr Return | 89 | |
| 205 | Signal + | ○ | Signal + | 90 | |
| 204 | Signal - | ○ | Signal - | 91 | |
| 203 | VR | ○ | VR | 92 | |
| 202 | Signal + | ○ | Signal + | 93 | |
| 201 | Signal - | ○ | Signal - | 94 | |
| 200 | GND/ Pwr Return | ○ | GND/ Pwr Return | 95 | |
| 199 | Signal + | ○ | Signal + | 96 | |
| 198 | Signal - | ○ | Signal - | 97 | |
| 197 | VR | ○ | VR | 98 | |
| 196 | Signal + | ○ | Signal + | 99 | |
| 195 | Signal - | ○ | Signal - | 100 | |
| 194 | GND/ Pwr Return | ○ | GND/ Pwr Return | 101 | |
| 193 | Signal + | ○ | Signal + | 102 | |
| 192 | Signal - | ○ | Signal - | 103 | |
| 191 | VR | ○ | VR | 104 | |
| 190 | Signal + | ○ | Signal + | 105 | |
| 189 | Signal - | ○ | Signal - | 106 | |
| 188 | GND/ Pwr Return | ○ | GND/ Pwr Return | 107 | |
| 187 | Signal + | ○ | Signal + | 108 | |
| 186 | Signal - | ○ | Signal - | 109 | |
| 185 | VR | ○ | VR | 110 | |
| 184 | Signal + | ○ | Signal + | 111 | |
| 183 | Signal - | ○ | Signal - | 112 | |
| 182 | GND/ Pwr Return | ○ | GND/ Pwr Return | 113 | |
| 181 | Signal + | ○ | Signal + | 114 | |
| 180 | Signal - | ○ | Signal - | 115 | |

| LEGEND 294 CIRCUITS / 0.093"PCB BAY2 | | | | | |
|--------------------------------------|-----------------|-----------------|------------------|---------|--|
| COMPONENT SIDE 1 | | | COMPONENT SIDE 2 | | |
| PIN NO. | SIGNAL | ALLEGRO PIN NO. | SIGNAL | PIN NO. | |
| 179 | VR | ○ | VR | 116 | |
| 178 | Signal + | ○ | Signal + | 117 | |
| 177 | Signal - | ○ | Signal - | 118 | |
| 176 | GND/ Pwr Return | ○ | GND/ Pwr Return | 119 | |
| 175 | Signal + | ○ | Signal + | 120 | |
| 174 | Signal - | ○ | Signal - | 121 | |
| 173 | GND/ Pwr Return | ○ | GND/ Pwr Return | 122 | |
| 172 | Low Freq | ○ | Low Freq | 123 | |
| 171 | Low Freq | ○ | Low Freq | 124 | |
| 170 | Low Freq | ○ | Low Freq | 125 | |
| 169 | Low Freq | ○ | Low Freq | 126 | |
| 168 | Low Freq | ○ | Low Freq | 127 | |
| 167 | Low Freq | ○ | Low Freq | 128 | |
| 166 | Low Freq | ○ | Low Freq | 129 | |
| 165 | Low Freq | ○ | Low Freq | 130 | |
| 164 | Low Freq | ○ | Low Freq | 131 | |
| 163 | Low Freq | ○ | Low Freq | 132 | |
| 162 | Low Freq | ○ | Low Freq | 133 | |
| 161 | Low Freq | ○ | Low Freq | 134 | |
| 160 | Low Freq | ○ | Low Freq | 135 | |
| 159 | Low Freq | ○ | Low Freq | 136 | |
| 158 | Low Freq | ○ | Low Freq | 137 | |
| 157 | Low Freq | ○ | Low Freq | 138 | |
| 156 | Low Freq | ○ | Low Freq | 139 | |
| 155 | Low Freq | ○ | Low Freq | 140 | |
| 154 | Low Freq | ○ | Low Freq | 141 | |
| 153 | Low Freq | ○ | Low Freq | 142 | |
| 152 | Low Freq | ○ | Low Freq | 143 | |
| 151 | Low Freq | ○ | Low Freq | 144 | |
| 150 | Low Freq | ○ | Low Freq | 145 | |
| 149 | Low Freq | ○ | Low Freq | 146 | |
| 148 | Low Freq | ○ | Low Freq | 147 | |

POLARIZATION KEY

| | | | | | | | | | | |
|---|--|---------------------------------------|---|----------------------------|---|--------------|------------------------|------------------------|--|--|
| SEE SHEET 1 EC NO: UCP2015-1097 DRWNR:WHIPPLE 2014/09/17 CHKD:MPOFF 2014/09/17 APPR:SMILLER 2014/09/29 | QUALITY SYMBOLS | GENERAL TOLERANCES (UNLESS SPECIFIED) | | DIMENSION STYLE MM ONLY | | SCALE 4:1 | DESIGN UNITS METRIC | THIRD ANGLE PROJECTION | | |
| | | 4 PLACES ± --- INCH | DRAWN BY RWHIPPLE | DATE 2014/09/17 | EDGE LINE 12.5GB 0.093"PCB/0.8MM PITCH 294 CIRCUITS | | | | | |
| | | 3 PLACES ± --- INCH | CHECKED BY MPOFF | DATE 2014/09/17 | | | | | | |
| | | 2 PLACES ± 0.13 INCH | APPROVED BY SMILLER | DATE 2014/09/29 | | | | | | |
| 1 PLACE ± 0.25 INCH | ANGULAR ± 2 ° | | SEE SHEET 1 | | DOCUMENT NO. RSD-76693-107 | | SHEET NO. 5 OF 5 | | | |
| 0 PLACE ± --- INCH | DRAFT WHERE APPLICABLE MUST REMAIN WITHIN DIMENSIONS | | THIS DRAWING CONTAINS INFORMATION THAT IS PROPRIETARY TO MOLEX INCORPORATED AND SHOULD NOT BE USED WITHOUT WRITTEN PERMISSION | | | | | | | |

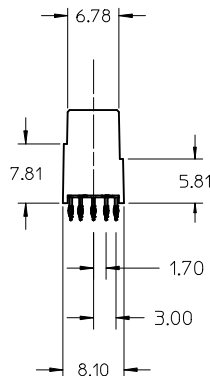
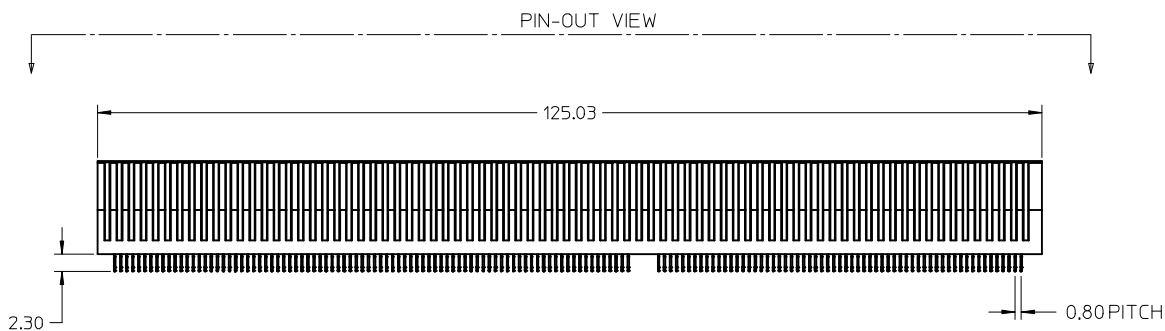
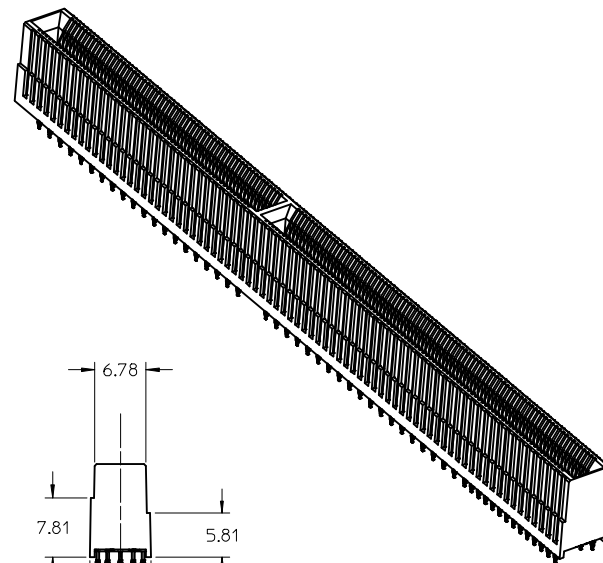
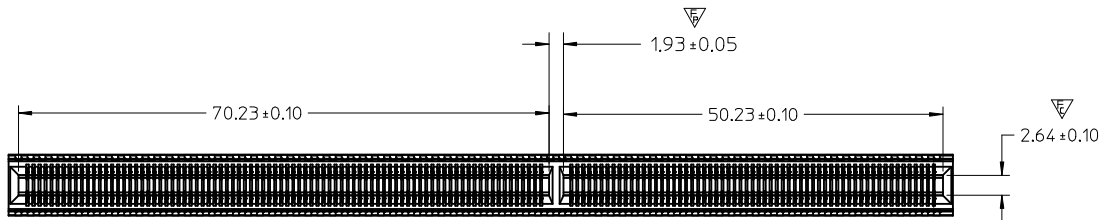

NOTES:

1. MATERIAL:
HOUSING - GLASS FILLED THERMOPLASTIC, 94-V0, BLACK
TERMINALS - COPPER ALLOY
2. FINISH:
CONTACT AREA: HARD GOLD $-0.76\mu\text{m}$ MIN OVER 3.80μ NICKEL
COMPLIANT AREA: TIN - $0.76/1.52\mu\text{m}$ OVER NICKEL.
3. REFER TO PS-75594-999 PRODUCT SPECIFICATION FOR ALL ELECTRICAL, MECHANICAL AND ENVIROMENTAL SPECIFICATIONS.
4. TERMINAL LUBRIFICATION: EB1
5. REFER TO PK-76693-900 FOR ALL PACKAGING SPECIFICATIONS.
6. PROCESSING: PRESSFIT TO PC BOARD.
7. MATING PC BOARD THICKNESS = $2.36\pm 0.16\text{MM}$ OVER CONTACT PADS.
8. THIS PART CONFORMS TO CLASS B REQUIREMENTS OF COSMETIC SPEC PS-45499-002

| INITIAL RELEASE EC NO: UCP2015-1097 DRWNR:RWHIPPLE 2014/09/18 CHKD:MPOFF 2014/09/18 APPR:SMILLER 2014/09/29 | DESCRIPTION REV A | QUALITY SYMBOLS | GENERAL TOLERANCES (UNLESS SPECIFIED) | | DIMENSION STYLE MM ONLY | | SCALE 2:1 | DESIGN UNITS METRIC | THIRD ANGLE PROJECTION | | | | | | | | | | | | | | | | | | | | | | | | | | | |
|---|----------------------|--|---|-----------|-----------------------------------|------|---------------------|-------------------------------|------------------------|-----------|----------|-----------|-----------|----------|------------|-----------|---------|------------|-----------|---------|-----------|-----------|--|----------|------|----------|------------|------------|------|-------|------------|-------------|------|---------|------------|---|
| | | $\nabla=0$ $\nabla=1$ $\nabla=1$ | <table border="1"> <thead> <tr> <th></th> <th>mm</th> <th>INCH</th> </tr> </thead> <tbody> <tr> <td>4 PLACES</td> <td>\pm---</td> <td>\pm---</td> </tr> <tr> <td>3 PLACES</td> <td>\pm---</td> <td>\pm---</td> </tr> <tr> <td>2 PLACES</td> <td>± 0.15</td> <td>\pm---</td> </tr> <tr> <td>1 PLACE</td> <td>± 0.25</td> <td>\pm---</td> </tr> <tr> <td>0 PLACE</td> <td>\pm---</td> <td>\pm---</td> </tr> </tbody> </table> | | mm | INCH | 4 PLACES | \pm --- | | \pm --- | 3 PLACES | \pm --- | \pm --- | 2 PLACES | ± 0.15 | \pm --- | 1 PLACE | ± 0.25 | \pm --- | 0 PLACE | \pm --- | \pm --- | <table border="1"> <thead> <tr> <th>DRAWN BY</th> <th>DATE</th> </tr> </thead> <tbody> <tr> <td>RWHIPPLE</td> <td>2014/09/18</td> </tr> <tr> <th>CHECKED BY</th> <th>DATE</th> </tr> <tr> <td>MPOFF</td> <td>2014/09/18</td> </tr> <tr> <th>APPROVED BY</th> <th>DATE</th> </tr> <tr> <td>SMILLER</td> <td>2014/09/29</td> </tr> </tbody> </table> | DRAWN BY | DATE | RWHIPPLE | 2014/09/18 | CHECKED BY | DATE | MPOFF | 2014/09/18 | APPROVED BY | DATE | SMILLER | 2014/09/29 | TITLE EDGELINE 12.5GB 294CKTS 0.093*PCB 0.8MM PITCH |
| | | | mm | INCH | | | | | | | | | | | | | | | | | | | | | | | | | | | | | | | | |
| | | 4 PLACES | \pm --- | \pm --- | | | | | | | | | | | | | | | | | | | | | | | | | | | | | | | | |
| 3 PLACES | \pm --- | \pm --- | | | | | | | | | | | | | | | | | | | | | | | | | | | | | | | | | | |
| 2 PLACES | ± 0.15 | \pm --- | | | | | | | | | | | | | | | | | | | | | | | | | | | | | | | | | | |
| 1 PLACE | ± 0.25 | \pm --- | | | | | | | | | | | | | | | | | | | | | | | | | | | | | | | | | | |
| 0 PLACE | \pm --- | \pm --- | | | | | | | | | | | | | | | | | | | | | | | | | | | | | | | | | | |
| DRAWN BY | DATE | | | | | | | | | | | | | | | | | | | | | | | | | | | | | | | | | | | |
| RWHIPPLE | 2014/09/18 | | | | | | | | | | | | | | | | | | | | | | | | | | | | | | | | | | | |
| CHECKED BY | DATE | | | | | | | | | | | | | | | | | | | | | | | | | | | | | | | | | | | |
| MPOFF | 2014/09/18 | | | | | | | | | | | | | | | | | | | | | | | | | | | | | | | | | | | |
| APPROVED BY | DATE | | | | | | | | | | | | | | | | | | | | | | | | | | | | | | | | | | | |
| SMILLER | 2014/09/29 | | | | | | | | | | | | | | | | | | | | | | | | | | | | | | | | | | | |
| DRAFT WHERE APPLICABLE MUST REMAIN WITHIN DIMENSIONS | | MATERIAL NO. 766932294 | DOCUMENT NO. RSD-76693-110 | | SHEET NO. 1 OF 5 | | | | | | | | | | | | | | | | | | | | | | | | | | | | | | | |
| THIS DRAWING CONTAINS INFORMATION THAT IS PROPRIETARY TO MOLEX INCORPORATED AND SHOULD NOT BE USED WITHOUT WRITTEN PERMISSION | | | | | | | | | | | | | | | | | | | | | | | | | | | | | | | | | | | | |

P.C. BOARD MOUNTING

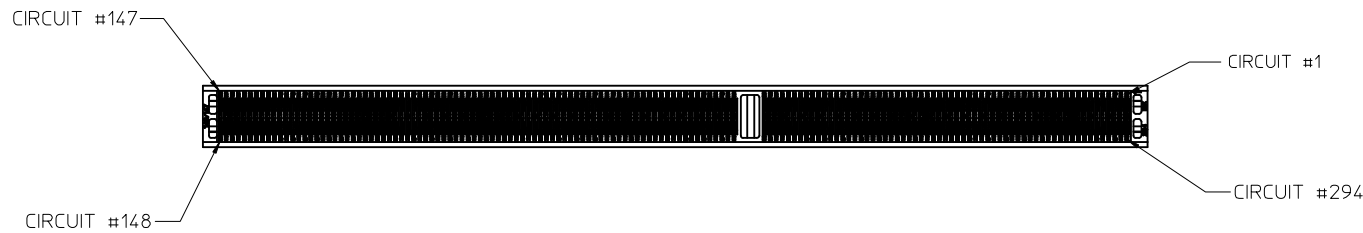
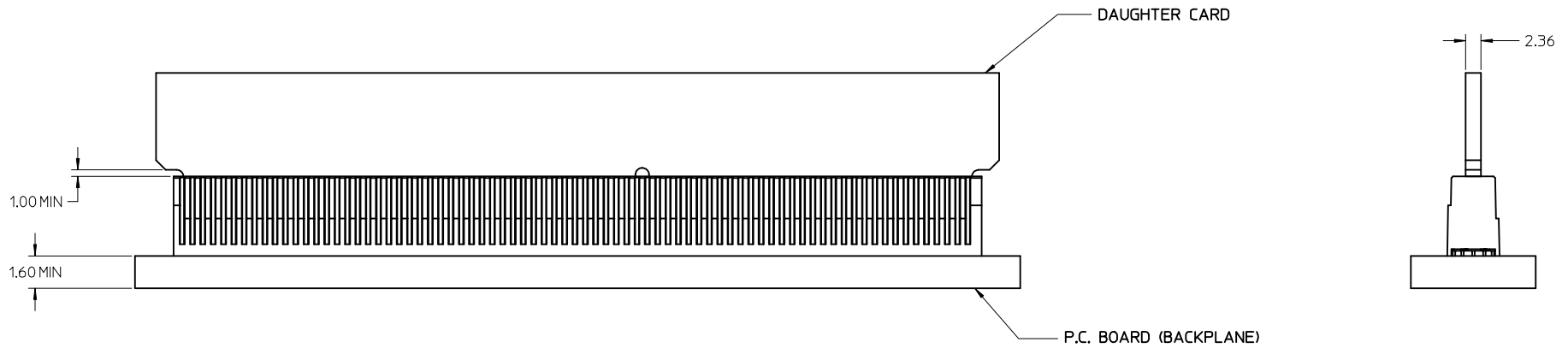

| | | | | | | | | | | | |
|---|----------|-------------------------|--------------------------------------|---------------------------------------|------------|-----------------------------------|------|---------------------|-------------------------------|------------------------|---|
| SEE SHEET 1 EC NO: UCP2015-1097 DRWN:RWHIPPLE 2014/09/18 CHKD:MPOFF 2014/09/18 APPR:SMILLER 2014/09/29 | REV A | DESCRIPTION REV A | QUALITY SYMBOLS ▽=0 ▽=0 ▽=0 | GENERAL TOLERANCES (UNLESS SPECIFIED) | | DIMENSION STYLE MM ONLY | | SCALE 2:1 | DESIGN UNITS METRIC | THIRD ANGLE PROJECTION | |
| | | | | 4 PLACES | ± --- | mm | INCH | DRAWN BY | DATE | | TITLE EDGE LINE 12.5GB 294CKTS 0.093*PCB 0.8MM PITCH |
| | | | | 3 PLACES | ± --- | | | CHECKED BY | DATE | | |
| | | | | 2 PLACES | ± 0.15 | | | MPOFF | 2014/09/18 | | |
| 1 PLACE | ± 0.25 | | | APPROVED BY | DATE | | | | | | |
| 0 PLACE | ± --- | | | SMILLER | 2014/09/29 | | | | | | |
| | | | | ANGULAR ± 2 ° | | MATERIAL NO. | | DOCUMENT NO. | | SHEET NO. | |
| DRAFT WHERE APPLICABLE MUST REMAIN WITHIN DIMENSIONS | | | | SEE SHEET 1 | | RSD-76693-110 | | 2 OF 5 | | | |
| THIS DRAWING CONTAINS INFORMATION THAT IS PROPRIETARY TO MOLEX INCORPORATED AND SHOULD NOT BE USED WITHOUT WRITTEN PERMISSION | | | | | | | | | | | |

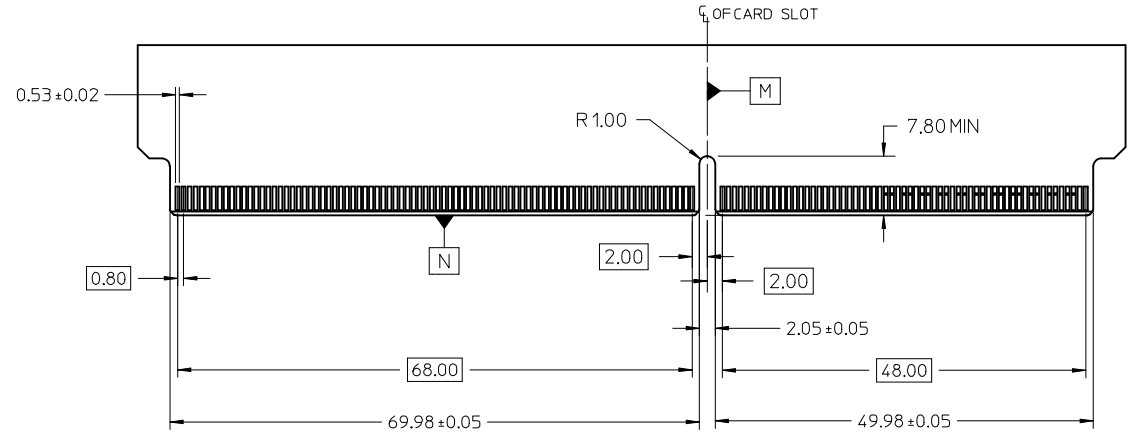
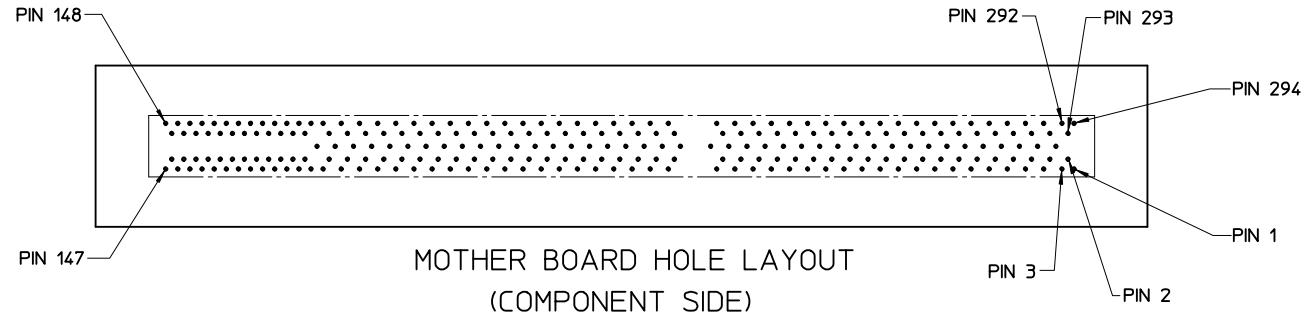
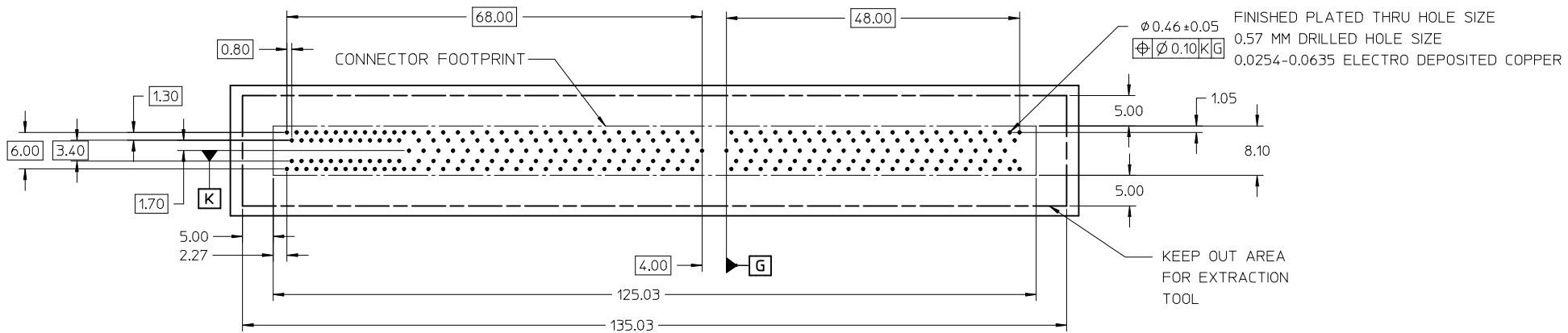

| | | | | | | |
|--|-----------------|--|---------------------|---|--------------|------------------------|
| SEE SHEET 1 EC NO: UCP2015-1097 DRWN:RWHIPPLE 2014/09/18 CHKD:MPOFF 2014/09/18 APPR:SMILLER 2014/09/29 | QUALITY SYMBOLS | GENERAL TOLERANCES (UNLESS SPECIFIED) | DIMENSION STYLE | SCALE | DESIGN UNITS | THIRD ANGLE PROJECTION |
| | ▽=0 | mm INCH | MM ONLY | 2:1 | METRIC | |
| | ▽=0 | 4 PLACES ± --- ± --- | DRAWN BY DATE | TITLE | | |
| | ▽=0 | 3 PLACES ± --- ± --- | RWHIPPLE 2014/09/18 | EDGELINE 12.5GB 294CKTS 0.093*PCB 0.8MM PITCH | | |
| REV | DESCRIPTION | 2 PLACES ± 0.15 ± --- | CHECKED BY DATE | DOCUMENT NO. | | |
| A | | 1 PLACE ± 0.25 ± --- | MPOFF 2014/09/18 | RSD-76693-110 | | |
| | | 0 PLACE ± --- ± --- | APPROVED BY DATE | SHEET NO. | | |
| | | ANGULAR ± 2 ° | SMILLER 2014/09/29 | 3 OF 5 | | |
| | | DRAFT WHERE APPLICABLE MUST REMAIN WITHIN DIMENSIONS | MATERIAL NO. | THIS DRAWING CONTAINS INFORMATION THAT IS PROPRIETARY TO MOLEX INCORPORATED AND SHOULD NOT BE USED WITHOUT WRITTEN PERMISSION | | |
| | | | SEE SHEET 1 | | | |

MODULE EDGE CARD CONTACT DETAIL

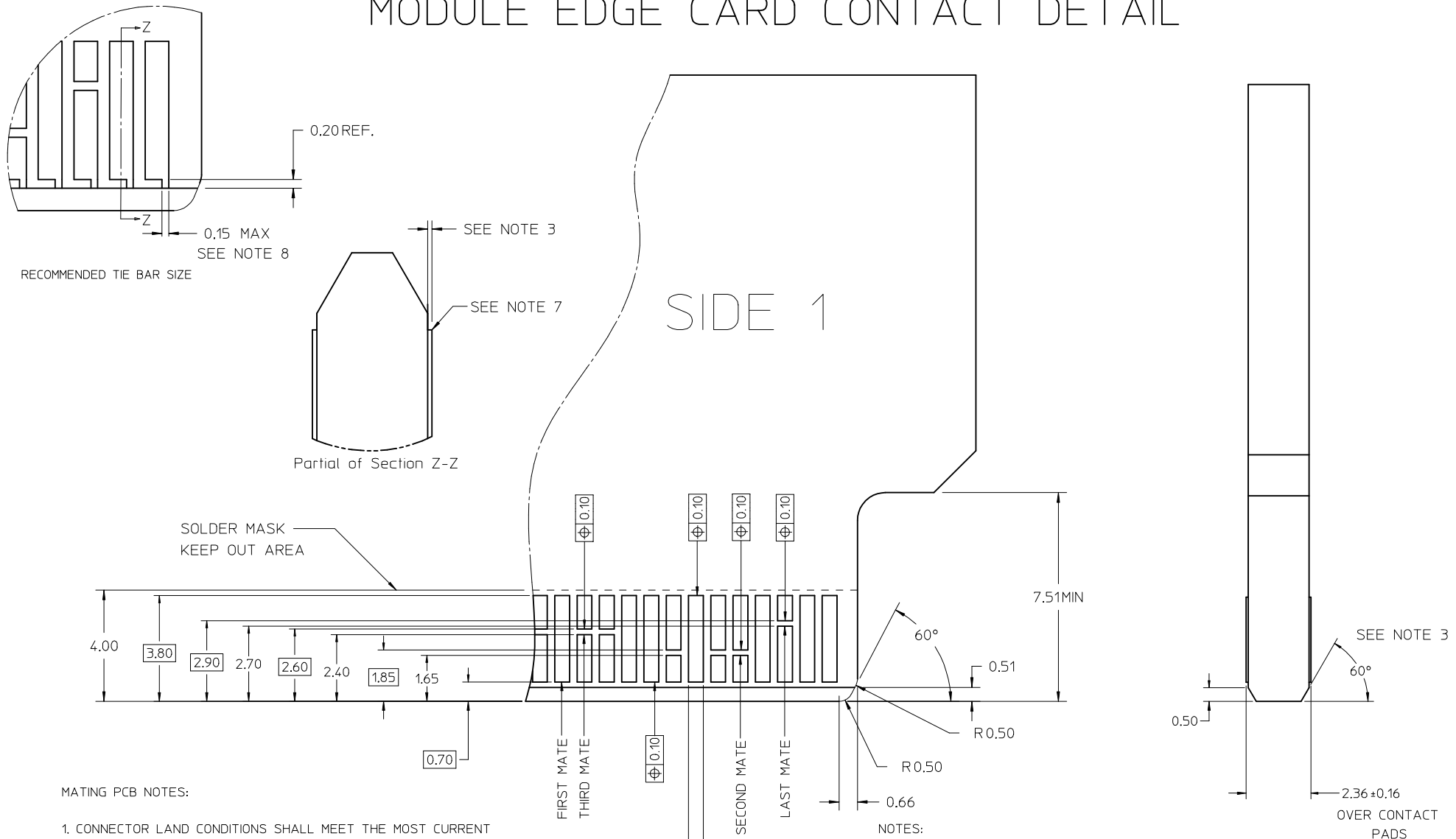

MATING PCB NOTES:

- CONNECTOR LAND CONDITIONS SHALL MEET THE MOST CURRENT REVISION OF PCB SPECIFICATION IPC-6012C-2010 SECTION 3.5.4.4.
- DIMENSIONS APPLY TO LANDS ON BOTH SIDES OF THE BOARD.
- THE THICKNESS OF THE OUTER METAL LAYERS, INCLUDING FOIL, COPPER PLATING, AND THE PROTECTIVE SURFACE FINISH, SHALL BE 0.066mm MAX.
- CHAMFER ROUGHNESS NOT TO EXCEED 3.17 MICROMETERS.
- CHAMFER PROCESS SHALL NOT DAMAGE THE GOLD EDGE LANDS.
- EDGE CARD CHAMFER NOT TO GO THRU GOLD LANDS.
- 0.03mm MAX PLATING OVERHANG ON ALL GOLD LAND EDGES.
- MOLEX RECOMMENDS NO TIE-BARS ON THE LEADING EDGE OF THE GOLD LAND. IF TIE-BARS ARE USED, THEY SHALL BE PLACED TO ONE SIDE OF THE GOLD LAND. APPLIES TO ALL GOLD LANDS.

NOTES:

- THESE ARE GENERIC DETAILS THAT DESCRIBE THE CONFIGURATION OF VARIOUS PCB DESIGN ELEMENTS. THE CUSTOMER MUST DETERMINE WHERE AND WHEN TO USE EACH ELEMENT TO ACCOMMODATE THEIR SPECIFIC APPLICATION.
- EDGE CARD CHAMFER NOT TO GO THRU GOLD PAD OF EDGE CARD

| | | | | | | | | | | |
|---|--------------------------------------|---------------------------------------|--|--|--------------------------------------|----------------------|--|------------------------|--|--|
| SEE SHEET 1 EC NO: UCP2015-1097 DR: RWHIPPLE 2014/09/18 CHK: MPOFF 2014/09/18 APPR: SMILLER 2014/09/29 | QUALITY SYMBOLS ▽=0 ▽=0 ▽=0 | GENERAL TOLERANCES (UNLESS SPECIFIED) | | DIMENSION STYLE MM ONLY | | SCALE 10:1 | DESIGN UNITS METRIC | THIRD ANGLE PROJECTION | | |
| | | 4 PLACES ± --- ± --- | mm | INCH | DRAWN BY RWHIPPLE | DATE 2014/09/18 | TITLE EDGELINE 12.5GB 294CKTS 0.093"PCB 0.8MM PITCH | | | |
| | | 3 PLACES ± --- ± --- | | | CHECKED BY MPOFF | DATE 2014/09/18 | | | | |
| | | 2 PLACES ± 0.15 ± --- | | | APPROVED BY SMILLER | DATE 2014/09/29 | | | | |
| 1 PLACE ± 0.25 ± --- | | | MATERIAL NO. SEE SHEET 1 | | DOCUMENT NO. RSD-76693-110 | | SHEET NO. 4 OF 5 | | | |
| 0 PLACE ± --- ± --- | | | DRAFT WHERE APPLICABLE MUST REMAIN WITHIN DIMENSIONS | | | | | | | |
| | | ANGULAR ± 2 ° | | THIS DRAWING CONTAINS INFORMATION THAT IS PROPRIETARY TO MOLEX. INCORPORATED AND SHOULD NOT BE USED WITHOUT WRITTEN PERMISSION | | | | | | |

| LEGEND 294 CIRCUITS / 0.093"PCB BAY1 | | | | | |
|--------------------------------------|-----------------|-----------------|------------------|---------|--|
| COMPONENT SIDE 1 | | | COMPONENT SIDE 2 | | |
| PIN NO. | SIGNAL | ALLEGRO PIN NO. | SIGNAL | PIN NO. | |
| 294 | Low Freq | ○ | Low Freq | 1 | |
| 293 | Low Freq | ○ | Low Freq | 2 | |
| 292 | Low Freq | ○ | Low Freq | 3 | |
| 291 | VR | ○ | VR | 4 | |
| 290 | Signal + | ○ | Signal + | 5 | |
| 289 | Signal - | ○ | Signal - | 6 | |
| 288 | GND/ Pwr Return | ○ | GND/ Pwr Return | 7 | |
| 287 | Signal + | ○ | Signal + | 8 | |
| 286 | Signal - | ○ | Signal - | 9 | |
| 285 | VR | ○ | VR | 10 | |
| 284 | Signal + | ○ | Signal + | 11 | |
| 283 | Signal - | ○ | Signal - | 12 | |
| 282 | GND/ Pwr Return | ○ | GND/ Pwr Return | 13 | |
| 281 | Signal + | ○ | Signal + | 14 | |
| 280 | Signal - | ○ | Signal - | 15 | |
| 279 | VR | ○ | VR | 16 | |
| 278 | Signal + | ○ | Signal + | 17 | |
| 277 | Signal - | ○ | Signal - | 18 | |
| 276 | GND/ Pwr Return | ○ | GND/ Pwr Return | 19 | |
| 275 | Signal + | ○ | Signal + | 20 | |
| 274 | Signal - | ○ | Signal - | 21 | |
| 273 | VR | ○ | VR | 22 | |
| 272 | Signal + | ○ | Signal + | 23 | |
| 271 | Signal - | ○ | Signal - | 24 | |
| 270 | GND/ Pwr Return | ○ | GND/ Pwr Return | 25 | |
| 269 | Signal + | ○ | Signal + | 26 | |
| 268 | Signal - | ○ | Signal - | 27 | |
| 267 | VR | ○ | VR | 28 | |
| 266 | Signal + | ○ | Signal + | 29 | |
| 265 | Signal - | ○ | Signal - | 30 | |
| 264 | GND/ Pwr Return | ○ | GND/ Pwr Return | 31 | |
| 263 | Signal + | ○ | Signal + | 32 | |
| 262 | Signal - | ○ | Signal - | 33 | |
| 261 | VR | ○ | VR | 34 | |
| 260 | Signal + | ○ | Signal + | 35 | |
| 259 | Signal - | ○ | Signal - | 36 | |
| 258 | GND/ Pwr Return | ○ | GND/ Pwr Return | 37 | |
| 257 | Signal + | ○ | Signal + | 38 | |
| 256 | Signal - | ○ | Signal - | 39 | |
| 255 | VR | ○ | VR | 40 | |
| 254 | Signal + | ○ | Signal + | 41 | |
| 253 | Signal - | ○ | Signal - | 42 | |
| 252 | GND/ Pwr Return | ○ | GND/ Pwr Return | 43 | |
| 251 | Signal + | ○ | Signal + | 44 | |
| 250 | Signal - | ○ | Signal - | 45 | |
| 249 | VR | ○ | VR | 46 | |
| 248 | Signal + | ○ | Signal + | 47 | |
| 247 | Signal - | ○ | Signal - | 48 | |
| 246 | GND/ Pwr Return | ○ | GND/ Pwr Return | 49 | |
| 245 | Signal + | ○ | Signal + | 50 | |
| 244 | Signal - | ○ | Signal - | 51 | |
| 243 | VR | ○ | VR | 52 | |
| 242 | Signal + | ○ | Signal + | 53 | |
| 241 | Signal - | ○ | Signal - | 54 | |
| 240 | GND/ Pwr Return | ○ | GND/ Pwr Return | 55 | |
| 239 | Signal + | ○ | Signal + | 56 | |
| 238 | Signal - | ○ | Signal - | 57 | |
| 237 | VR | ○ | VR | 58 | |
| 236 | Signal + | ○ | Signal + | 59 | |
| 235 | Signal - | ○ | Signal - | 60 | |
| 234 | GND/ Pwr Return | ○ | GND/ Pwr Return | 61 | |

| LEGEND 294 CIRCUITS / 0.093"PCB BAY2 | | | | | |
|--------------------------------------|-----------------|-----------------|------------------|---------|--|
| COMPONENT SIDE 1 | | | COMPONENT SIDE 2 | | |
| PIN NO. | SIGNAL | ALLEGRO PIN NO. | SIGNAL | PIN NO. | |
| 233 | GND/ Pwr Return | ○ | GND/ Pwr Return | 62 | |
| 232 | Signal + | ○ | Signal + | 63 | |
| 231 | Signal - | ○ | Signal - | 64 | |
| 230 | GND/ Pwr Return | ○ | GND/ Pwr Return | 65 | |
| 229 | Signal + | ○ | Signal + | 66 | |
| 228 | Signal - | ○ | Signal - | 67 | |
| 227 | VR | ○ | VR | 68 | |
| 226 | Signal + | ○ | Signal + | 69 | |
| 225 | Signal - | ○ | Signal - | 70 | |
| 224 | GND/ Pwr Return | ○ | GND/ Pwr Return | 71 | |
| 223 | Signal + | ○ | Signal + | 72 | |
| 222 | Signal - | ○ | Signal - | 73 | |
| 221 | VR | ○ | VR | 74 | |
| 220 | Signal + | ○ | Signal + | 75 | |
| 219 | Signal - | ○ | Signal - | 76 | |
| 218 | GND/ Pwr Return | ○ | GND/ Pwr Return | 77 | |
| 217 | Signal + | ○ | Signal + | 78 | |
| 216 | Signal - | ○ | Signal - | 79 | |
| 215 | VR | ○ | VR | 80 | |
| 214 | Signal + | ○ | Signal + | 81 | |
| 213 | Signal - | ○ | Signal - | 82 | |
| 212 | GND/ Pwr Return | ○ | GND/ Pwr Return | 83 | |
| 211 | Signal + | ○ | Signal + | 84 | |
| 210 | Signal - | ○ | Signal - | 85 | |
| 209 | VR | ○ | VR | 86 | |
| 208 | Signal + | ○ | Signal + | 87 | |
| 207 | Signal - | ○ | Signal - | 88 | |
| 206 | GND/ Pwr Return | ○ | GND/ Pwr Return | 89 | |
| 205 | Signal + | ○ | Signal + | 90 | |
| 204 | Signal - | ○ | Signal - | 91 | |
| 203 | VR | ○ | VR | 92 | |
| 202 | Signal + | ○ | Signal + | 93 | |
| 201 | Signal - | ○ | Signal - | 94 | |
| 200 | GND/ Pwr Return | ○ | GND/ Pwr Return | 95 | |
| 199 | Signal + | ○ | Signal + | 96 | |
| 198 | Signal - | ○ | Signal - | 97 | |
| 197 | VR | ○ | VR | 98 | |
| 196 | Signal + | ○ | Signal + | 99 | |
| 195 | Signal - | ○ | Signal - | 100 | |
| 194 | GND/ Pwr Return | ○ | GND/ Pwr Return | 101 | |
| 193 | Signal + | ○ | Signal + | 102 | |
| 192 | Signal - | ○ | Signal - | 103 | |
| 191 | VR | ○ | VR | 104 | |
| 190 | Signal + | ○ | Signal + | 105 | |
| 189 | Signal - | ○ | Signal - | 106 | |
| 188 | GND/ Pwr Return | ○ | GND/ Pwr Return | 107 | |
| 187 | Signal + | ○ | Signal + | 108 | |
| 186 | Signal - | ○ | Signal - | 109 | |
| 185 | VR | ○ | VR | 110 | |
| 184 | Signal + | ○ | Signal + | 111 | |
| 183 | Signal - | ○ | Signal - | 112 | |
| 182 | GND/ Pwr Return | ○ | GND/ Pwr Return | 113 | |
| 181 | Signal + | ○ | Signal + | 114 | |
| 180 | Signal - | ○ | Signal - | 115 | |

| LEGEND 294 CIRCUITS / 0.093"PCB BAY2 | | | | | |
|--------------------------------------|-----------------|-----------------|------------------|---------|--|
| COMPONENT SIDE 1 | | | COMPONENT SIDE 2 | | |
| PIN NO. | SIGNAL | ALLEGRO PIN NO. | SIGNAL | PIN NO. | |
| 179 | VR | ○ | VR | 116 | |
| 178 | Signal + | ○ | Signal + | 117 | |
| 177 | Signal - | ○ | Signal - | 118 | |
| 176 | GND/ Pwr Return | ○ | GND/ Pwr Return | 119 | |
| 175 | Signal + | ○ | Signal + | 120 | |
| 174 | Signal - | ○ | Signal - | 121 | |
| 173 | GND/ Pwr Return | ○ | GND/ Pwr Return | 122 | |
| 172 | Low Freq | ○ | Low Freq | 123 | |
| 171 | Low Freq | ○ | Low Freq | 124 | |
| 170 | Low Freq | ○ | Low Freq | 125 | |
| 169 | Low Freq | ○ | Low Freq | 126 | |
| 168 | Low Freq | ○ | Low Freq | 127 | |
| 167 | Low Freq | ○ | Low Freq | 128 | |
| 166 | Low Freq | ○ | Low Freq | 129 | |
| 165 | Low Freq | ○ | Low Freq | 130 | |
| 164 | Low Freq | ○ | Low Freq | 131 | |
| 163 | Low Freq | ○ | Low Freq | 132 | |
| 162 | Low Freq | ○ | Low Freq | 133 | |
| 161 | Low Freq | ○ | Low Freq | 134 | |
| 160 | Low Freq | ○ | Low Freq | 135 | |
| 159 | Low Freq | ○ | Low Freq | 136 | |
| 158 | Low Freq | ○ | Low Freq | 137 | |
| 157 | Low Freq | ○ | Low Freq | 138 | |
| 156 | Low Freq | ○ | Low Freq | 139 | |
| 155 | Low Freq | ○ | Low Freq | 140 | |
| 154 | Low Freq | ○ | Low Freq | 141 | |
| 153 | Low Freq | ○ | Low Freq | 142 | |
| 152 | Low Freq | ○ | Low Freq | 143 | |
| 151 | Low Freq | ○ | Low Freq | 144 | |
| 150 | Low Freq | ○ | Low Freq | 145 | |
| 149 | Low Freq | ○ | Low Freq | 146 | |
| 148 | Low Freq | ○ | Low Freq | 147 | |

POLARIZATION KEY

| | | | | | | | | | |
|---|---------------------|---------------------------------------|-------|-----------------------------------|--------------------|--|------------------------|------------------------|--------------|
| SEE SHEET 1 EC NO: UCP2015-1097 DRWNR:WHIPPLE 2014/09/18 CHKD:MPOFF 2014/09/18 APPR:SMILLER 2014/09/29 | QUALITY SYMBOLS | GENERAL TOLERANCES (UNLESS SPECIFIED) | | DIMENSION STYLE MM ONLY | | SCALE 4:1 | DESIGN UNITS METRIC | THIRD ANGLE PROJECTION | |
| | | mm | INCH | DRAWN BY RWHIPPLE | DATE 2014/09/18 | EDGELINE 12.5GB 294CKTS 0.093"PCB 0.8MM PITCH molex | | | |
| | | 4 PLACES ± --- | ± --- | CHECKED BY MPOFF | DATE 2014/09/18 | | | | |
| | | ANGULAR ± 2 ° | | APPROVED BY SMILLER | | DATE 2014/09/29 | MATERIAL NO. | | DOCUMENT NO. |
| DRAFT WHERE APPLICABLE MUST REMAIN WITHIN DIMENSIONS | | SEE SHEET 1 | | RSD-76693-110 | | 5 OF 5 | | | |
| THIS DRAWING CONTAINS INFORMATION THAT IS PROPRIETARY TO MOLEX INCORPORATED AND SHOULD NOT BE USED WITHOUT WRITTEN PERMISSION | | | | | | | | | |