

LC 8 PORT ADAPTER		SPLIT SLEEVE
P/N	COLOR	MATERIAL
106121-0200	BLUE	CERAMIC
106121-0201	GREEN	
106121-0202	BEIGE	PHOSPHOR BRONZE
106121-0203	AQUA	

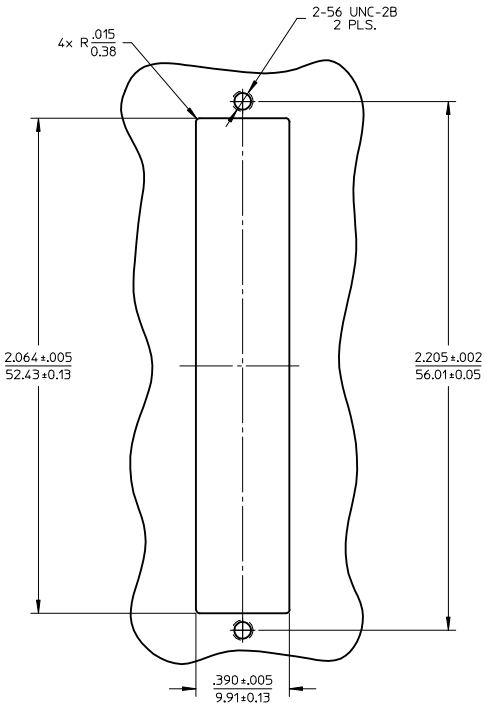

RECOMMENDED  
MOUNTING PATTERN

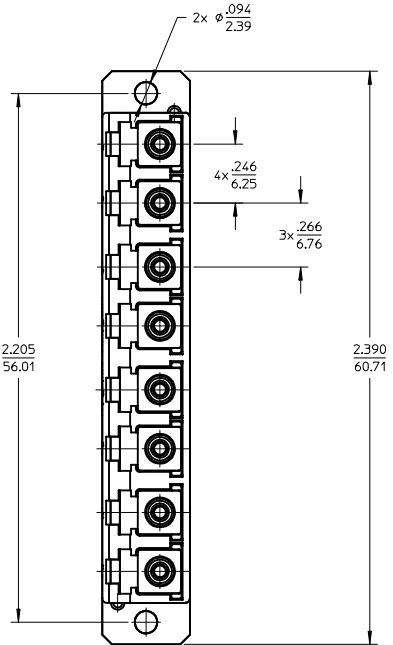
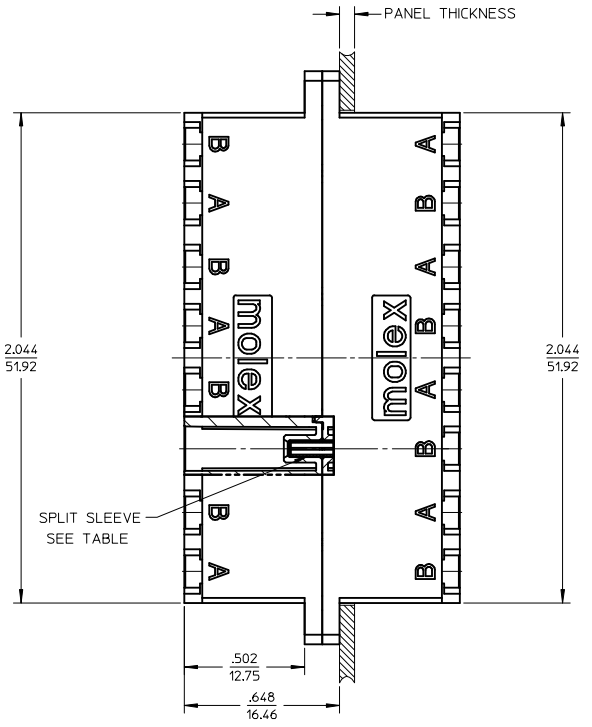
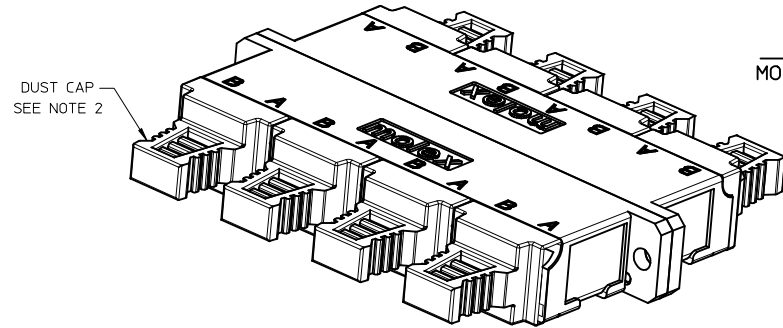
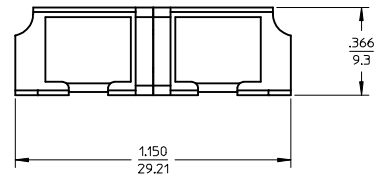

ISO VIEW

NOTES:  
1. ALL DIMENSIONS ARE FOR REFERENCE.  
2. DUST CAPS SHOWN IN ISO VIEW ONLY.

<b>ENTER DESCRIPTION</b> EC NO: MF2015-0403 DRWNSDXIE 2015/06/11 CHKD: 2015/09/25 APPR: WCHEN REV:	<b>QUALITY SYMBOLS</b> ▽=0 ▽=0	<b>GENERAL TOLERANCES (UNLESS SPECIFIED)</b>		<b>DIMENSION STYLE</b> IN/MM	<b>SCALE</b> 2.5:1	<b>DESIGN UNITS</b> INCH	THIRD ANGLE PROJECTION
		4 PLACES ± --- ± --- 3 PLACES ± --- ± --- 2 PLACES ± --- ± --- 1 PLACE ± --- ± ---	mm INCH DRAWN BY YBELENKIY DATE 2011/09/06 CHECKED BY DATE	<b>TITLE</b> LC 8 PORT ADAPTER SCREW MOUNT			
		DRAFT WHERE APPLICABLE MUST REMAIN WITHIN DIMENSIONS		APPROVED BY WCHEN DATE 2012/02/06 MATERIAL NO. SEE TABLE SIZE C	MOLEX MOLEX INCORPORATED DOCUMENT NO. SD-106121-0200	SHEET NO. 1 OF 1	
		THIS DRAWING CONTAINS INFORMATION THAT IS PROPRIETARY TO MOLEX INCORPORATED AND SHOULD NOT BE USED WITHOUT WRITTEN PERMISSION					