

- NOTES:
1. MATERIAL: N - GLASS FILLED POLYESTER, UL94V-0, MOLDED NATURAL
 2. FINISH: SEE TERMINAL DRAWINGS
 3. PRODUCT SPECIFICATION: PS-08-50, PS-40-02, AND PS-45570-001
 4. PACKAGING INFORMATION: SEE LEGEND
 5. MATES WITH (3.96)/.156 CENTER HEADERS AND (1.14)/.045 SQUARE OR ROUND PINS
 6. HOUSING ACCEPTS STANDARD TERMINAL NOS.:
 2478 (18-24 AWG) WITH (2.79)/.110 MAX. INSULATION DIA.
 2578 (22-26 AWG) WITH (1.65)/.065 MAX. INSULATION DIA.
 OR TRIFURCON TERMINAL NOS.:
 6838 (18-24 AWG) WITH (2.79)/.110 MAX. INSULATION DIA.
 7258 (22-26 AWG) WITH (1.65)/.065 MAX. INSULATION DIA.
 OR MARKK TERMINAL NO.:
 45570 (18-20 AWG) WITH (3.12)/.123 MAX. INSULATION DIA.
 7. BOW (.006 MM/MM) / .006 IN/IN.
 8. (0.13)/.005 MAX, FLASH ALLOWED ALONG DIMENSION B AND IN LOCKING WINDOW.
 9. THIS PART CONFORMS TO CLASS B REQUIREMENTS OF COSMETIC SPECIFICATION PS-45499-002.
 10. ALL 7-14 CIRCUIT PARTS AND 2-6 CIRCUIT PARTS MANUFACTURED BEFORE 9/21/2013 HAVE GEOMETRY ON THIS SHEET. SEE SHEET 2 FOR 2-6 CIRCUIT PARTS MANUFACTURED AFTER 9/21/2013.

NO. OF CKTS	DIM. A	DIM. B
2	(8.79) -.348	(3.96+.05) -.156+.002
3	(12.75) -.502	(7.92+.08) -.312+.003
4	(16.71) -.658	(11.89+.08) -.468+.003
5	(20.67) -.814	(15.85+.08) -.624+.003
6	(24.64) -.970	(19.81+.10) -.780+.004
7	(28.60) -1.126	(23.77+.10) -.936+.004
8	(32.56) -1.282	(27.74+.10) -1.092+.004
9	(36.53) -1.438	(31.70+.10) -1.248+.004
10	(40.49) -1.594	(35.66+.15) -1.404+.006
11	(44.45) -1.750	(39.62+.15) -1.560+.006
12	(48.41) -1.906	(43.59+.15) -1.716+.006
13	(52.37) -2.062	(47.55+.15) -1.872+.006
14	(56.34) -2.218	(51.51+.18) -2.028+.007

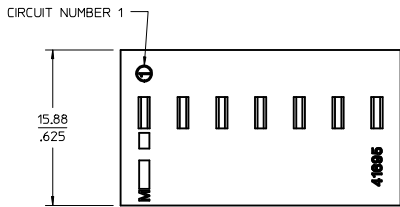

OPTION CODE D

RAMP WITH POLARIZING RIBS

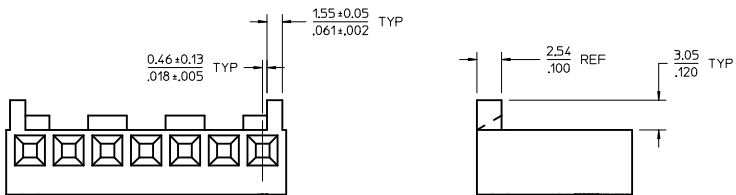

WHEN MATING OPTION CODE D HOUSING WITH BREAKAWAY FRICTION LOCK OR POLARIZING HEADER, THE END FRICTION LOCKS OR POLARIZING WALLS MUST BE REMOVED.

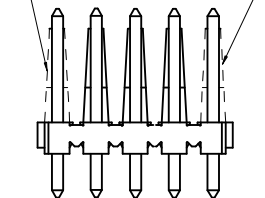

WHEN MATING WITH BREAKAWAY HEADERS THE FRICTION LOCK WALL MUST BE REMOVED

41695 - * - * N - ##

MATERIAL CODE
N = MOLDED NATURAL

VOID CODE
BLANK=NO VOIDS
NO.-NO. CORRESPONDS TO CKT. NO. VOIDED
MULT. VOIDS=START WITH 51

NO. OF CKTS.

OPTION CODE

CODE	RAMP	POLARIZING RIBS	PACKAGING
A	NO	NO	BULK PER PK-41695-001
B	YES	NO	BULK PER PK-41695-001
D	YES	YES	BULK PER PK-41695-001

CORRECT ENGRAVING EIC NO: UCP2015-0430 DRAWN: DFOX 2014/07/30 CHECKED: MKIPPER 2014/07/30 APPROVED: FSMITH 2014/07/31 REV: DESCRIPTION	QUALITY SYMBOLS ∇=0 ∇=0 ∇=0	GENERAL TOLERANCES (UNLESS SPECIFIED) mm INCH 4 PLACES ± --- ± --- 3 PLACES ± --- ± --- 2 PLACES ± 0.13 ± --- 1 PLACE ± 0.25 ± --- 0 PLACE ± --- ± --- ANGULAR ±1/2° DRAFT WHERE APPLICABLE MUST REMAIN WITHIN DIMENSIONS	DIMENSION STYLE MM ONLY DRAWN BY DATE MKIPPER 2012/10/25 CHECKED BY DATE BANDERSON 2012/10/26 APPROVED BY DATE FSMITH 2013/10/04	SCALE 4:1 DESIGN UNITS METRIC THIRD ANGLE PROJECTION	TITLE KK (3.96)/.156 CRIMP TERMINAL HOUSING	MATERIAL NO. SEE CHART DOCUMENT NO. SD-41695	SHEET NO. 1 OF 2
	THIS DRAWING CONTAINS INFORMATION THAT IS PROPRIETARY TO MOLEX INCORPORATED AND SHOULD NOT BE USED WITHOUT WRITTEN PERMISSION						

