

LOCATION DETAIL (SEE NOTE #6)

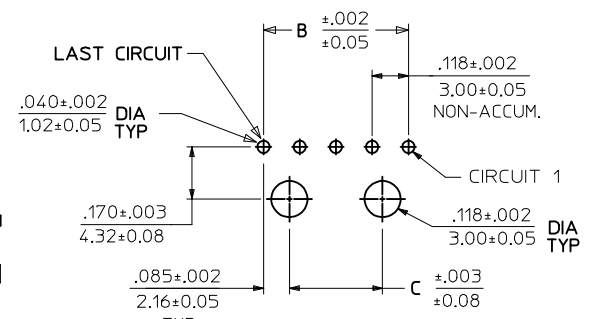

PCB LAYOUT: COMPONENT SIDE  
RECOMMENDED PCB THICKNESS: .062/157  
4-12 CIRCUIT HEADERS

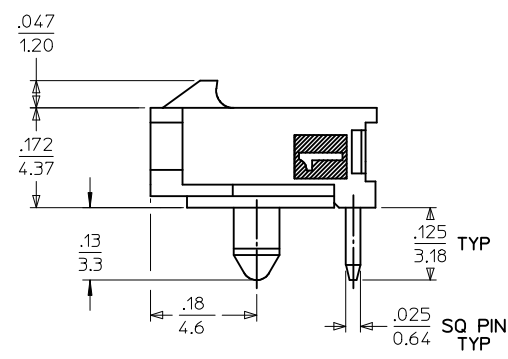
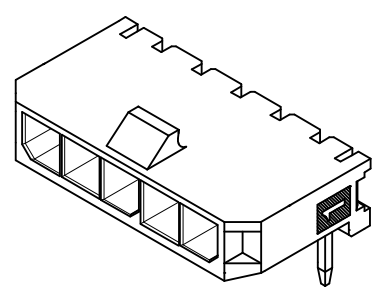
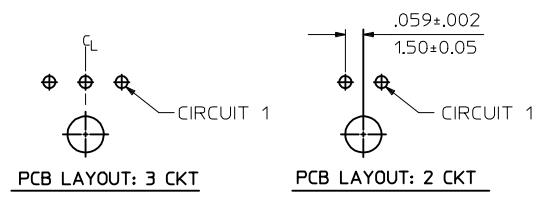

CKTS	A	B	C
2	.380 9.65	.118 3.00	NA
3	.498 12.65	.236 6.00	NA
4	.616 15.65	.354 9.00	.185 4.70
5	.734 18.64	.472 12.00	.303 7.70
6	.852 21.64	.591 15.00	.421 10.70
7	.970 24.64	.709 18.00	.539 13.70
8	1.088 27.64	.827 21.00	.657 16.70
9	1.206 30.63	.945 24.00	.776 19.70
10	1.325 33.66	1.063 27.00	.894 22.70
11	1.443 36.65	1.181 30.00	1.012 25.70
12	1.561 39.65	1.299 33.00	1.130 28.70

CKTS	FINISH A		VOID CKT#
	MATERIAL NO:		
02	43650-0200	N/A	
03	43650-0300	N/A	
04	43650-0400	N/A	
05	43650-0500	N/A	
06	43650-0600	N/A	
07	43650-0700	N/A	
08	43650-0800	N/A	
09	43650-0900	N/A	
10	43650-1000	N/A	
11	43650-1100	N/A	
12	43650-1200	N/A	
03	43650-1300	2	
05			
09	43650-1900	2,4,5	

CKTS	FINISH B		VOID CKT#
	MATERIAL NO:		
	43650-0201	N/A	
	43650-0301	N/A	
	43650-0401	N/A	
	43650-0501	N/A	
	43650-0601	N/A	
	43650-0701	N/A	
	43650-0801	N/A	
	43650-0901	N/A	
	43650-1001	N/A	
	43650-1101	N/A	
	43650-1201	N/A	
	43650-1901	2,4,6,8	

CKTS	FINISH C		VOID CKT#
	MATERIAL NO:		
	43650-0202	N/A	
	43650-0302	N/A	
	43650-0402	N/A	
	43650-0502	N/A	
	43650-0602	N/A	
	43650-0702	N/A	
	43650-0802	N/A	
	43650-0902	N/A	
	43650-1002	N/A	
	43650-1102	N/A	
	43650-1202	N/A	
	43650-1502	2,3,4	

CKTS	FINISH D		VOID CKT#
	MATERIAL NO:		
	43650-0237		

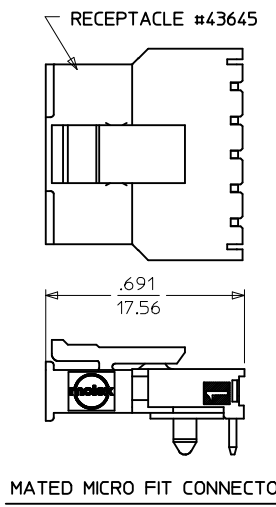

- NOTES:
- HOUSING MATERIAL: LIQUID CRYSTAL POLYMER, GLASS FILLED, UL94V-0, COLOR - BLACK  
TERMINAL MATERIAL: BRASS ALLOY
  - FINISH:
    - A = .000060/(0.00152) MIN. REFLOWED MATTE TIN OVER .000050/(0.00127) MIN. NICKEL (FINISH IS BRIGHT IN APPEARANCE, THICKNESS AS APPLIED PRIOR TO REFLOW)
    - B = .000015/(0.00038) MIN. SELECT GOLD IN CONTACT AREA .000100/(0.00254) MIN. SELECT MATTE TIN ON SOLDER TAILS BOTH OVER .000050/(0.00127) NICKEL OVERALL
    - C = .000030/(0.00076) MIN. SELECT GOLD IN CONTACT AREA .000100/(0.00254) MIN. SELECT MATTE TIN ON SOLDER TAILS BOTH OVER .000050/(0.00127) NICKEL OVERALL
    - D = .000100/(0.00254) MIN. MATTE TIN OVER .000050/(0.00127) MIN. NICKEL
  - PRODUCT SPECIFICATION: PS-43650
  - TRAY PACKAGED : SEE MOLEX DRAWING PK-70873-0321
  - MATES WITH MICRO FIT (3.0) RECEPTACLE SERIES 43645
  - TO AVOID INTERFERENCE BETWEEN RECEPTACLE AND PCB, HEADER MUST BE PLACED WITHIN .400/(10.16) MAX. FROM EDGE OF PCB, AS SHOWN IN LOCATION DETAIL.
  - PARTS CONFORM TO CLASS 'B' REQUIREMENTS OF COSMETIC SPECIFICATION PS-45499-002

REVISE FINISH A  
EC NO: UCP2016-2946  
DRWINBAPPELDORN 2016/01/28  
CHKD:JDOX 2016/01/28  
APPR:FSMITH 2016/03/18  
D6

QUALITY SYMBOLS  
GENERAL TOLERANCES (UNLESS SPECIFIED)  
mm INCH  
4 PLACES ± --- ± ---  
3 PLACES ± --- ± .010  
2 PLACES ± 0.25 ± .014  
1 PLACE ± 0.35 ± ---  
0 PLACE ± --- ± ---  
ANGULAR ±1/2°  
DRAFT WHERE APPLICABLE MUST REMAIN WITHIN DIMENSIONS

DIMENSION STYLE IN/MM  
SCALE ---  
DESIGN UNITS METRIC  
DRAWN BY SAMIEC DATE 2000/07/07  
CHECKED BY MUELLER DATE 2000/07/07  
APPROVED BY FSMITH DATE 2016/03/18  
MATERIAL NO. SEE CHART  
SIZE C

THIRD ANGLE PROJECTION  
MICRO-FIT (3.0)  
SINGLE ROW / RIGHT ANGLE THRU HOLE / PEGS / TRAY  
**molex**  
DOCUMENT NO. SD-43650-001  
SHEET NO. 1 OF 1  
THIS DRAWING CONTAINS INFORMATION THAT IS PROPRIETARY TO MOLEX INCORPORATED AND SHOULD NOT BE USED WITHOUT WRITTEN PERMISSION