

基板取付穴推奨寸法  
RECOMMENDED P.C.BOARD HOLE DIM.

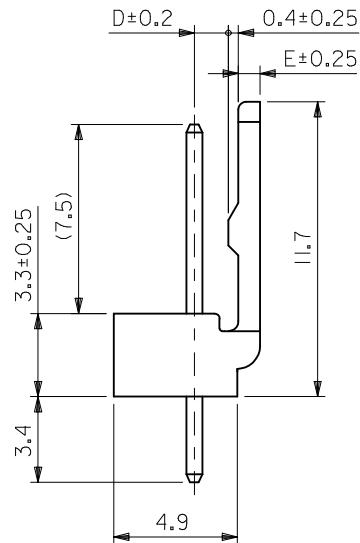
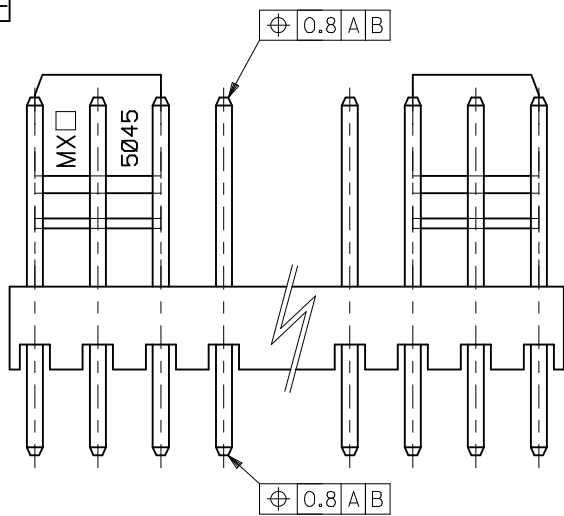

注)  
NOTE.

1. 材料

MATERIAL

ピン : φ0.635×14.2 黄銅、銅下地錫メッキ  
PIN: 0.635×14.2 BRASS TIN OVER COPPER PLATING.  
ウエハー: ポリアミド, UL94V-0  
WAFER: POLYAMIDE, UL94V-0

2. 6極以上に適用

TO BE APPLIED FOR 6 CKT. AND MORE THEN 6 CKT.

3. 5極以下はロック部スリットなし

NO SLIT IS PROVIDED FOR 5 CKT. AND LESS THAN 5 CKT.

4. ELV 及び RoHS 適合品

ELV AND RoHS COMPLIANT

|      |      |  |      |            |    |
|------|------|--|------|------------|----|
| 1.35 | 0.85 | 47.5 <sup>+0.3</sup> <sub>-0.45</sub>  | 47.5 | 22 04 1201 | 20 |
| ↑    | ↑    | 45 <sup>+0.3</sup> <sub>-0.45</sub>    | 45   | 1191       | 19 |
|      |      | 42.5 <sup>+0.3</sup> <sub>-0.45</sub>  | 42.5 | 1181       | 18 |
|      |      | 40 <sup>+0.3</sup> <sub>-0.45</sub>    | 40   | 1171       | 17 |
|      |      | 37.5 <sup>+0.3</sup> <sub>-0.45</sub>  | 37.5 | 1161       | 16 |
|      |      | 35 <sup>+0.3</sup> <sub>-0.45</sub>    | 35   | 1151       | 15 |
|      |      | 32.5 <sup>+0.25</sup> <sub>-0.4</sub>  | 32.5 | 1141       | 14 |
|      |      | 30 <sup>+0.25</sup> <sub>-0.4</sub>    | 30   | 1131       | 13 |
|      |      | 27.5 <sup>+0.25</sup> <sub>-0.4</sub>  | 27.5 | 1121       | 12 |
|      |      | 25 <sup>+0.2</sup> <sub>-0.4</sub>     | 25   | 1111       | 11 |
|      |      | 22.5 <sup>+0.2</sup> <sub>-0.4</sub>   | 22.5 | 1101       | 10 |
|      |      | 20 <sup>+0.15</sup> <sub>-0.35</sub>   | 20   | 1091       | 9  |
|      |      | 17.5 <sup>+0.15</sup> <sub>-0.35</sub> | 17.5 | 1081       | 8  |
|      |      | 15 <sup>+0.1</sup> <sub>-0.3</sub>     | 15   | 1071       | 7  |
|      |      | 12.5 <sup>+0.1</sup> <sub>-0.3</sub>   | 12.5 | 1061       | 6  |
|      |      | 10 <sup>+0.1</sup> <sub>-0.3</sub>     | 10   | 1051       | 5  |
| 1.35 | 0.85 | 7.5 <sup>+0.5</sup> <sub>-0.3</sub>    | 7.5  | 1041       | 4  |
| 1.2  | 1    | 5 <sup>+0.5</sup> <sub>-0.3</sub>      | 5    | 1031       | 3  |
| 1.2  | 1    | 2.5 <sup>+0.5</sup> <sub>-0.3</sub>    | 2.5  | 22 04 1021 | 2  |
| D    | E    | C                                      | B    | ORDER No.  | 極数 |

MODEL No. : 5045-\*\*\*A

|   |                                       |  |                            |   |                                       |                        |
|---|---------------------------------------|--|----------------------------|---|---------------------------------------|------------------------|
| REVISED<br>EC NO.: J2012-0973<br>DRWN: KWASHIO 2012/01/30<br>CHKD: KASAKAWA 2012/01/30<br>APPR: NUKITA 2013/06/13 | GENERAL TOLERANCES (UNLESS SPECIFIED) |  | DIMENSION STYLE<br>MM ONLY | SCALE<br>5:1  | DESIGN UNITS<br>METRIC                | THIRD ANGLE PROJECTION |
|   | 10 UNDER                              | ±0.4   | DRAWN BY<br>K. KOHAMA      | DATE<br>2000/03/28  | TITLE<br>KK 2.5 WAFER ASS'Y WITH LOCK |                        |
|   | 10 OVER 30 UNDER                      | ±0.45  | CHECKED BY<br>T. YAMAGUCHI | DATE<br>2000/03/30  |                                       |                        |
|   | 30 OVER                               | ±0.5   | APPROVED BY                | DATE  |                                       |                        |
|   | ANGULAR ±3 °                          | DRAFT WHERE APPLICABLE MUST REMAIN WITHIN DIMENSIONS | MATERIAL NO.<br>SEE CHART  | THIS DRAWING CONTAINS INFORMATION THAT IS PROPRIETARY TO MOLEX INCORPORATED AND SHOULD NOT BE USED WITHOUT WRITTEN PERMISSION |                                       |                        |