

基板取付穴推奨寸法
RECOMMENDED P.C.BOARD HOLE DIM.

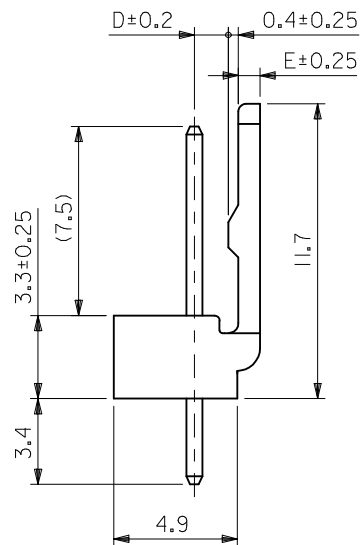
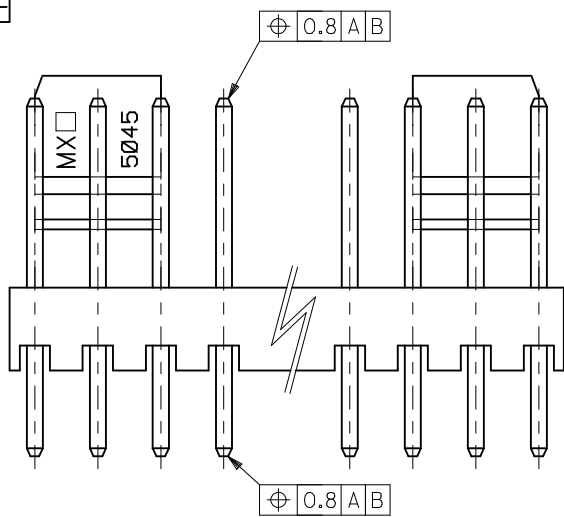

注)
NOTE.

1. 材料

MATERIAL

ピン : φ0.635×14.2 黄銅、銅下地錫メッキ

PIN: 0.635×14.2 BRASS TIN OVER COPPER PLATING.

ウエハー: ポリアミド, UL94V-0

WAFER: POLYAMIDE, UL94V-0

2. 6極以上に適用

TO BE APPLIED FOR 6 CKT. AND MORE THEN 6 CKT.

3. 5極以下はロック部スリットなし

NO SLIT IS PROVIDED FOR 5 CKT. AND LESS THAN 5 CKT.

4. ELV 及び RoHS 適合品

ELV AND RoHS COMPLIANT

1.35	0.85	47.5 ^{+0.3} _{-0.45}	47.5	22 04 1201	20
↑	↑	45 ^{+0.3} _{-0.45}	45	1191	19
		42.5 ^{+0.3} _{-0.45}	42.5	1181	18
		40 ^{+0.3} _{-0.45}	40	1171	17
		37.5 ^{+0.3} _{-0.45}	37.5	1161	16
		35 ^{+0.3} _{-0.45}	35	1151	15
		32.5 ^{+0.25} _{-0.4}	32.5	1141	14
		30 ^{+0.25} _{-0.4}	30	1131	13
		27.5 ^{+0.25} _{-0.4}	27.5	1121	12
		25 ^{+0.2} _{-0.4}	25	1111	11
		22.5 ^{+0.2} _{-0.4}	22.5	1101	10
		20 ^{+0.15} _{-0.35}	20	1091	9
		17.5 ^{+0.15} _{-0.35}	17.5	1081	8
		15 ^{+0.1} _{-0.3}	15	1071	7
		12.5 ^{+0.1} _{-0.3}	12.5	1061	6
		10 ^{+0.15} _{-0.3}	10	1051	5
1.35	0.85	7.5 ^{+0.15} _{-0.3}	7.5	1041	4
1.2	1	5 ^{+0.15} _{-0.3}	5	1031	3
1.2	1	2.5 ^{+0.15} _{-0.3}	2.5	22 04 1021	2
D	E	C	B	ORDER No.	極数

MODEL No. : 5045-***A

REVISED EC NO.: J2012-0973 DRWN: KWASHIO 2012/01/30 CHKD: KASAKAWA 2012/01/30 APPR: NUKITA 2013/06/13	GENERAL TOLERANCES (UNLESS SPECIFIED)		DIMENSION STYLE MM ONLY	SCALE 5:1	DESIGN UNITS METRIC	THIRD ANGLE PROJECTION
	10 UNDER	±0.4	DRAWN BY K. KOHAMA	DATE 2000/03/28	TITLE KK 2.5 WAFER ASS'Y WITH LOCK	
	10 OVER 30 UNDER	±0.45	CHECKED BY T. YAMAGUCHI	DATE 2000/03/30		
	30 OVER	±0.5	APPROVED BY	DATE		
	ANGULAR ±3 °	DRAFT WHERE APPLICABLE MUST REMAIN WITHIN DIMENSIONS	MATERIAL NO. SEE CHART	THIS DRAWING CONTAINS INFORMATION THAT IS PROPRIETARY TO MOLEX INCORPORATED AND SHOULD NOT BE USED WITHOUT WRITTEN PERMISSION		