

基板取付穴推奨寸法

(基板厚: t=1~1.6mm)
 RECOMMENDED PC BOARD
 HOLE DIMENSION
 (THICKNESS: t=1~1.6mm)

注記
 NOTE

- △ 適合ターミナル: 50034 8*00
 APPLICABLE TERMINAL: 50034 8*00
- 2. 材料 ハウジング: ポリアミド, UL94V-0
 色: ナチュラル(白)
 MATERIAL HOUSING: POLYAMIDE, UL94V-0
 COLOR: NATURAL(WHITE)
- 3. ELV 及び RoHS 適合品
 ELV AND RoHS COMPLIANT.

28	30.4	51015	1500	15
26	28.4	↑	1400	14
24	26.4		1300	13
22	24.4		1200	12
20	22.4		1100	11
18	20.4		1000	10
16	18.4		0900	9
14	16.4		0800	8
12	14.4		0700	7
10	12.4		0600	6
8	10.4		0500	5
6	8.4		0400	4
4	6.4		0300	3
2	4.4		0200	2
B	A	ORDER No.		極致 NO. OF CKT

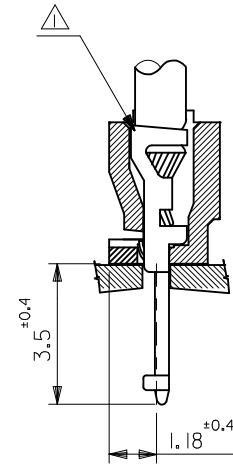

REVISED EC NO: J2012-0968 DRWN: KWASHIO 2012/01/18 CHKD: KASAKAWA 2013/04/09 APPR: Y0110 2013/04/10	GENERAL TOLERANCES (UNLESS SPECIFIED)		DIMENSION STYLE MM ONLY		SCALE 8:1	DESIGN UNITS METRIC	THIRD ANGLE PROJECTION
	10 UNDER	±0.2	DRAWN BY HIJIMA	DATE 1996/05/28	TITLE 2.0 BOARD IN CONN HSG		
	10 OVER 30 UNDER	±0.25	CHECKED BY MFUKUSHIMA	DATE 1996/05/28	MATERIAL NO. SEE CHART		
	30 OVER	±0.3	APPROVED BY	DATE	DOCUMENT NO. SD-51015-**-00		
	ANGULAR ±3 °	DRAFT WHERE APPLICABLE MUST REMAIN WITHIN DIMENSIONS		SIZE A3	THIS DRAWING CONTAINS INFORMATION THAT IS PROPRIETARY TO MOLEX INCORPORATED AND SHOULD NOT BE USED WITHOUT WRITTEN PERMISSION		