

NOTES :

1- MATERIAL:

-HOUSING: POLYESTER FIBER GLASS FILLED UL 94-V0
COLOR BLACK.

-TERMINAL: PHOSPHOR BRONZE.

PLATING :

POST PLATE 0.00127-0.00152/.000050-.000060 GOLD IN
CONTACT AREA , 0.00190/.000075 MIN PURE TIN
IN TAIL AREA BOTH OVER 0.00127/.000050 MIN NICKEL
OVERALL.

- 2- JACK FOR MATING WITH F.C.C. 68 PLUGS (90075 MOLEX SERIES).
- 3- PRODUCT SPECIFICATION PS-95003 AND PS-85505 (SECTION 5.2).
- 4- APPLICATION SPECIFICATION AS-95001.
- 5- PACKAGING SPECIFICATION PK-95003 SHEET 1:
(TRAY PACKAGING).
- 6- EXCEEDS CATEGORY 5E PERFORMANCE.

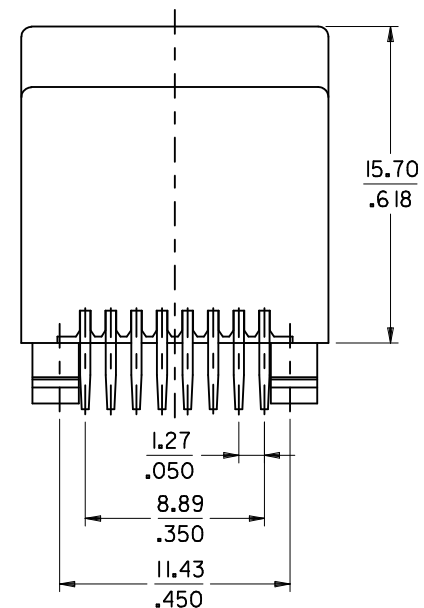
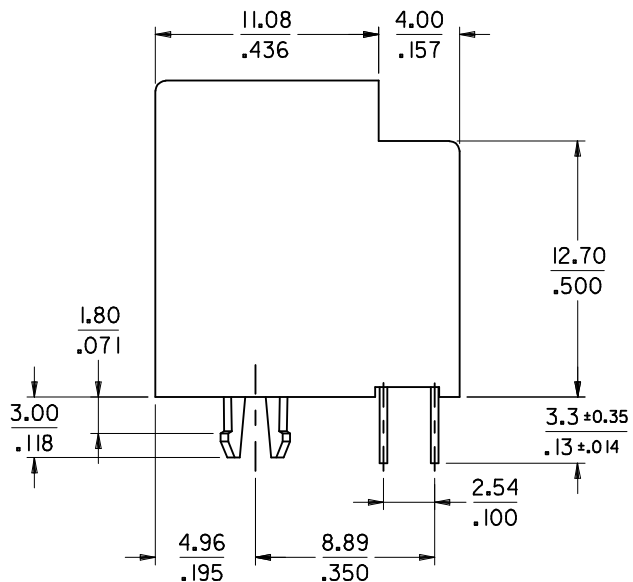
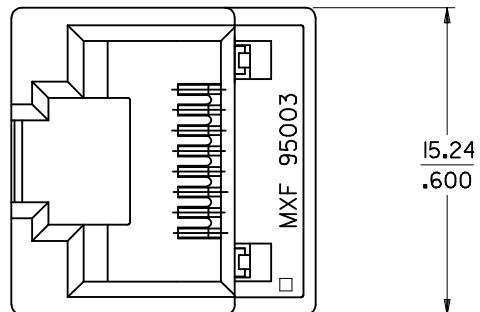

P.C.B. MOUNTING PATTERN
(see from component side)

SCALE 2:1

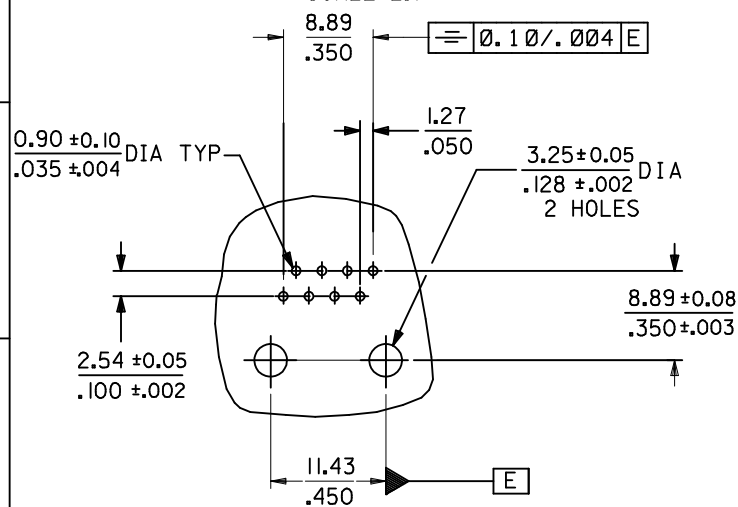

ENTER DESCRIPTION EC NO: MGZ005-0151 DRWN: CSEBASTI 2004/10/25 CHKD: FCARBET 2004/10/25 APPR: KNOLLER 2004/11/09	QUALITY SYMBOLS ▽=0 ∇=0	GENERAL TOLERANCES (UNLESS SPECIFIED)		DIMENSION STYLE MM/IN		SCALE 4:1	DESIGN UNITS METRIC	THIRD ANGLE PROJECTION	
		mm	INCH	DRAWN BY HB	DATE 99/08/18	TITLE HIGH SPEED MODULAR JACK TOP ENTRY LOW PROFILE THROUGH HOLE 8 CKTS			
REV B	DESCRIPTION	4 PLACES	± ---	± ---	CHECKED BY ER	DATE 99/08/18	MOLEX INCORPORATED		
		3 PLACES	± ---	± .006	APPROVED BY FB	DATE 99/08/18			
		2 PLACES	± 0.15	± .010	MATERIAL NO. 85511-0001		DOCUMENT NO. SD-85511-001		SHEET NO. 1 OF 1
		1 PLACE	± 0.25	± ---	THIS DRAWING CONTAINS INFORMATION THAT IS PROPRIETARY TO MOLEX INCORPORATED AND SHOULD NOT BE USED WITHOUT WRITTEN PERMISSION				
		ANGULAR ± 1/2°		DRAFT WHERE APPLICABLE MUST REMAIN WITHIN DIMENSIONS					